



Current Promotion

Scan  
these  
QR Codes



Featured Video

**LYNDEX-NIKKEN**

**OTHER**

Ground surface allows perpendicular contact of retention stud, ensuring better alignment

AT3 or better taper contact: .0028 degree tolerance variation 80 millionths to 126 millionths. Traverse ground taper ensures 80% or better taper contact

Drive keys milled to same depth for symmetrical body design, resulting in better high speed balance

Body of Collet Chuck equal in diameter to the nut diameter. Thicker diameter and wall thickness results in stronger rigidity

Reduced gap size to prevent birds nests and other stringy chips from packing in or wrapping about

**ER Nut**  
Smooth nut prevents coolant flare and provides better balance

**Nickel Chrome Molybdenum Alloy**

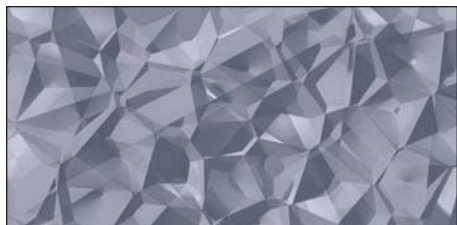

Lyndex-Nikken toolholders are heat treated "in house" to a hardness between 55 to 58 Rc under the highest quality standard, ensuring a homogeneous martensite (needle-shaped) crystalline structure. The additional heat treatment process allows for a better ground surface finish and stress stability of the toolholder.

Turned rough surface causes the retention stud centerline to deviate

AT4 or better taper contact: .0028 degree tolerance variation 80 millionths to 126 millionths. Plunge ground taper creates inconsistency, ensuring only 60% or better taper contact

Drive keys milled to different depths, per standard of 70 years ago

Recessed collet chuck body diameter weakens rigidity of holder

Large hex nut body design flares coolant away from toolholder

**High Carbon Steel**

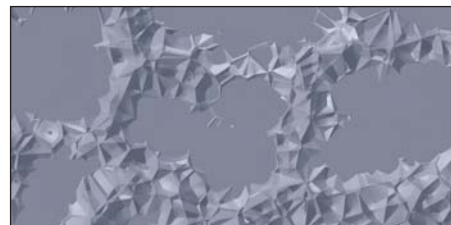

Other toolholders are commonly not heat treated thoroughly to reduce costs, resulting in austenite deposits. Surface finish and material integrity are compromised commonly masked by chrome plating or polishing.

## ER Collet Features

We offer the largest ER Collet product range in the industry.

**Quality Standard-** Made to DIN 6499 Specification

**Material-** High Tensile Chromium Molybdenum Alloy provides greater hardness and less material deformation compared to traditional spring steel collets

**Tolerance-** Guaranteed to be within .0001" or better run out at the collet nose

**Accuracy-** Less than .0004" at 4 X Dia.

**Inspection-** 100% collet inspection, checked 3 times for concentricity

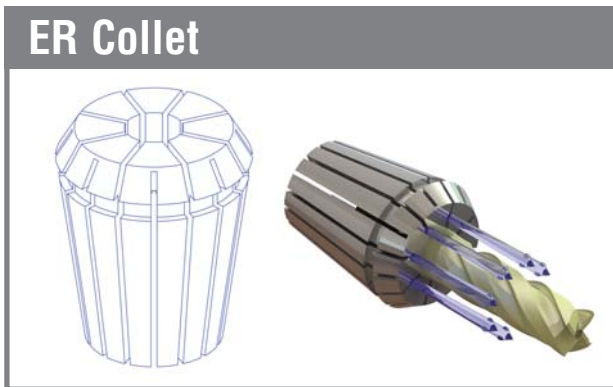

### ER Standard Type Collet

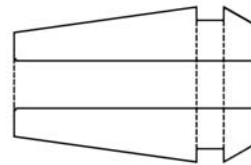

**Flexibility and Durability:**

We offer the ultimate trifecta: wide clamping range, ultra precision, and super high pressure. Our 1300 PSI capable collets have a wide .031" collapse range and the ability to maintain less than .0001 run out at the collet nose.

### ER Counter-Bored Type Collet

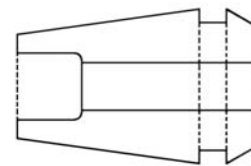

**Ultra Precision for MicroCutters:**

Our High Precision "On Size" Collets have 25% longer collet bore lengths than competitors, resulting in stronger gripping power at higher RPM's. The High Pressure Coolant Collet's special design reduces cutter vibration due to high pressure.

### High Precision ER Tap Collet

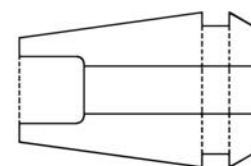

**Extreme rigidity, high pressure performance:**

Our Tap Collets are designed for all ANSI, DIN, ISO, JIS Specification Taps. 1300 PSI capable Coolant Tap Collets increase tool life by dissipating heat and preventing chip build-up.

### Dimensional Data

Style	D	D1	L	Collet Range	Coolant Collet Size Range
ER16	17.2mm	11.3mm	27.0mm	0.5 - 10.0mm	4.0 - 10.0mm (3/16" - 17/64")
ER20	21.2mm	14.5mm	31.0mm	1.0 - 13.0mm	5.0 - 13.0mm (5/32" - 1/2")
ER25	26.2mm	18.5mm	35.0mm	1.0 - 16.0mm	6.0 - 16.0mm (7/32" - 5/8")
ER32	33.2mm	24.4mm	40.0mm	2.0 - 20.0mm	10.0 - 20.0mm (1/4" - 25/32")
ER40	41.2mm	31.2mm	46.0mm	3.0mm - 26.0mm	10.0 - 26.0mm

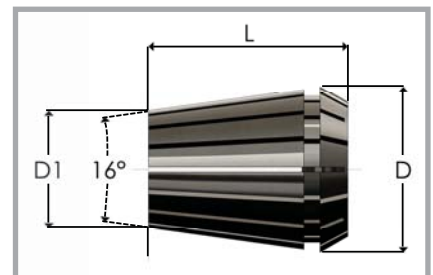

**LYNDEX-NIKKEN NUT**

**OTHER NUT**

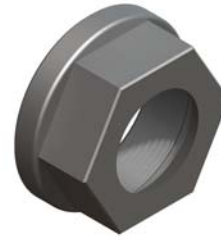
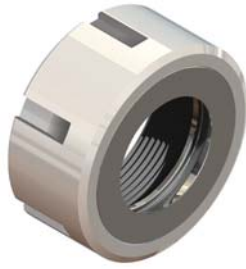

**Bearing Nut**

**Standard Nut - No Bearing**



- Bearing nuts come as a standard on all of our ER Collet Chucks:
- Reduce twisting of the collet and increase the TIR accuracy
  - Improve chucking consistency by 6 times compared to non bearing style nut!

Non bearing style nuts only provide the ability to retain the collet, and do not carry a functional advantage to improve the TIR or chucking consistency.

**Maximum Accuracy**

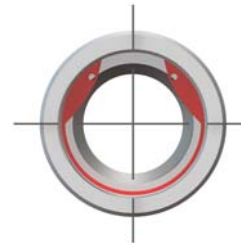
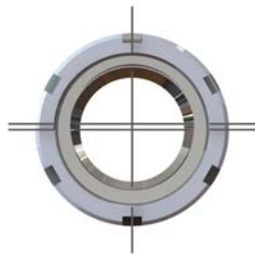

We control all of our manufacturing processes, thereby maintaining the accuracy assembly tolerances between the nut, collet and holder.

Our ground eccentric bearing race makes set up extremely easy, and ensures the accurate concentric placement of the collet.

Other manufacturers use a commercial snap ring as a retainer for the collet. This can contribute to minor misalignment between the nut, collet and holder.

**Ground Eccentric Nut**

**No Ground Surface**

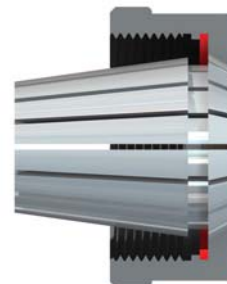
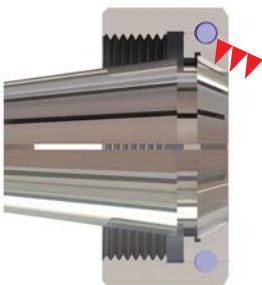

Our ground eccentric bearing race increases clamping power by 40% compared to standard nuts!





It also prevents galling and twisting between the collet angle contact surface and the nut to minimize runout, and greatly assist in alignment of the collet to the holder.

ER Collet without ground contact locations cannot ensure ultra precision due to surface abnormality.

# CAT ER Collet Chucks



- Ball bearing nut with ground collet race
- Ground surface for perpendicular contact between retention knob and holder
- AT3 or better taper
- Equipped with a left-hand-threaded stop screw
- Available in high-speed balanceable versions

Please note that the maximum RPM listed in our catalog may vary depending on the toolholder shank, weight, balanceability and the G rating.

-  **TIR:** < .0001 at collet face
-  **Speed:** up to 23,000 rpm
-  **Set-up:** quick and easy
-  **Coolant-thru:** thru-tool coolant

-  **Drilling**  
★★★★☆
-  **Milling**  
★★★★☆
-  **Reaming**  
★★★★☆
-  **Tapping**  
★★★☆☆

## CAT40

Part Number	Style	Collet Size 	Collet Range	Nut Wrench 	L	L1	D
C4007-0008-2.50	Standard	ER8	.019-.196"	08-NASPAN	2.50"	0.51"	0.47"
C4017-0008-4.00	Standard	ER8	.019-.196"	08-NASPAN	4.00"	0.51"	0.47"
C4047-0008-9.00	<b>Ext. Length</b>	ER8	.019-.196"	08-NASPAN	9.00"	0.51"	0.47"
C4007-0011-2.50	Standard	ER11	.019-.275"	011-HEX	2.50"	0.65"	0.75"
C4017-0011-4.00	Standard	ER11	.019-.275"	011-HEX	4.00"	0.65"	0.75"
C4027-0011-6.00	Standard	ER11	.019-.275"	011-HEX	6.00"	0.65"	0.75"
C40S7-0016-2.25	<b>Stubby</b>	ER16	.019-.406"	016-SPAN	2.25"	0.87"	1.26"
C4007-0016-3.50	Standard	ER16	.019-.406"	016-SPAN	3.50"	0.87"	1.26"
C4017-0016-6.00	Standard	ER16	.019-.406"	016-SPAN	6.00"	0.87"	1.26"
C4047-0016-9.00	<b>Ext. Length</b>	ER16	.019-.406"	016-SPAN	9.00"	0.87"	1.26"
C4007-0020-2.50	Standard	ER20	.039-.511"	020-SPAN	2.50"	1.06"	1.38"
C4017-0020-4.00	Standard	ER20	.039-.511"	020-SPAN	4.00"	1.06"	1.38"
C4027-0020-6.00	Standard	ER20	.039-.511"	020-SPAN	6.00"	1.06"	1.38"
C4047-0020-9.00	<b>Ext. Length</b>	ER20	.039-.511"	020-SPAN	9.00"	1.06"	1.38"
C4007-0025-2.50	Standard	ER25	.039-.629"	025-SPAN	2.50"	1.18"	1.65"
C4017-0025-4.00	Standard	ER25	.039-.629"	025-SPAN	4.00"	1.18"	1.65"
C4027-0025-6.00	Standard	ER25	.039-.629"	025-SPAN	6.00"	1.18"	1.65"
C40S7-0032-1.10	<b>Stubby</b>	ER32	.078-.787"	025-SPAN	2.25"	0.87"	1.26"
C4007-0032-3.13	Standard	ER32	.078-.787"	032-SPAN	3.13"	1.34"	1.97"
C4017-0032-5.00	Standard	ER32	.078-.787"	032-SPAN	5.00"	1.34"	1.97"
C4047-0032-9.00	<b>Ext. Length</b>	ER32	.078-.787"	032-SPAN	9.00"	1.34"	1.97"
C4007-0040-3.13	Standard	ER40	.118-1.023"	040-SPAN	3.13"	1.50"	2.48"
C4017-0040-5.00	Standard	ER40	.118-1.023"	040-SPAN	5.00"	1.50"	2.48"

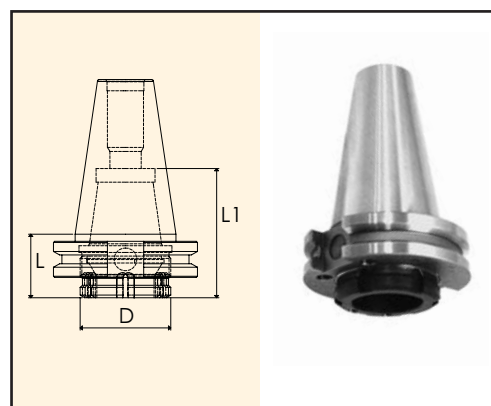

Stubby

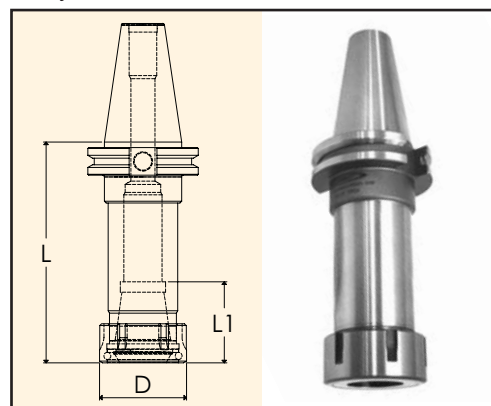

Standard

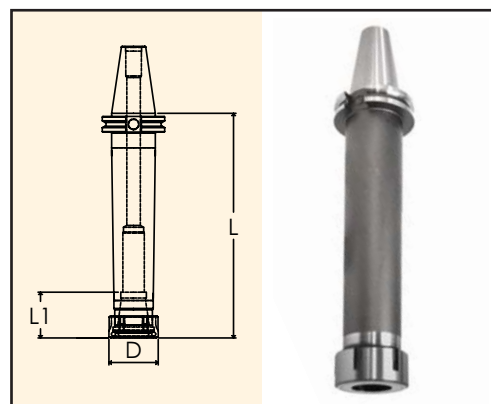

Extended length

Note: ER Collets Chucks come with back-up screw.



When removing the back-up screw, ER Collet Chucks have coolant-thru capabilities. No disc, special nut or wrench required!  
See ER Coolant Collets on pages 46 - 51.

### Accessories:



ER Collets  
Pages 46-53



ER Torque Wrench  
Page 55





ER Back Up Screw  
Page 55



ER Nut  
Page 54

# CAT ER Collet Chucks

## CAT50

Part Number	Style	Collet Size 	Collet Range	Nut Wrench 	L	L1	D
C5007-0016-4.12	Standard	ER16	.019-.406"	016-SPAN	4.12"	0.87"	1.26"
C5017-0016-6.00	Standard	ER16	.019-.406"	016-SPAN	6.00"	0.87"	1.26"
C5027-0016-8.00	Standard	ER16	.019-.406"	016-SPAN	8.00"	0.87"	1.26"
C5057-0016-12.00	<b>Ext. Length</b>	ER16	.019-.406"	016-SPAN	12.00"	0.87"	1.26"
C5007-0020-2.50	Standard	ER20	.039-.511"	020-SPAN	2.50"	1.06"	1.38"
C5017-0020-4.00	Standard	ER20	.039-.511"	020-SPAN	4.00"	1.06"	1.38"
C5027-0020-6.00	Standard	ER20	.039-.511"	020-SPAN	6.00"	1.06"	1.38"
C5037-0020-8.00	Standard	ER20	.039-.511"	020-SPAN	8.00"	1.06"	1.38"
C5057-0020-12.00	<b>Ext. Length</b>	ER20	.039-.511"	020-SPAN	12.00"	1.06"	1.38"
C5007-0025-2.50	Standard	ER25	.039-.629"	025-SPAN	2.50"	1.18"	1.65"
C5017-0025-4.00	Standard	ER25	.039-.629"	025-SPAN	4.00"	1.18"	1.65"
C5027-0025-6.00	Standard	ER25	.039-.629"	025-SPAN	6.00"	1.18"	1.65"
C5037-0025-8.00	Standard	ER25	.039-.629"	025-SPAN	8.00"	1.18"	1.65"
C5007-0032-4.00	Standard	ER32	.078-.787"	032-SPAN	4.00"	1.34"	1.97"
C5017-0032-6.00	Standard	ER32	.078-.787"	032-SPAN	6.00"	1.34"	1.97"
C5027-0032-8.00	Standard	ER32	.078-.787"	032-SPAN	8.00"	1.34"	1.97"
C5057-0032-12.00	<b>Ext. Length</b>	ER32	.078-.787"	032-SPAN	12.00"	1.34"	1.97"
C50S7-0040-1.10	<b>Stubby</b>	ER40	.118-1.023"	040-SPAN	1.10"	1.10"	1.96"
C5007-0040-4.00	Standard	ER40	.118-1.023"	040-SPAN	4.00"	1.50"	2.48"
C5017-0040-6.00	Standard	ER40	.118-1.023"	040-SPAN	6.00"	1.50"	2.48"
C5027-0040-8.00	Standard	ER40	.118-1.023"	040-SPAN	8.00"	1.50"	2.48"
C5057-0040-12.00	<b>Ext. Length</b>	ER40	.118-1.023"	040-SPAN	12.00"	1.50"	2.48"

Note: ER Collets Chucks come with back-up screw.

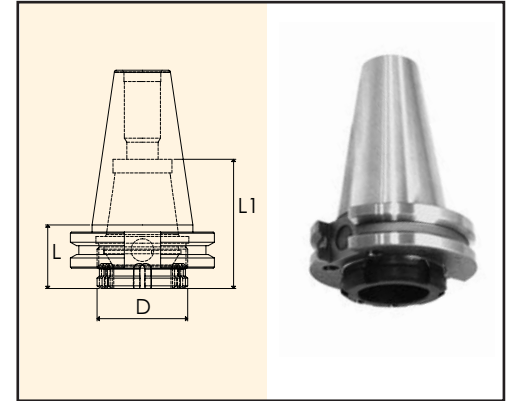

Stubby

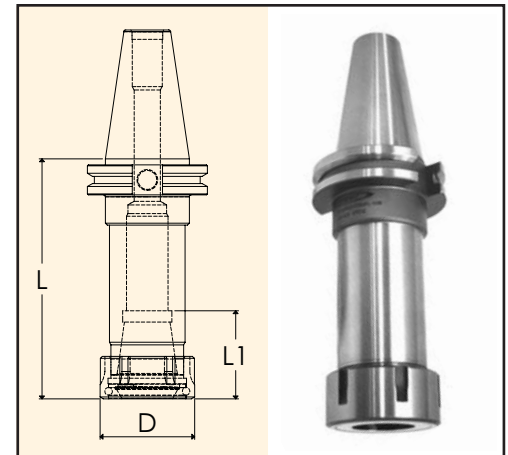

Standard

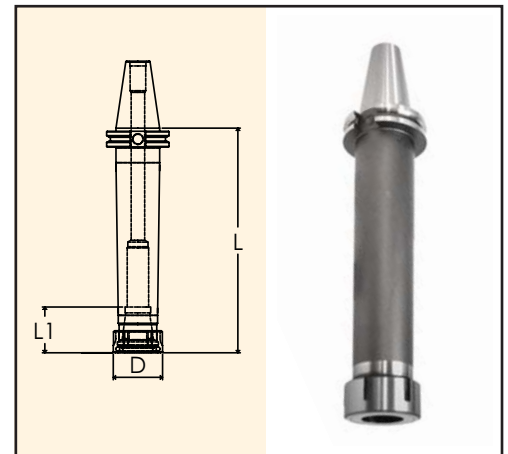

Extended length



When removing the back-up screw, ER Collet Chucks have coolant-thru capabilities. No disc, special nut or wrench required!  
See ER Coolant Collets on pages 46 - 51.

**Accessories:**



**ER Collets**  
Pages 46-53



**ER Torque Wrench**  
Page 55





**ER Back Up Screw**  
Page 55



**ER Nut**  
Page 54

# CAT ER Collet Chucks - DIN

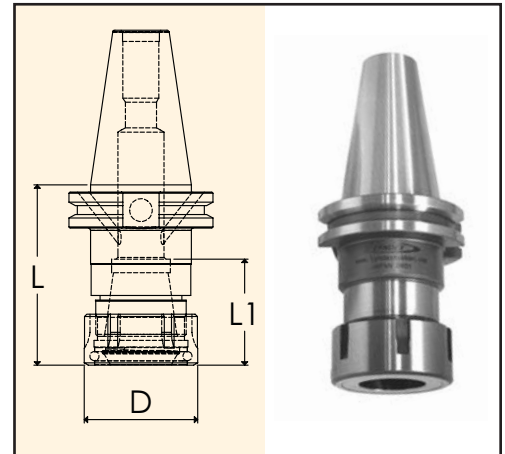

## CAT40 - DIN

Part Number	Style	Collet Size 	Collet Range	Nut Wrench 	L	L1	D
C4007-0016-3.50DIN	Standard	ER16	.019-.406"	016-SPAN	3.50"	0.87"	1.26"
C4017-0016-6.00DIN	Standard	ER16	.019-.406"	016-SPAN	6.00"	0.87"	1.26"
C4007-0020-2.50DIN	Standard	ER20	.039-.511"	020-SPAN	2.50"	1.18"	1.38"
C4017-0020-4.00DIN	Standard	ER20	.039-.511"	020-SPAN	4.00"	1.18"	1.38"
C4007-0025-2.50DIN	Standard	ER25	.039-.629"	025-SPAN	2.50"	1.18"	1.65"
C4017-0025-4.00DIN	Standard	ER25	.039-.629"	025-SPAN	4.00"	1.18"	1.65"
C4007-0032-3.13DIN	Standard	ER32	.078-.787"	032-SPAN	3.13"	1.89"	1.97"
C4017-0032-5.00DIN	Standard	ER32	.078-.787"	032-SPAN	5.00"	1.89"	1.97"
C4007-0040-3.13DIN	Standard	ER40	.118-1.023"	040-SPAN	3.13"	2.05"	2.48"
C4017-0040-5.00DIN	Standard	ER40	.118-1.023"	040-SPAN	5.00"	2.05"	2.48"



Standard

## CAT50 - DIN

Part Number	Style	Collet Size 	Collet Range	Nut Wrench 	L	L1	D
C5007-0016-4.13DIN	Standard	ER16	.019-.406"	016-SPAN	4.13"	0.87"	1.26"
C5017-0016-6.00DIN	Standard	ER16	.019-.406"	016-SPAN	6.00"	0.87"	1.26"
C5027-0016-8.00DIN	Standard	ER16	.019-.406"	016-SPAN	8.00"	0.87"	1.26"
C5007-0020-2.50DIN	Standard	ER20	.039-.511"	020-SPAN	2.50"	1.06"	1.38"
C5017-0020-4.00DIN	Standard	ER20	.039-.511"	020-SPAN	4.00"	1.06"	1.38"
C5027-0020-6.00DIN	Standard	ER20	.039-.511"	020-SPAN	6.00"	1.06"	1.38"
C5007-0025-2.50DIN	Standard	ER25	.039-.629"	025-SPAN	2.50"	1.18"	1.65"
C5017-0025-4.00DIN	Standard	ER25	.039-.629"	025-SPAN	4.00"	1.18"	1.65"
C5027-0025-6.00DIN	Standard	ER25	.039-.629"	025-SPAN	6.00"	1.18"	1.65"
C5007-0032-4.00DIN	Standard	ER32	.078-.787"	032-SPAN	4.00"	2.09"	1.97"
C5017-0032-6.00DIN	Standard	ER32	.078-.787"	032-SPAN	6.00"	2.09"	1.97"
C5027-0032-8.00DIN	Standard	ER32	.078-.787"	032-SPAN	8.00"	2.09"	1.97"
C5007-0040-4.00DIN	Standard	ER40	.118-1.023"	040-SPAN	4.00"	2.13"	2.48"
C5017-0040-6.00DIN	Standard	ER40	.118-1.023"	040-SPAN	6.00"	2.13"	2.48"
C5027-0040-8.00DIN	Standard	ER40	.118-1.023"	040-SPAN	8.00"	2.13"	2.48"

Note: ER Collets Chucks come with back-up screw.  
DIN designates suitability for coolant-through the flange per DIN 69871 form B specs.



When removing the back-up screw, ER Collet Chucks have coolant-thru capabilities. No disc, special nut or wrench required!  
See ER Coolant Collets on pages 46 - 51.

### Accessories:



ER Collets  
Pages 46-53



ER Torque Wrench  
Page 55



ER Back Up Screw  
Page 55



ER Nut  
Page 54

# BT ER Collet Chucks

- Ball bearing nut with ground collet race
- Ground surface for perpendicular contact between retention knob and holder
- AT3 or better taper
- Equipped with a left-hand-threaded stop screw
- Available in high-speed balanceable versions

Please note that the maximum RPM listed in our catalog may vary depending on the toolholder shank, weight, balanceability and the G rating.

- TIR:** < .0001 at collet face
- Speed:** up to 23,000 rpm
- Set-up:** quick and easy
- Coolant-thru:** thru-tool coolant

- Drilling**  
★★★★☆
- Milling**  
★★★★☆
- Reaming**  
★★★★☆
- Tapping**  
★★★★☆

## BT30

Part Number	Style	Collet Size	Collet Range	Nut Wrench	L	L1	D
B3007-0008-2.00	Standard	ER8	.019-.196"	08-NASPAN	2.00"	0.51"	0.47"
B3017-0008-4.00	Standard	ER8	.019-.196"	08-NASPAN	4.00"	0.51"	0.47"
B3007-0011-2.00	Standard	ER11	.019-.275"	011-HEX	2.00"	0.65"	0.75"
B3017-0011-4.00	Standard	ER11	.019-.275"	011-HEX	4.00"	0.65"	0.75"
B3007-0016-2.36	Standard	ER16	.019-.406"	016-SPAN	2.36"	0.87"	1.26"
B3017-0016-4.00	Standard	ER16	.019-.406"	016-SPAN	4.00"	0.87"	1.26"
B3027-0016-5.00	Standard	ER16	.019-.406"	016-SPAN	5.00"	0.87"	1.26"
B3037-0016-6.00	Standard	ER16	.019-.406"	016-SPAN	6.00"	0.87"	1.26"
B30S7-0020-1.20	<b>Stubby</b>	ER20	.039-.511"	020-SPAN	1.22"	1.57"	1.10"
B3007-0020-2.50	Standard	ER20	.039-.511"	020-SPAN	2.50"	1.06"	1.38"
B3017-0020-4.00	Standard	ER20	.039-.511"	020-SPAN	4.00"	1.06"	1.38"
B3007-0025-2.00	Standard	ER25	.039-.629"	025-SPAN	2.00"	1.18"	1.65"
B3017-0025-4.00	Standard	ER25	.039-.629"	025-SPAN	4.00"	1.18"	1.65"
B3007-0032-3.00	Standard	ER32	.078-.787"	032-SPAN	3.00"	1.34"	1.97"
B3017-0032-5.00	Standard	ER32	.078-.787"	032-SPAN	5.00"	1.34"	1.97"

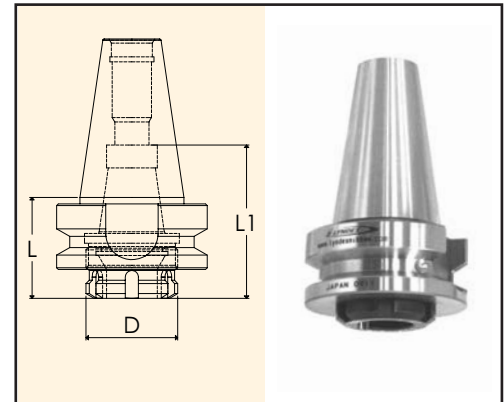

Stubby

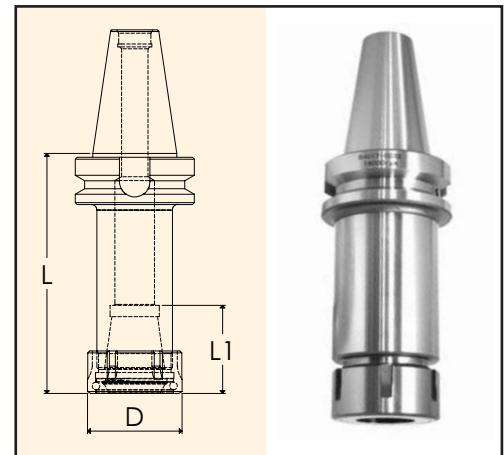

Standard

## BT40

Part Number	Style	Collet Size	Collet Range	Nut Wrench	L	L1	D
B4007-0008-2.50	Standard	ER8	.019-.196"	08-NASPAN	2.50"	0.51"	0.47"
B4017-0008-4.00	Standard	ER8	.019-.196"	08-NASPAN	4.00"	0.51"	0.47"
B4007-0011-2.50	Standard	ER11	.019-.275"	011-HEX	2.50"	0.65"	0.75"
B4017-0011-4.00	Standard	ER11	.019-.275"	011-HEX	4.00"	0.65"	0.75"
B4027-0011-6.00	Standard	ER11	.019-.275"	011-HEX	6.00"	0.65"	0.75"
B40S7-0016-2.50	<b>Stubby</b>	ER16	.019-.406"	016-SPAN	2.50"	-	-
B4007-0016-3.50	Standard	ER16	.019-.406"	016-SPAN	3.50"	0.87"	1.26"
B4017-0016-5.00	Standard	ER16	.019-.406"	016-SPAN	5.00"	0.87"	1.26"
B4007-0020-2.50	Standard	ER20	.039-.511"	020-SPAN	2.50"	1.06"	1.38"
B4017-0020-4.00	Standard	ER20	.039-.511"	020-SPAN	4.00"	1.06"	1.38"
B4027-0020-6.00	Standard	ER20	.039-.511"	020-SPAN	6.00"	1.06"	1.38"
B4007-0025-2.25	Standard	ER25	.039-.629"	025-SPAN	2.25"	1.18"	1.65"
B4017-0025-4.00	Standard	ER25	.039-.629"	025-SPAN	4.00"	1.18"	1.65"
B4027-0025-6.00	Standard	ER25	.039-.629"	025-SPAN	6.00"	1.18"	1.65"

Note: ER Collets Chucks come with back-up screw.

When removing the back-up screw, ER Collet Chucks have coolant-thru capabilities. No disc, special nut or wrench required!  
See ER Coolant Collets on pages 46 - 51.



### Accessories:

	<b>ER Collets</b> Pages 46-53		<b>ER Torque Wrench</b> Page 55		<b>ER Back Up Screw</b> Page 55		<b>ER Nut</b> Page 54
--	----------------------------------	--	------------------------------------	--	------------------------------------	--	--------------------------



## BT ER Collet Chucks

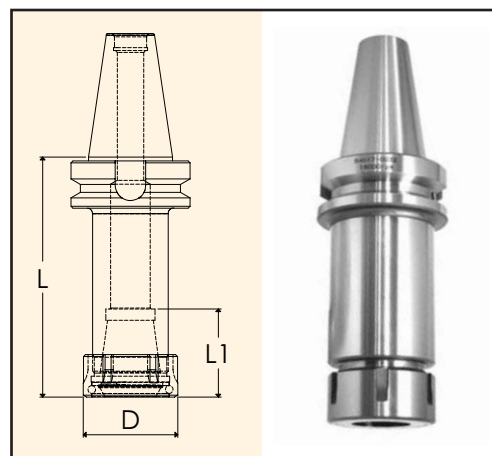

### BT40

Part Number	Style	Collet Size 	Collet Range	Nut Wrench 	L	L1	D
B4027-0025-6.00	Standard	ER25	.039-.629"	025-SPAN	6.00"	1.18"	1.65"
B4007-0032-3.13	Standard	ER32	.078-.787"	032-SPAN	3.13"	1.34"	1.97"
B4017-0032-5.00	Standard	ER32	.078-.787"	032-SPAN	5.00"	1.34"	1.97"
B4007-0040-3.13	Standard	ER40	.118-1.023"	040-SPAN	3.13"	1.50"	2.50"
B4017-0040-5.00	Standard	ER40	.118-1.023"	040-SPAN	5.00"	1.50"	2.50"



Standard

### BT50

Part Number	Style	Collet Size 	Collet Range	Nut Wrench 	L	L1	D
B5007-0016-4.12	Standard	ER16	.019-.406"	016-SPAN	4.12"	0.87"	1.26"
B5017-0016-6.00	Standard	ER16	.019-.406"	016-SPAN	6.00"	0.87"	1.26"
B5007-0020-2.75	Standard	ER20	.039-.511"	020-SPAN	2.75"	1.06"	1.38"
B5017-0020-4.00	Standard	ER20	.039-.511"	020-SPAN	4.00"	1.06"	1.38"
B5007-0025-2.63	Standard	ER25	.039-.629"	025-SPAN	2.63"	1.18"	1.65"
B5017-0025-4.00	Standard	ER25	.039-.629"	025-SPAN	4.00"	1.18"	1.65"
B5007-0032-4.00	Standard	ER32	.078-.787"	032-SPAN	4.00"	1.34"	2.00"
B5017-0032-6.00	Standard	ER32	.078-.787"	032-SPAN	6.00"	1.34"	2.00"
B5007-0040-4.00	Standard	ER40	.118-1.023"	040-SPAN	4.00"	1.50"	2.50"
B5017-0040-6.00	Standard	ER40	.118-1.023"	040-SPAN	6.00"	1.50"	2.50"

Note: ER Collets Chucks come with back-up screw.



When removing the back-up screw, ER Collet Chucks have coolant-thru capabilities. No disc, special nut or wrench required!  
See ER Coolant Collets on pages 46 - 51.

#### Accessories:



ER Collets  
Pages 46-53



ER Torque Wrench  
Page 55



ER Back Up Screw  
Page 55



ER Nut  
Page 54

# HSK ER Collet Chucks

- Ball bearing nut with ground collet race
- AT3 or better taper
- Equipped with a left-hand-threaded stop screw
- Available in high-speed balanceable versions

Please note that the maximum RPM listed in our catalog may vary depending on the toolholder shank, weight, balanceability and the G rating.



**TIR:** < .0001 at collet face



**Speed:** up to 23,000 rpm



**Set-up:** quick and easy



**Coolant-thru:** thru-tool coolant



**Drilling**  
★★★★☆



**Milling**  
★★★★☆



**Reaming**  
★★★★☆



**Tapping**  
★★★★☆

## HSK40A/63A

Part Number	Taper	Collet Size	Collet Range	Nut Wrench	L	L1	D
HSK40A-ER11-75	HSK40A	ER11	.019-.275"	011-HEX	2.71"	0.5"	0.71"
HSK40A-ER16-75	HSK40A	ER16	.019-.393"	016-SPAN	2.56"	0.67"	1.26"
HSK40A-ER20-75	HSK40A	ER20	.039-.511"	020-SPAN	2.95"	1.2"	1.38"
HSK40A-ER25-80	HSK40A	ER25	.039-.629"	025-SPAN	3.15"	1.4"	1.65"
HSK40A-ER32-80	HSK40A	ER32	.078-.787"	032-SPAN	3.15"	1.6"	1.97"
HSK63A-ER16-3.00	HSK63A	ER16	.019-.393"	016-SPAN	3.00"	0.866"	1.260"
HSK63A-ER16-5.00	HSK63A	ER16	.019-.393"	016-SPAN	5.00"	0.866"	1.260"
HSK63A-ER20-3.00	HSK63A	ER20	.039-.511"	020-SPAN	3.00"	1.062"	1.378"
HSK63A-ER20-5.00	HSK63A	ER20	.039-.511"	020-SPAN	5.00"	1.062"	1.378"
HSK63A-ER25-3.00	HSK63A	ER25	.039-.629"	025-SPAN	3.00"	1.181"	1.654"
HSK63A-ER25-5.00	HSK63A	ER25	.039-.629"	025-SPAN	5.00"	1.181"	1.654"
HSK63A-ER32-4.00	HSK63A	ER32	.078-.787"	032-SPAN	4.00"	1.260"	1.969"
HSK63A-ER32-6.00	HSK63A	ER32	.078-.787"	032-SPAN	6.00"	1.260"	1.969"
HSK63A-ER40-4.00	HSK63A	ER40	.118-1.023"	040-SPAN	4.00"	1.496"	2.480"
HSK63A-ER40-6.00	HSK63A	ER40	.118-1.023"	040-SPAN	6.00"	1.496"	2.480"

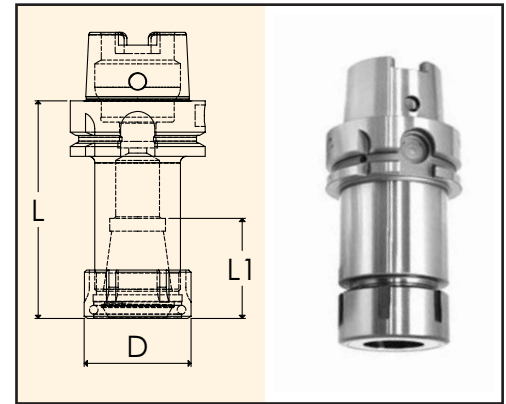

## HSK100A

Part Number	Taper	Collet Size	Collet Range	Nut Wrench	L	L1	D
HSK100A-ER16-4.00	HSK100A	ER16	.019-.393"	016-SPAN	4.00"	0.866"	1.260"
HSK100A-ER16-6.00	HSK100A	ER16	.019-.393"	016-SPAN	6.00"	0.866"	1.260"
HSK100A-ER20-4.00	HSK100A	ER20	.039-.511"	020-SPAN	4.00"	1.062"	1.378"
HSK100A-ER20-6.00	HSK100A	ER20	.039-.511"	020-SPAN	6.00"	1.062"	1.378"
HSK100A-ER25-4.00	HSK100A	ER25	.039-.629"	025-SPAN	4.00"	1.181"	1.654"
HSK100A-ER25-6.00	HSK100A	ER25	.039-.629"	025-SPAN	6.00"	1.181"	1.654"
HSK100A-ER32-4.00	HSK100A	ER32	.078-.787"	032-SPAN	4.00"	1.260"	1.969"
HSK100A-ER32-6.00	HSK100A	ER32	.078-.787"	032-SPAN	6.00"	1.260"	1.969"
HSK100A-ER40-4.00	HSK100A	ER40	.118-1.023"	040-SPAN	4.00"	1.496"	2.480"
HSK100A-ER40-6.00	HSK100A	ER40	.118-1.023"	040-SPAN	6.00"	1.496"	2.480"

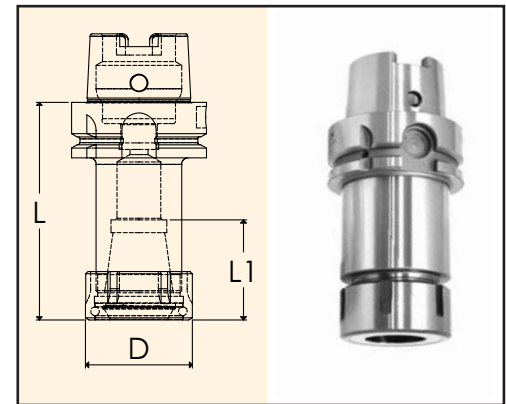

Note: Coolant tube and coolant wrench not included. See page 55 for details.



When removing the back-up screw, ER Collet Chucks have coolant-thru capabilities. No disc, special nut or wrench required!  
See ER Coolant Collets on pages 46 - 51.

### Accessories:



**ER Collets**  
Pages 46-53



**ER Torque Wrench**  
Page 55



**ER Back Up Screw**  
Page 55







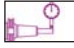

**ER Nut**  
Page 54

## NMTB and R8 ER Collet Chucks

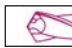

- Ball bearing nut with ground collet race
- AT3 or better taper
- Equipped with a left-hand-threaded stop screw

Please note that the maximum RPM listed in our catalog may vary depending on the toolholder shank, weight, balanceability and the G rating.

-  **TIR:** < .0001 at collet face
-  **Speed:** up to 23,000 rpm
-  **Set-up:** quick and easy
-  **Coolant-thru:** thru-tool coolant

-  **Drilling**  
★★★★☆
-  **Milling**  
★★★★☆
-  **Reaming**  
★★★★☆
-  **Tapping**  
★★★★☆



### NMTB30/40/50

Part Number	Taper	Collet Size 	Collet Range	Nut Wrench 	L	L1	D
N3007-0011-2.00	NMTB30	ER11	.019-.275"	011-HEX	2.00"	0.65"	0.75"
N3007-0016-1.77	NMTB30	ER16	.019-.406"	016-SPAN	1.77"	0.87"	1.26"
N4007-0011-2.00	NMTB40	ER11	.019-.275"	011-HEX	2.00"	0.65"	0.75"
N4007-0016-1.77	NMTB40	ER16	.019-.406"	016-SPAN	1.77"	0.87"	1.26"
N4007-0025-2.00	NMTB40	ER25	.039-.629"	025-SPAN	2.00"	1.18"	1.65"
N5007-0016-2.00	NMTB50	ER16	.019-.406"	016-SPAN	2.00"	0.87"	1.26"
N5007-0025-2.00	NMTB50	ER25	.039-.629"	025-SPAN	2.00"	1.18"	1.65"

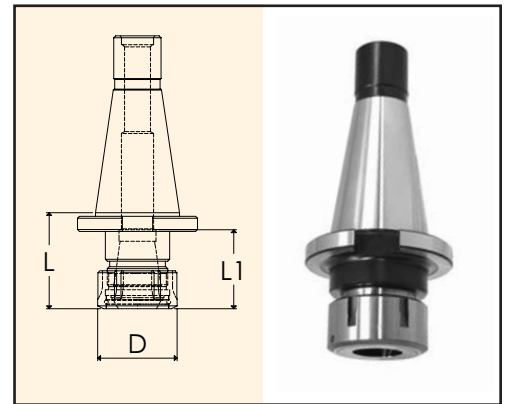
NMTB shanks are suitable for use with Erickson QC spindles.



### R8

Part Number	Collet Size 	Collet Range	Nut Wrench 	L	L1	D
R8007-0016-1.00	ER16	.019-.406"	016-SPAN	1.00"	2.83"	1.25"
R8007-0020-2.00	ER20	.039-.511"	020-SPAN	2.00"	1.50"	1.38"
R8007-0025-2.50	ER25	.039-.629"	025-SPAN	2.50"	1.64"	1.66"

Note: ER Collet Chucks come with back-up screw.



When removing the back-up screw, ER Collet Chucks have coolant-thru capabilities. No disc, special nut or wrench required!  
See ER Coolant Collets on pages 46 - 51.

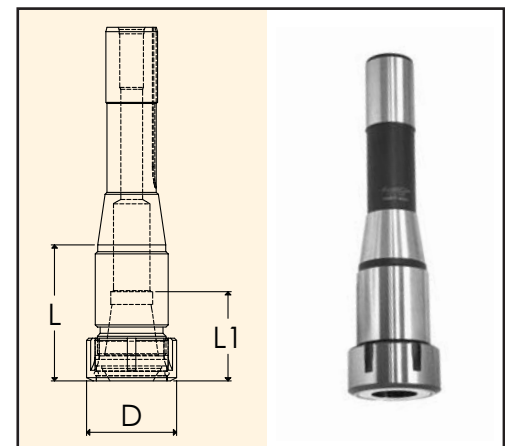

### Accessories:



ER Collets  
Pages 46-53



ER Torque Wrench  
Page 55





ER Back Up Screw  
Page 55



ER Nut  
Page 54

## ER Collet Chuck Extensions

Part Number	Collet Size 	Collet Range	Nut Wrench 	D	D1	L	L1	L2
ER8-EXT-500	ER8	.019-.196"	08-NASPAN	1/2"	0.47"	5.95"	0.75"	5.00"
ER8-EXT-625	ER8	.019-.196"	08-NASPAN	5/8"	0.47"	5.95"	0.75"	5.00"
E11-EXT-500	ER11	.019-.275"	011-HEX	1/2"	0.75"	5.65"	0.91"	5.00"
E11-EXT-625	ER11	.019-.275"	011-HEX	5/8"	0.75"	5.65"	0.91"	5.00"
E11-EXT-750	ER11	.019-.275"	011-HEX	3/4"	0.75"	5.65"	0.91"	5.00"
E16-EXT-100	ER16	.019-.406"	016-SPAN	1"	1.26"	5.89"	1.28"	5.00"
E16-EXT-625	ER16	.019-.406"	016-SPAN	5/8"	1.26"	5.89"	1.28"	5.00"
E16-EXT-750	ER16	.019-.406"	016-SPAN	3/4"	1.26"	5.89"	1.28"	5.00"
E20-EXT-100	ER20	.039-.511"	020-SPAN	1"	1.38"	6.40"	1.48"	5.00"
E20-EXT-125	ER20	.039-.511"	020-SPAN	1-1/4"	1.38"	6.40"	1.48"	5.00"
E20-EXT-750	ER20	.039-.511"	020-SPAN	3/4"	1.38"	6.40"	1.48"	5.00"
E25-EXT-100	ER25	.039-.629"	025-SPAN	1"	1.65"	6.00"	1.65"	5.00"
E25-EXT-125	ER25	.039-.629"	025-SPAN	1-1/4"	1.65"	6.00"	1.65"	5.00"
E25-EXT-750	ER25	.039-.629"	025-SPAN	3/4"	1.65"	6.00"	1.65"	5.00"
E32-EXT-100	ER32	.078-.787"	032-SPAN	1"	1.97"	7.09"	1.85"	5.00"
E32-EXT-125	ER32	.078-.787"	032-SPAN	1-1/4"	1.97"	7.09"	1.85"	5.00"

Please note that ER16 Collet Chuck Extensions use a ER11-3 back up screw.  
Note: ER Collet Chucks come with back-up screw.

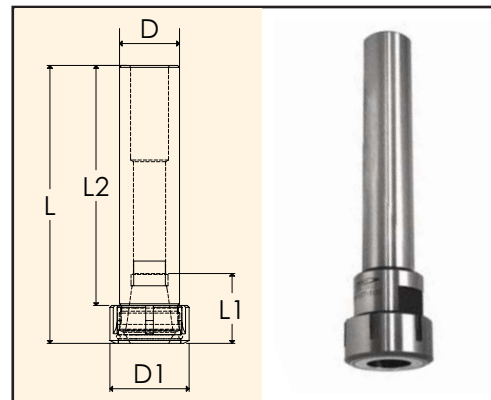

When removing the back-up screw, ER Collet Chucks have coolant-thru capabilities. No disc, special nut or wrench required!  
See ER Coolant Collets on pages 46 - 51.

## High-Speed Balanceable ER Collet Chucks

Balanceable ER Collet Chucks are available in CAT and BT taper styles. Part numbers are identical to standard ER Collet Chuck part numbers except that there is a "B" at the end. (Ex: C4007-008-2.50**B**)

- 30 and 40 taper toolholders are prebalanced to G2.5 or better at 24,000 RPM
- 50 taper toolholders are prebalanced to G2.5 or better at 15,000 RPM
- Lyndex-Nikken uses a Patented Balancing Method which allows greater compensation necessary for extremely high RPM applications.
- hSBalance™ toolholders come with a printout of actual balance condition
- hSBalance™ toolholders need to be used with balance-qualified pull studs
- A balancing machine is required to balance or re-balance toolholders



CAT40 hSBalance™ ER Collet Chuck



CAT40 hSBalance™ ER Collet Chuck - DIN

### Accessories:



ER Collets  
Pages 46-53



ER Torque Wrench  
Page 55



ER Back Up Screw  
Page 55



ER Nut  
Page 54

# ER Straight Shank

## DOUBLE ENDED straight shank with flat and mini-style Hi-Q nut

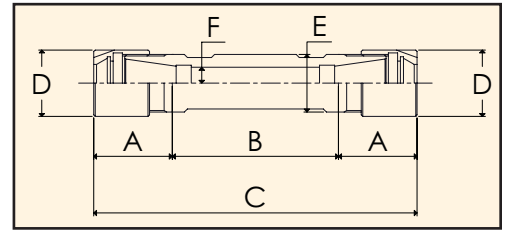
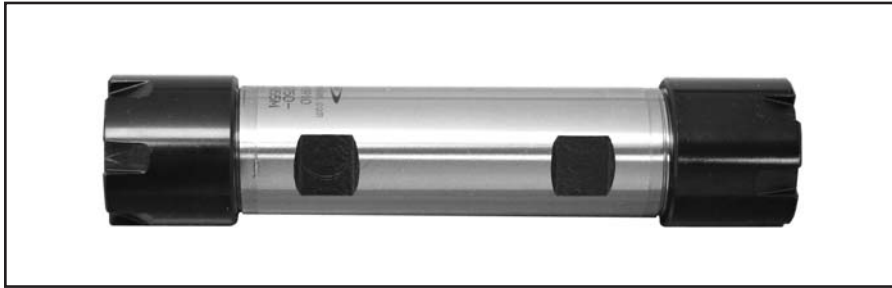

Part Number	ER Size	Nut style	Shank Type	A mm (inch)	B mm (inch)	C mm (inch)	Nut Dia. D mm (inch)	Shank Dia. E mm (inch)	F mm (inch)	Machine
SDF-0625-ER08-015M	ER8	Mini	With Flat	15 (.591")	15 (.591")	45 (1.772")	12 (.472")	15.875 (.625")	2.6 (.102")	☼
SDF-0625-ER08-025M	ER8	Mini	With Flat	15 (.591")	25 (.984")	55 (2.165")	12 (.472")	15.875 (.625")	2.6 (.102")	☼
SDF-0016-ER11-050M	ER11	Mini	With Flat	20 (.787")	50 (1.969")	90 (3.543")	16 (.630")	16 (.630")	3.75 (.148")	★
SDF-0750-ER11-040M	ER11	Mini	With Flat	20 (.787")	40 (1.575")	80 (3.150")	16 (.630")	19.05 (.750")	3.75 (.148")	X
SDF-0750-ER11-070M	ER11	Mini	With Flat	20 (.787")	70 (2.756")	110 (4.331")	16 (.630")	19.05 (.750")	3.75 (.148")	X
SDF-0750-ER11-090M	ER11	Mini	With Flat	20 (.787")	90 (3.543")	130 (5.118")	16 (.630")	19.05 (.750")	3.75 (.148")	X
SDF-0020-ER11-030M	ER11	Mini	With Flat	20 (.787")	30 (1.181")	70 (2.756")	16 (.630")	20 (.787")	3.75 (.148")	□
SDF-0020-ER11-050M	ER11	Mini	With Flat	20 (.787")	50 (1.969")	90 (3.543")	16 (.630")	20 (.787")	3.75 (.148")	□
SDF-0750-ER16-055M	ER16	Mini	With Flat	26 (1.024")	55 (2.165")	107 (4.213")	22 (.866")	19.05 (.750")	5.25 (.207")	X
SDF-0020-ER16-055M	ER16	Mini	With Flat	26 (1.024")	55 (2.165")	107 (4.213")	22 (.866")	20 (.787")	5.25 (.207")	□
SDF-0022-ER16-055M	ER16	Mini	With Flat	28 (1.102")	55 (2.165")	111 (4.370")	22 (.866")	22 (.866")	5.25 (.207")	★, □
SDF-0022-ER16-075M	ER16	Mini	With Flat	28 (1.102")	75 (2.953")	131 (5.157")	22 (.866")	22 (.866")	5.25 (.207")	★, □
SDF-0025-ER16-062M	ER16	Mini	With Flat	28 (1.102")	62 (2.441")	118 (4.646")	22 (.866")	25 (.984")	5.25 (.207")	☼
SDF-1000-ER16-062M	ER16	Mini	With Flat	28 (1.102")	62 (2.441")	118 (4.646")	22 (.866")	25.4 (1.00")	5.25 (.207")	○
SDF-0032-ER20-055M	ER20	Mini	With Flat	28 (1.102")	55 (2.165")	111 (4.370")	28 (1.102")	32 (1.260")	6.75 (.266")	various
SDF-0032-ER20-075M	ER20	Mini	With Flat	28 (1.102")	75 (2.953")	131 (5.157")	28 (1.102")	32 (1.260")	6.75 (.266")	various

Machine Key: Citizen - X, Miyano - ○, Tsugami - □, Star - ★, Tornos - ☼

## ER Straight Shank Application Examples

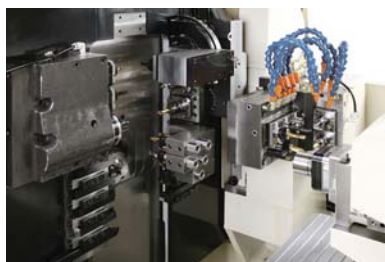

### Accessories:



ER Collets  
Pages 46-53



ER Torque Wrench  
Page 55



ER Back Up Screw  
Page 55



ER Nut  
Page 54

# ER Straight Shank

## SINGLE ENDED straight shank with mini style Hi-Q nut

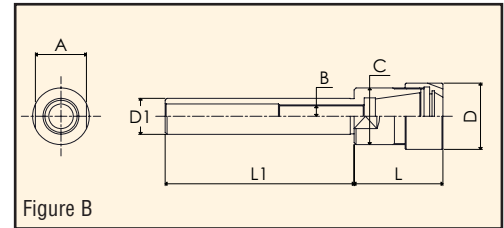
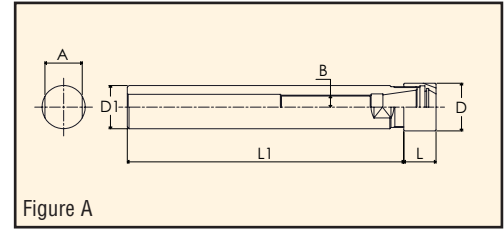

Part Number	ER Size	Nut style	Shank Type	A mm(inch)	B Dia. mm(inch)	C mm(inch)	Shank Dia. D1 mm(inch)	Nut Dia. D mm(inch)	L1 mm(inch)	L mm(inch)	Fig.	Machine
SS-0008-ER08-080M	ER8	Mini	Round	8 (.315")	3 (.118")	10 (.394")	8 (.315")	12 (.472")	80 (3.150")	26 (1.024")	B	various
SS-0375-ER08-070M	ER8	Mini	Round	8 (.315")	M5 thread	10 (.394")	9.52 (.375")	12 (.472")	70 (2.756")	23 (.906")	B	X
SS-0012-ER08-080M	ER8	Mini	Round	10 (.394")	5.2 (.205")	-	12 (.472")	12 (.472")	86.2 (3.394")	10.8 (.425")	A	various
SS-0006-ER11-045M	ER11	Mini	Round	11 (.433")	-	13 (.512")	6 (.236")	16 (.630")	45 (1.772")	26.5 (1.043")	B	various
SS-0007-ER11-045M	ER11	Mini	Round	11 (.433")	-	13 (.512")	7 (.276")	16 (.630")	45 (1.772")	26.5 (1.043")	B	various
SS-0008-ER11-055M	ER11	Mini	Round	11 (.433")	4 (.157")	13 (.512")	8 (.315")	16 (.630")	56 (2.205")	26.5 (1.043")	B	various
SS-0500-ER11-140M	ER11	Mini	Round	11 (.433")	M6 thread	13 (.512")	12.7 (.500")	16 (.630")	140 (5.512")	29.5 (1.161")	B	various
SS-0625-ER11-150M	ER11	Mini	Round	14 (.551")	M8 P1 thread	-	15.875 (.625")	16 (.630")	160.5 (6.319")	12 (.472")	A	☼
SS-0016-ER11-150M	ER11	Mini	Round	14 (.551")	M8 P1 thread	-	16 (.630")	16 (.630")	159 (6.260")	12 (.472")	A	★
SS-0010-ER16-060M	ER16	Mini	Round	17 (.669")	5.2 (.205")	19 (.748")	10 (.394")	22 (.866")	60 (2.362")	38.5 (1.516")	B	various
SS-0012-ER16-080M	ER16	Mini	Round	17 (.669")	7 (.276")	19 (.748")	12 (.472")	22 (.866")	80 (3.150")	38.5 (1.516")	B	various
SS-0500-ER16-140M	ER16	Mini	Round	17 (.669")	M6 thread	19 (.748")	12.7 (.500")	22 (.866")	140 (5.512")	37 (1.457")	B	various
SS-0750-ER16-155M	ER16	Mini	Round	17 (.669")	M12 P1 thread	-	19.05 (.750")	22 (.866")	163 (6.417")	18.5 (.728")	A	X
SS-0020-ER16-155M	ER16	Mini	Round	17 (.669")	M12 P1 thread	-	20 (.787")	22 (.866")	163 (6.417")	18.5 (.728")	A	□
SS-0015-ER20-100M	ER20	Mini	Round	22 (.866")	8.5 (.335")	24 (.945")	15 (.591")	28 (1.102")	100 (3.937")	42.5 (1.673")	B	various
SS-0016-ER20-100M	ER20	Mini	Round	22 (.866")	8.5 (.335")	24 (.945")	16 (.630")	28 (1.102")	100 (3.937")	42.5 (1.673")	B	★
SS-0025-ER20-155M	ER20	Mini	Round	22 (.866")	M14 P1 thread	-	25 (.984")	28 (1.102")	162.5 (6.398")	19 (.748")	A	☼
SS-1000-ER20-155M	ER20	Mini	Round	22 (.866")	M14 P1 thread	-	25.4 (1.00")	28 (1.102")	162.5 (6.398")	19 (.748")	A	X, ○
SS-0750-ER25-100M	ER25	Mini	Round	27 (1.063")	M12 P1 thread	30 (1.181")	19.05 (.750")	35 (1.378")	100 (3.937")	47 (1.850")	B	X

Machine Key: Citizen - X, Miyano - ○, Tsugami - □, Star - ★, Tornos - ☼

**Accessories:**



**ER Collets**  
Pages 46-53



**ER Torque Wrench**  
Page 55



**ER Back Up Screw**  
Page 55



**ER Nut**  
Page 54

# ER Straight Shank

## SINGLE ENDED straight shank with flat and mini style Hi-Q nut

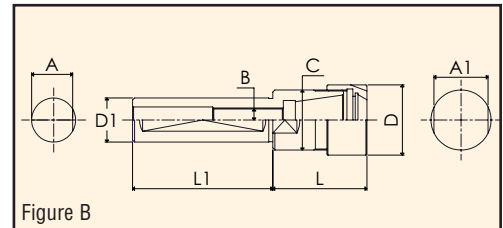
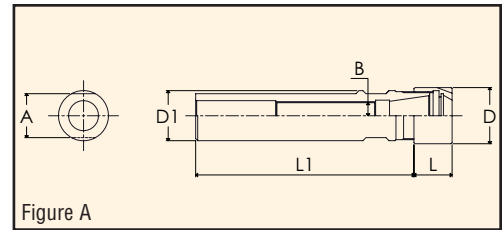

Part Number	ER Size	Shank Type	A /A1 mm (inch)	B dia. mm(inch)	C mm(inch)	Shank Dia. D1 mm(inch)	Nut Dia. D mm(inch)	L1 mm(inch)	L mm(inch)	Fig.	Machine
SSF-0625-ER08-043M	ER8	w/Flat	14 (.551")	M5 thread	-	15.875 (.625")	12 (.472")	47.2 (1.858")	10.8 (.425")	A	⊗
SSF-0016-ER11-038M	ER11	w/Flat	14 (.551")	M8 P1 thread	-	16 (.630")	16 (.630")	46(1.811")	12 (.472")	A	★
SSF-0016-ER11-140M	ER11	w/Flat	14 (.551")	M8 P1 thread	-	16 (.630")	16 (.630")	148 (5.827")	12 (.472")	A	★
SSF-0750-ER11-115M	ER11	w/Flat	17 (.669")	M8 P1 thread	-	19.05 (.750")	16 (.630")	123 (4.843")	12 (.472")	A	X
SSF-0016-ER16-035M	ER16	w/Flat	15/17 (.591"/.669")	M8 P1 thread	19 (.748")	16 (.630")	22 (.866")	35 (1.378")	28 (1.102")	B	★
SSF-0750-ER16-038M	ER16	w/Flat	17 (.669")	M12 P1 thread	-	19.05 (.750")	22 (.866")	47.5 (1.870")	18.5 (.728")	A	X
SSF-0750-ER16-050M	ER16	w/Flat	17 (.669")	M12 P1 thread	-	19.05 (.750")	22 (.866")	59.5 (2.343")	18.5 (.728")	A	X
SSF-0750-ER16-070M	ER16	w/Flat	17 (.669")	M12 P1 thread	-	19.05 (.750")	22 (.866")	79.5 (3.130")	18.5 (.728")	A	X
SSF-0750-ER16-120M	ER16	w/Flat	17 (.669")	M12 P1 thread	-	19.05 (.750")	22 (.866")	129.5 (5.098")	18.5 (.728")	A	X
SSF-0750-ER16-140M	ER16	w/Flat	17 (.669")	M12 P1 thread	-	19.05 (.750")	22 (.866")	149.5 (5.886")	18.5 (.728")	A	X
SSF-0020-ER16-050M	ER16	w/Flat	17 (.669")	M12 P1 thread	-	20 (.787")	22 (.866")	59.5 (2.343")	18.5 (.728")	A	□
SSF-0020-ER16-070M	ER16	w/Flat	17 (.669")	M12 P1 thread	-	20 (.787")	22 (.866")	79.5 (3.130")	18.5 (.728")	A	□
SSF-0020-ER16-120M	ER16	w/Flat	17 (.669")	M12 P1 thread	-	20 (.787")	22 (.866")	129.5 (5.098")	18.5 (.728")	A	□
SSF-0020-ER16-140M	ER16	w/Flat	17 (.669")	M12 P1 thread	-	20 (.787")	22 (.866")	149.5 (5.886")	18.5 (.728")	A	□
SSF-0022-ER16-038M	ER16	w/Flat	19 (.748")	M12 P1 thread	-	22 (.866")	22 (.866")	47.5 (1.870")	18.5 (.728")	A	★, □
SSF-0022-ER16-070M	ER16	w/Flat	19 (.748")	M12 P1 thread	-	22 (.866")	22 (.866")	79.5 (3.130")	18.5 (.728")	A	★, □
SSF-0022-ER16-100M	ER16	w/Flat	19 (.748")	M12 P1 thread	-	22 (.866")	22 (.866")	109.5 (4.311")	18.5 (.728")	A	★, □
SSF-0025-ER16-065M	ER16	w/Flat	22 (.866")	M12 P1 thread	-	25 (.984")	22 (.866")	74.5 (2.933")	18.5 (.728")	A	⊗
SSF-1000-ER16-065M	ER16	w/Flat	22 (.866")	M12 P1 thread	-	25.4 (1.00")	22 (.866")	74.5 (2.933")	18.5 (.728")	A	X, ○
SSF-1000-ER16-075M	ER16	w/Flat	22 (.866")	M12 P1 thread	-	25.4 (1.00")	22 (.866")	84.5 (3.327")	18.5 (.728")	A	X, ○
SSF-1000-ER16-100M	ER16	w/Flat	22 (.866")	M12 P1 thread	-	25.4 (1.00")	22 (.866")	109.5 (4.311")	18.5 (.728")	A	X, ○
SSF-0022-ER20-080M	ER20	w/Flat	20.5/22 (.807"/.866")	M12 P1 thread	24 (.945")	22 (.866")	28 (1.102")	80 (3.150")	39 (1.535")	B	★, □
SSF-0025-ER20-100M	ER20	w/Flat	22 (.866")	M14 P1 thread	-	25 (.984")	28 (1.102")	109 (4.291")	19 (.748")	A	⊗
SSF-0025-ER20-154M	ER20	w/Flat	22 (.866")	M14 P1 thread	-	25 (.984")	28 (1.102")	163 (6.417")	19 (.748")	A	⊗
SSF-1000-ER20-100M	ER20	w/Flat	22 (.866")	M14 P1 thread	-	25.4 (1.00")	28 (1.102")	109 (4.291")	19 (.748")	A	X, ○
SSF-1000-ER20-140M	ER20	w/Flat	22 (.866")	M14 P1 thread	-	25.4 (1.00")	28 (1.102")	149 (5.866")	19 (.748")	A	X, ○
SSF-0022-ER25-070M	ER25	w/Flat	20.5/27 (.807"/1.063")	M14 P1 thread	30 (1.181")	22 (.866")	35 (1.378")	70 (2.756")	47 (1.850")	B	★, □
SSF-0025-ER25-075M	ER25	w/Flat	23.5/27 (.925"/1.063")	M14 P1 thread	30 (1.181")	25 (.984")	35 (1.378")	75 (2.953")	47 (1.850")	B	⊗
SSF-0025-ER25-145M	ER25	w/Flat	23.5/27 (.925"/1.063")	M14 P1 thread	30 (1.181")	25 (.984")	35 (1.378")	145 (5.709")	36 (1.417")	B	⊗
SSF-0032-ER25-070M	ER25	w/Flat	27 (1.063")	M18 P1.5 thread	-	32 (1.260")	35 (1.378")	80 (3.150")	20 (.787")	A	various

Machine Key: Citizen - X, Miyano - ○, Tsugami - □, Star - ★, Tornos - ⊗

**Accessories:**



**ER Collets**  
Pages 46-53



**ER Torque Wrench**  
Page 55



**ER Back Up Screw**  
Page 55



**ER Nut**  
Page 54

# ER Straight Shank

## SINGLE ENDED straight shank with standard Hi-Q nut

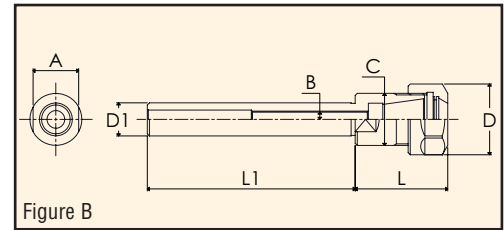
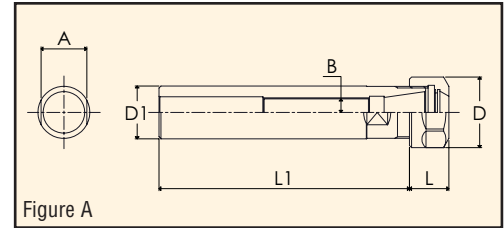
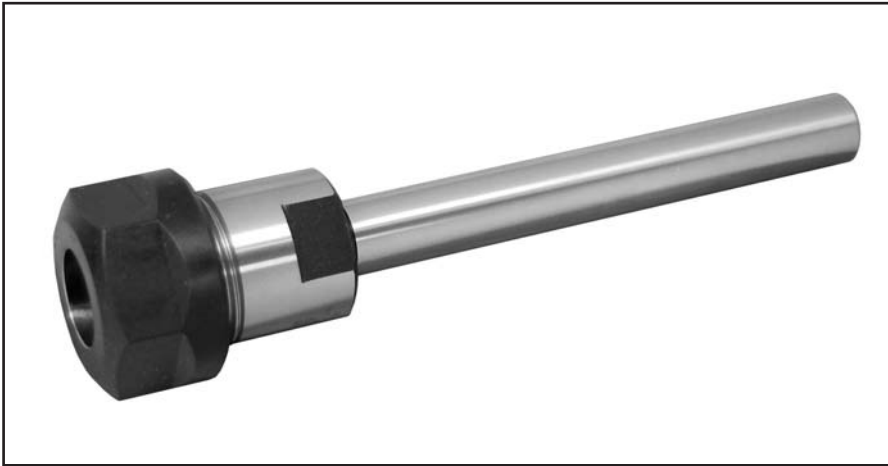

Part Number	ER Size	Shank Type	A /A1 mm (inch)	B dia. mm(inch)	C mm(inch)	Shank Dia.D1 mm(inch)	Nut Dia.D mm(inch)	L1 mm(inch)	L mm(inch)	Fig.	Machine
SS-0500-ER11-070	ER11	Round	11 (.433")	M6 thread	14 (.551")	12.7 (.500")	19 (.748")	70 (2.756")	28.5 (1.122")	B	various
SS-0500-ER16-100	ER16	Round	19 (.748")	M6 thread	22 (.866")	12.7 (.500")	28 (1.102")	100 (3.937")	36 (1.417")	B	various
SS-0014-ER16-060	ER16	Round	19 (.748")	M6 thread	22 (.866")	14 (.551")	28 (1.102")	60 (2.362")	36.5 (1.437")	B	various
SS-0625-ER16-060	ER16	Round	19 (.748")	M8 P1 thread	22 (.866")	15.875 (.625")	28 (1.102")	60 (2.362")	36.5 (1.437")	B	☆
SS-0016-ER16-060	ER16	Round	19 (.748")	M8 P1 thread	22 (.866")	16 (.630")	28 (1.102")	60 (2.362")	36.5 (1.437")	B	various
SS-0750-ER16-050	ER16	Round	19 (.748")	M12 P1 thread	22 (.866")	19.05 (.750")	28 (1.102")	50 (1.969")	30.5 (1.201")	B	X
SS-0750-ER16-100	ER16	Round	19 (.748")	M12 P1 thread	22 (.866")	19.05 (.750")	28 (1.102")	100 (3.937")	30.5 (1.201")	B	X
SS-0020-ER16-050	ER16	Round	19 (.748")	M12 P1 thread	22 (.866")	20 (.787")	28 (1.102")	50 (1.969")	30.5 (1.201")	B	□
SS-0020-ER16-100	ER16	Round	19 (.748")	M12 P1 thread	22 (.866")	20 (.787")	28 (1.102")	100 (3.937")	30.5 (1.201")	B	□
SS-0500-ER20-100	ER20	Round	22 (.866")	M6 thread	25 (.984")	12.7 (.500")	34 (1.339")	100 (3.937")	44.5 (1.752")	B	various
SS-0625-ER20-100	ER20	Round	22 (.866")	M8 P1 thread	25 (.984")	15.875 (.625")	34 (1.339")	100 (3.937")	44.5 (1.752")	B	☆
SS-0750-ER20-060	ER20	Round	22 (.866")	M12 P1 thread	25 (.984")	19.05 (.750")	34 (1.339")	60 (2.362")	36.5 (1.437")	B	X
SS-0020-ER20-030	ER20	Round	22 (.866")	M12 P1 thread	25 (.984")	20 (.787")	34 (1.339")	30 (1.181")	36.5 (1.437")	B	□
SS-0020-ER20-060	ER20	Round	22 (.866")	M12 P1 thread	25 (.984")	20 (.787")	34 (1.339")	60 (2.362")	36.5 (1.437")	B	□
SS-1000-ER20-100	ER20	Round	22 (.866")	M14 P1 thread	-	25.4 (1.00")	34 (1.339")	120.5 (4.744")	19 (.748")	A	various
SS-0750-ER25-050	ER25	Round	27 (1.063")	M12 P1 thread	32 (1.260")	19.05 (.750")	42 (1.654")	50 (1.969")	47 (1.850")	B	X
SS-0020-ER25-050	ER25	Round	27 (1.063")	M12 P1 thread	32 (1.260")	20 (.787")	42 (1.654")	50 (1.969")	47 (1.850")	B	□
SS-0020-ER25-100	ER25	Round	27 (1.063")	M12 P1 thread	32 (1.260")	20 (.787")	42 (1.654")	100 (3.937")	47 (1.850")	B	□
SS-0025-ER25-050	ER25	Round	27 (1.063")	M18 P1.5 thread	32 (1.260")	25 (.984")	42 (1.654")	50 (1.969")	47 (1.850")	B	☆
SS-0025-ER25-100	ER25	Round	27 (1.063")	M18 P1.5 thread	32 (1.260")	25 (.984")	42 (1.654")	100 (3.937")	47 (1.850")	B	☆
SS-1000-ER25-050	ER25	Round	27 (1.063")	M18 P1.5 thread	32 (1.260")	25.4 (1.00")	42 (1.654")	50 (1.969")	47 (1.850")	B	X, ○
SS-1000-ER25-100	ER25	Round	27 (1.063")	M18 P1.5 thread	32 (1.260")	25.4 (1.00")	42 (1.654")	100 (3.937")	47 (1.850")	B	X, ○
SS-0030-ER25-050	ER25	Round	27 (1.063")	M18 P1.5 thread	32 (1.260")	30 (1.181")	42 (1.654")	50 (1.969")	42 (1.654")	B	various
SS-0020-ER32-050	ER32	Round	36 (1.417")	M12 P1 thread	40 (1.575")	20 (.787")	50 (1.969")	50 (1.969")	54 (2.126")	B	□
SS-0020-ER32-100	ER32	Round	36 (1.417")	M12 P1 thread	40 (1.575")	20 (.787")	50 (1.969")	100 (3.937")	54 (2.126")	B	□
SS-0025-ER32-050	ER32	Round	36 (1.417")	M18 P1.5 thread	40 (1.575")	25 (.984")	50 (1.969")	50 (1.969")	54 (2.126")	B	☆
SS-1000-ER32-050	ER32	Round	36 (1.417")	M18 P1.5 thread	40 (1.575")	25.4 (1.00")	50 (1.969")	50 (1.969")	53 (2.087")	B	X, ○
SS-0030-ER32-050	ER32	Round	36 (1.417")	M22 P1.5 thread	40 (1.575")	30 (1.181")	50 (1.969")	50 (1.969")	53 (2.087")	B	various
SS-1250-ER32-060	ER32	Round	36 (1.417")	M22 P1.5 thread	40 (1.575")	31.75 (1.25")	50 (1.969")	60 (2.362")	53 (2.087")	B	□
SS-0025-ER40-050	ER40	Round	45 (1.772")	M18 P1.5 thread	50 (1.969")	25 (.984")	63 (2.480")	50 (1.969")	60 (2.362")	B	☆
SS-1000-ER40-050	ER40	Round	45 (1.772")	M18 P1.5 thread	50 (1.969")	25.4 (1.00")	63 (2.480")	50 (1.969")	60 (2.362")	B	X, ○

Machine Key: Citizen - X, Miyano - ○, Tsugami - □, Star - ☆, Tornos - ☆

**Accessories:**



**ER Collets**  
Pages 46-53



**ER Torque Wrench**  
Page 55



**ER Back Up Screw**  
Page 55



**ER Nut**  
Page 54



# ER Straight Shank

**SINGLE ENDED** straight shank with flat and standard Hi-Q nut

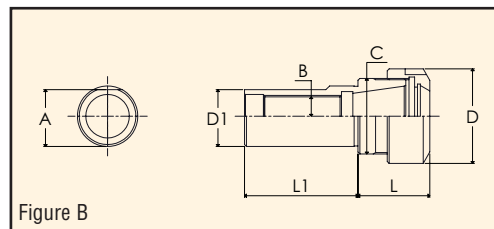
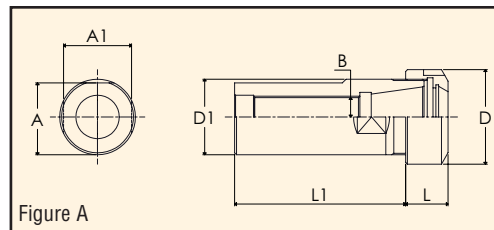

Part Number	ER Size	Nut style Shank	Shank Type	A/A1 mm (inch)	B dia. mm (inch)	C mm (inch)	Shank dia. D1 mm (inch)	Nut dia. D mm (inch)	L1 mm (inch)	L mm (inch)	Fig.	Machine
SSF-0032-ER25-060	ER25	Std	w/Flat	30 (1.181")	M18 P1.5 thread	-	32	42 (1.654")	72 (2.835")	20 (.787")	A	various
SSF-0032-ER32-060	ER32	Std	w/Flat	30 (1.181")	M22 P1.5 thread	40 (1.575")	32	50 (1.969")	60 (2.362")	38 (1.496")	B	various
SSF-0040-ER32-080	ER32	Std	w/Flat	38/36 (1.496"/1.417")	M22 P1.5 thread	-	40	50 (1.969")	90.5 (3.563")	22.5 (.886")	A	various
SSF-0040-ER40-075	ER40	Std	w/Flat	38/44 (1.496"/1.732")	M22 P1.5 thread	50 (1.969")	40	63 (2.480")	75 (2.953")	55 (2.165")	B	various

Machine Key: Citizen - X, Miyano - O, Tsugami - □, Star - ★, Tornos - ⚙

## ER Straight Shank Application Examples

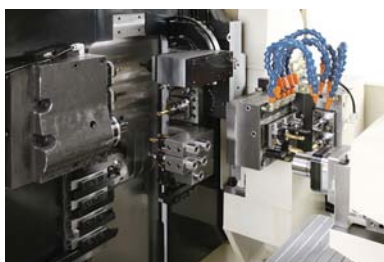

### Accessories:



ER Collets  
Pages 46-53



ER Torque Wrench  
Page 55



ER Back Up Screw  
Page 55



ER Nut  
Page 54

# ER8 and ER11 Collets

## ER8 Collets

Size range: 1.0mm-5.0mm (0.019"-0.196")

METRIC		
Part Number	Size	Collapse Range
ER8-039	1.0mm	1.0-0.5mm
ER8-059	1.5mm	1.5-1.0mm
ER8-078	2.0mm	2.0-1.5mm
ER8-098	2.5mm	2.5-2.0mm
ER8-118	3.0mm	3.0-2.5mm
ER8-137	3.5mm	3.5-3.0mm
ER8-157	4.0mm	4.0-3.5mm
ER8-177	4.5mm	4.5-4.0mm
ER8-196	5.0mm	5.0-4.5mm
ER8-09S	9 Pieces Set 0.5mm - 5.0mm by 0.5mm	



Our patented Coolant Collets are designed for use with cylindrical shank tools (no flats). Cutting tool should be inserted the full length of the collet. If these conditions are not met, coolant leakage may result. Seals up to maximum coolant pressure of 1000PSI.

## ER11 Collets

Size range: 1/32" - 17/64"

Size range: 1.0mm-7.0mm  
(0.019"-0.275")

Size range: 3/16" - 17/64"

Size range: 4.0mm-7.0mm

INCH		
Part Number	Size	Collapse Range
E11-002	1/32"	.031-.027"
E11-003	3/64"	.047-.031"
E11-004	1/16"	.063-.047"
E11-005	5/64"	.078-.063"
E11-006	3/32"	.094-.078"
E11-007	7/64"	.109-.094"
E11-008	1/8"	.125-.109"
E11-009	9/64"	.141-.125"
E11-010	5/32"	.156-.141"
E11-011	11/64"	.172-.156"
E11-012	3/16"	.187-.172"
E11-013	13/64"	.203-.187"
E11-014	7/32"	.219-.203"
E11-015	15/64"	.234-.219"
E11-016	1/4"	.250-.234"
E11-017	17/64"	.266-.250"

METRIC		
Part Number	Size	Collapse Range
E11-039	1.0mm	1.0-0.5mm
E11-059	1.5mm	1.5-1.0mm
E11-078	2.0mm	2.0-1.5mm
E11-098	2.5mm	2.5-2.0mm
E11-118	3.0mm	3.0-2.5mm
E11-137	3.5mm	3.5-3.0mm
E11-157	4.0mm	4.0-3.5mm
E11-177	4.5mm	4.5-4.0mm
E11-196	5.0mm	5.0-4.5mm
E11-216	5.5mm	5.5-5.0mm
E11-236	6.0mm	6.0-5.5mm
E11-255	6.5mm	6.5-6.0mm
E11-275	7.0mm	7.0-6.5mm

INCH-COOLANT-THRU		
Part Number	Size	Collapse Range
-	1/32"	-
-	3/64"	-
-	1/16"	-
-	5/64"	-
-	3/32"	-
-	7/64"	-
-	1/8"	-
-	9/64"	-
-	5/32"	-
-	11/64"	-
E11-012(C)	3/16"	.187" - .183"
E11-013(C)	13/64"	.203" - .199"
E11-014(C)	7/32"	.218" - .214"
E11-015(C)	15/64"	.234" - .230"
E11-016(C)	1/4"	.250" - .246"
E11-017(C)	17/64"	.265" - .261"

METRIC-COOLANT-THRU		
Part Number	Size	Collapse Range
-	1.0mm	-
-	1.5mm	-
-	2.0mm	-
-	-	-
-	2.5mm	-
-	3.0mm	-
-	3.5mm	-
E11-157(C)	4.0mm	4.0mm - 3.5mm
E11-177(C)	4.5mm	4.5mm - 4.0mm
E11-196(C)	5.0mm	5.0mm - 4.5mm
E11-216(C)	5.5mm	5.5mm - 5.0mm
E11-236(C)	6.0mm	6.0mm - 5.5mm
E11-255(C)	6.5mm	6.5mm - 6.0mm
E11-275(C)	7.0mm	7.0mm - 6.5mm

## ER11 Collets Sets

E11-14S	14 Piece Set 1/16" - 1/4" by 64ths
E11-12S	12 Piece Set 1.0mm - 7.0mm by 0.5mm

## ER11 Coolant Collets Sets

E11-6S(C)	6 Piece Set 3/16" - 17/64" by 64ths
E11-7S(C)	7 Piece Set 3.9mm - 7.0mm by 0.5mm

## ER16 Collets



Our patented Coolant Collets are designed for use with cylindrical shank tools (no flats). Cutting tool should be inserted the full length of the collet. If these conditions are not met, coolant leakage may result. Seals up to maximum coolant pressure of 1000PSI.

Size range: 1/32" - 13/32"

Size range: 1.0mm - 10.0mm  
(0.039"-0.393")

Size range: 3/32" - 13/32"

Size range: 4.0mm-10.0mm  
(0.157"-0.393")

INCH		
Part Number	Size	Collapse Range

E16-002	1/32"	.031" - .027"
E16-004	1/16"	.063" - .047"
E16-006	3/32"	.094" - .078"
-	7/64"	-
E16-008	1/8"	.125" - .109"
-	9/64"	-
E16-010	5/32"	.156" - .125"
-	11/64"	-
E16-012	3/16"	.187" - .156"
-	13/64"	-
E16-014	7/32"	.219" - .187"
-	15/64"	-
E16-016	1/4"	.250" - .219"
-	17/64"	-
E16-018	9/32"	.281" - .250"
-	19/64"	-
E16-020	5/16"	.312" - .281"
-	21/64"	-
E16-022	11/32"	.344" - .312"
-	23/64"	-
E16-024	3/8"	.375" - .344"
-	25/64"	-
E16-026	13/32"	.406" - .375"

METRIC		
Part Number	Size	Collapse Range

E16-039	1.0mm	1.0-0.5mm
E16-059	1.5mm	1.5-1.0mm
E16-078	2.0mm	2.0-1.5mm
E16-098	2.5mm	2.5-2.0mm
E16-118	3.0mm	3.0-2.5mm
E16-137	3.5mm	3.5-3.0mm
E16-157	4.0mm	4.0-3.5mm
E16-177	4.5mm	4.5-4.0mm
E16-196	5.0mm	5.0-4.5mm
E16-216	5.5mm	5.5-5.0mm
E16-236	6.0mm	6.0-5.5mm
E16-255	6.5mm	6.5-6.0mm
E16-275	7.0mm	7.0-6.5mm
E16-295	7.5mm	7.5-7.0mm
E16-314	8.0mm	8.0-7.5mm
E16-334	8.5mm	8.5-8.0mm
E16-354	9.0mm	9.0-8.5mm
E16-374	9.5mm	9.5-9.0mm
E16-393	10.0mm	10.0-9.5mm

INCH-COOLANT-THRU		
Part Number	Size	Collapse Range

-	1/32"	-
-	1/16"	-
E16-006(C)	3/32"	.094" - .089"
E16-007(C)	7/64"	.109" - .105"
E16-008(C)	1/8"	.125" - .121"
E16-009(C)	9/64"	.140" - .136"
E16-010(C)	5/32"	.156" - .152"
E16-011(C)	11/64"	.171" - .167"
E16-012(C)	3/16"	.187" - .183"
E16-013(C)	13/64"	.203" - .199"
E16-014(C)	7/32"	.219" - .203"
E16-015(C)	15/64"	.234" - .219"
E16-016(C)	1/4"	.250" - .234"
E16-017(C)	17/64"	.266" - .250"
E16-018(C)	9/32"	.281" - .266"
E16-019(C)	19/64"	.297" - .281"
E16-020(C)	5/16"	.312" - .297"
E16-021(C)	21/64"	.328" - .312"
E16-022(C)	11/32"	.344" - .328"
E16-023(C)	23/64"	.359" - .344"
E16-024(C)	3/8"	.375" - .359"
E16-025(C)	25/64"	.391" - .375"
E16-026(C)	13/32"	.406" - .391"

METRIC-COOLANT-THRU		
Part Number	Size	Collapse Range

-	1.0mm	-
-	1.5mm	-
-	2.0mm	-
-	2.5mm	-
-	3.0mm	-
-	3.5mm	-
E16-157(C)	4.0mm	4.0mm - 3.5mm
E16-177(C)	4.5mm	4.5mm - 4.0mm
E16-196(C)	5.0mm	5.0mm - 4.5mm
E16-216(C)	5.5mm	5.5mm - 5.0mm
E16-236(C)	6.0mm	6.0mm - 5.5mm
E16-255(C)	6.5mm	6.5mm - 6.0mm
E16-275(C)	7.0mm	7.0mm - 6.5mm
E16-295(C)	7.5mm	7.5mm - 7.0mm
E16-314(C)	8.0mm	8.0mm - 7.5mm
E16-334(C)	8.5mm	8.5mm - 8.0mm
E16-354(C)	9.0mm	9.0mm - 8.5mm
E16-374(C)	9.5mm	9.5mm - 9.0mm
E16-393(C)	10.0mm	10.0mm - 9.5mm

### ER16 Collets Sets

E16-12S	12 Piece Set 1/32" - 13/32" by 32nds
E16-09S	9 Piece Set 1.0mm - 10.0mm by 1mm

### ER16 Coolant Collets Sets

E16-11S(C)	11 Piece Set 3/32" - 13/32" by 32nds
E16-13S(C)	13 Piece Set 4.0mm - 10.0mm by 0.5mm

See dimensional data for ER16 Collets on page 31.

# ER20 Collets



Size range: 1/16" - 1/2"

INCH		
Part Number	Size	Collapse Range
E20-004	1/16"	.063" - .047"
E20-006	3/32"	.094" - .078"
E20-008	1/8"	.125" - .109"
E20-010	5/32"	.156" - .125"
-	11/64"	-
E20-012	3/16"	.187" - .156"
-	13/64"	-
E20-014	7/32"	.219" - .187"
-	15/64"	-
E20-016	1/4"	.250" - .219"
-	17/64"	-
E20-018	9/32"	.281" - .250"
-	19/64"	-
E20-020	5/16"	.312" - .281"
-	21/64"	-
E20-022	11/32"	.344" - .312"
-	23/64"	-
E20-024	3/8"	.375" - .344"
-	25/64"	-
E20-026	13/32"	.406" - .375"
-	27/64"	-
E20-028	7/16"	.437" - .406"
-	29/64"	-
E20-030	15/32"	.469" - .437"
-	31/64"	-
E20-032	1/2"	.500" - .469"



Size range: 5/32" - 1/2"

INCH-COOLANT-THRU		
Part Number	Size	Collapse Range
-	1/16"	-
-	3/32"	-
-	1/8"	-
E20-010(C)	5/32"	.156" - .152"
E20-011(C)	11/64"	.172" - .167"
E20-012(C)	3/16"	.187" - .183
E20-013(C)	13/64"	.203" - .199"
E20-014(C)	7/32"	.219" - .203"
E20-015(C)	15/64"	.234" - .219"
E20-016(C)	1/4"	.250" - .234"
E20-017(C)	17/64"	.266" - .250"
E20-018(C)	9/32"	.281" - .266"
E20-019(C)	19/64"	.297" - .281"
E20-020(C)	5/16"	.312" - .297"
E20-021(C)	21/64"	.328" - .312"
E20-022(C)	11/32"	.344" - .328"
E20-023(C)	23/64"	.359" - .344"
E20-024(C)	3/8"	.375" - .359"
E20-025(C)	25/64"	.391" - .375"
E20-026(C)	13/32"	.406" - .391"
E20-027(C)	27/64"	.422" - .406"
E20-028(C)	7/16"	.437" - .422"
E20-029(C)	29/64"	.453" - .437"
E20-030(C)	15/32"	.469" - .453"
E20-031(C)	31/64"	.484" - .469"
E20-032(C)	1/2"	.500" - .484"

Our patented Coolant Collets are designed for use with cylindrical shank tools (no flats). Cutting tool should be inserted the full length of the collet. If these conditions are not met, coolant leakage may result. Seals up to maximum coolant pressure of 1000PSI.

Size range: 2.0mm - 13.0mm  
(0.039"-0.511")

METRIC		
Part Number	Size	Collapse Range
E20-078	2.0mm	2.0-1.0mm
E20-118	3.0mm	3.0-2.5mm
E20-137	3.5mm	3.5-2.5mm
E20-157	4.0mm	4.0-3.5mm
-	4.5mm	-
E20-196	5.0mm	5.0-4.0mm
-	5.5mm	-
E20-236	6.0mm	6.0-5.0mm
-	6.5mm	-
E20-275	7.0mm	7.0-6.0mm
-	7.5mm	-
E20-314	8.0mm	8.0-7.0mm
-	8.5mm	-
E20-354	9.0mm	9.0-8.0mm
-	9.5mm	-
E20-393	10.0mm	10.0-9.0mm
-	10.5mm	-
E20-433	11.0mm	11.0-10.0mm
E20-452	11.5mm	11.5-11.0mm
E20-472	12.0mm	12.0-11.0mm
-	12.5mm	-
E20-511	13.0mm	13.0-12.0mm

Size range: 5.0mm-13.0mm  
(0.196"-0.511")

METRIC-COOLANT-THRU		
Part Number	Size	Collapse Range
-	2.0mm	-
-	3.0mm	-
-	3.5mm	-
-	4.0mm	-
-	4.5mm	-
E20-196(C)	5.0mm	5.0mm - 4.5mm
E20-216(C)	5.5mm	5.5mm - 5.0mm
E20-236(C)	6.0mm	6.0mm - 5.5mm
E20-255(C)	6.5mm	6.5mm - 6.0mm
E20-275(C)	7.0mm	7.0mm - 6.5mm
E20-295(C)	7.5mm	7.5mm - 7.0mm
E20-314(C)	8.0mm	8.0mm - 7.5mm
E20-334(C)	8.5mm	8.5mm - 8.0mm
E20-354(C)	9.0mm	9.0mm - 8.5mm
E20-374(C)	9.5mm	9.5mm - 9.0mm
E20-393(C)	10.0mm	10.0mm - 9.5mm
E20-413(C)	10.5mm	10.5mm - 10.0mm
E20-433(C)	11.0mm	11.0mm - 10.5mm
E20-452(C)	11.5mm	11.5mm - 11.0mm
E20-472(C)	12.0mm	12.0mm - 11.5mm
E20-492(C)	12.5mm	12.5mm - 12.0mm
E20-511(C)	13.0mm	13.0mm - 12.5mm

## ER20 Collets Sets

E20-15S	15 Piece Set 1/16" - 1/2" by 32nds
E20-11S	11 Piece Set 2.0mm - 13.0mm by 1mm

## ER20 Coolant Collets Sets

E20-12S(C)	12 Piece Set 5/32" - 1/2" by 32nds
E20-17S(C)	17 Piece Set 5.0mm - 13.0mm by 0.5mm

See dimensional data for ER20 Collets on page 31.

## ER25 Collets



Size range: 1/16" - 5/8"

INCH		
Part Number	Size	Collapse Range
E25-004	1/16"	.063" - .047"
E25-006	3/32"	.094" - .078"
E25-008	1/8"	.125" - .109"
E25-010	5/32"	.156" - .125"
E25-012	3/16"	.187" - .156"
E25-014	7/32"	.218" - .187"
-	15/64"	-
E25-016	1/4"	.250" - .219"
-	17/64"	-
E25-018	9/32"	.281" - .250"
-	19/64"	-
E25-020	5/16"	.312" - .281"
-	21/64"	-
E25-022	11/32"	.344" - .312"
-	23/64"	-
E25-024	3/8"	.375" - .344"
-	25/64"	-
E25-026	13/32"	.406" - .375"
-	27/64"	-
E25-028	7/16"	.437" - .406"
-	29/64"	-
E25-030	15/32"	.469" - .437"
-	31/64"	-
E25-032	1/2"	.500" - .469"
-	33/64"	-
E25-034	17/32"	.531" - .500"
-	35/64"	-
E25-036	9/16"	.563" - .531"
-	37/64"	-
E25-038	19/32"	.594" - .563"
-	39/64"	-
E25-040	5/8"	.625" - .594"

Size range: 2.0mm - 16.0mm  
(0.039"-0.629")

METRIC		
Part Number	Size	Collapse Range
E25-078	2.0mm	2.0-1.0mm
E25-118	3.0mm	3.0-2.0mm
E25-137	3.5mm	3.5-2.5mm
E25-157	4.0mm	4.0-3.0mm
E25-196	5.0mm	5.0-4.0mm
E25-236	6.0mm	6.0-5.0mm
E25-275	7.0mm	7.0-6.0mm
E25-314	8.0mm	8.0-7.0mm
E25-354	9.0mm	9.0-8.0 mm
E25-393	10.0mm	10.0-9.0mm
E25-433	11.0mm	11.0-10.0mm
E25-452	11.5mm	11.5-11.0mm
E25-472	12.0mm	12.0-11.0mm
E25-511	13.0mm	13.0-12.0mm
E25-551	14.0mm	14.0-13.0mm
E25-590	15.0mm	15.0-14.0mm
E25-629	16.0mm	16.0-15.0mm



Size range: 7/32" - 5/8"

INCH-COOLANT-THRU		
Part Number	Size	Collapse Range
-	1/16"	-
-	3/32"	-
-	1/8"	-
-	5/32"	-
-	3/16"	-
E25-014(C)	7/32"	.219" - .203"
E25-015(C)	15/64"	.234" - .219"
E25-016(C)	1/4"	.250" - .234"
E25-017(C)	17/64"	.266" - .250"
E25-018(C)	9/32"	.281" - .266"
E25-019(C)	19/64"	.297" - .281"
E25-020(C)	5/16"	.312" - .297"
E25-021(C)	21/64"	.328" - .312"
E25-022(C)	11/32"	.344" - .328"
E25-023(C)	23/64"	.359" - .344"
E25-024(C)	3/8"	.375" - .359"
E25-025(C)	25/64"	.391" - .375"
E25-026(C)	13/32"	.406" - .391"
E25-027(C)	27/64"	.422" - .406"
E25-028(C)	7/16"	.437" - .422"
E25-029(C)	29/64"	.453" - .437"
E25-030(C)	15/32"	.469" - .453"
E25-031(C)	31/64"	.484" - .469"
E25-032(C)	1/2"	.500" - .484"
E25-033(C)	33/64"	.516" - .500"
E25-034(C)	17/32"	.531" - .516"
E25-035(C)	35/64"	.547" - .531"
E25-036(C)	9/16"	.563" - .547"
E25-037(C)	37/64"	.578" - .563"
E25-038(C)	19/32"	.594" - .578"
E25-039(C)	39/64"	.609" - .594"
E25-040(C)	5/8"	.625" - .609"

Our patented Coolant Collets are designed for use with cylindrical shank tools (no flats). Cutting tool should be inserted the full length of the collet. If these conditions are not met, coolant leakage may result. Seals up to maximum coolant pressure of 1000PSI.

Size range: 6.0mm-16.0mm  
(0.236"-0.629")

METRIC-COOLANT-THRU		
Part Number	Size	Collapse Range
-	2.0mm	-
-	3.0mm	-
-	3.5mm	-
-	4.0mm	-
-	5.0mm	-
E25-236(C)	6.0mm	6.0mm - 5.5mm
E25-255(C)	6.5mm	6.5mm - 6.0mm
E25-275(C)	7.0mm	7.0mm - 6.5mm
E25-295(C)	7.5mm	7.5mm - 7.0mm
E25-314(C)	8.0mm	8.0mm - 7.5mm
E25-334(C)	8.5mm	8.5mm - 8.0mm
E25-354(C)	9.0mm	9.0mm - 8.5mm
E25-374(C)	9.5mm	9.5mm - 9.0mm
E25-393(C)	10.0mm	10.0mm - 9.5mm
E25-413(C)	10.5mm	10.5mm - 10.0mm
E25-433(C)	11.0mm	11.0mm - 10.5mm
E25-452(C)	11.5mm	11.5mm - 11.0mm
E25-472(C)	12.0mm	12.0mm - 11.5mm
E25-492(C)	12.5mm	12.5mm - 12.0mm
E25-511(C)	13.0mm	13.0mm - 12.5mm
E25-531(C)	13.5mm	13.5mm - 13.0mm
E25-551(C)	14.0mm	14.0mm - 13.5mm
E25-570(C)	14.5mm	14.5mm - 14.0mm
E25-590(C)	15.0mm	15.0mm - 14.5mm
E25-610(C)	15.5mm	15.5mm - 15.0mm
E25-629(C)	16.0mm	16.0mm - 15.5mm

### ER25 Collets Sets

E25-19S	19 Piece Set 1/16" - 5/8" by 32nds
E25-14S	14 Piece Set 2.0mm - 16.0mm by 1mm

### ER25 Coolant Collets Sets

E25-13S(C)	13 Piece Set 1/4" - 5/8" by 32nds
E25-21S(C)	21 Piece Set 6.0mm - 16.0mm by 0.5mm

See dimensional data for ER25 Collets on page 31.

# ER32 Collets



Size range: 1/8" - 25/32"



Size range: 1/4" - 25/32"

Our patented Coolant Collets are designed for use with cylindrical shank tools (no flats). Cutting tool should be inserted the full length of the collet. If these conditions are not met, coolant leakage may result. Seals up to maximum coolant pressure of 1000PSI.

Size range: 10.0mm-20.0mm  
(0.276"-0.787")

INCH		
Part Number	Size	Collapse Range
-	-	-
E32-008	1/8"	.125" - .109"
E32-010	5/32"	.156" - .125"
E32-012	3/16"	.187" - .156"
E32-014	7/32"	.219" - .187"
E32-016	1/4"	.250" - .219"
-	17/64"	-
E32-018	9/32"	.281" - .250"
-	19/64"	-
E32-020	5/16"	.312" - .281"
-	21/64"	-
E32-022	11/32"	.344" - .312"
-	23/64"	-
E32-024	3/8"	.375" - .344"
-	25/64"	-
E32-026	13/32"	.406" - .375"
-	27/64"	-
E32-028	7/16"	.437" - .406"
-	29/64"	-
E32-030	15/32"	.469" - .437"
-	31/64"	-
E32-032	1/2"	.500" - .469"
-	33/64"	-
E32-034	17/32"	.531" - .500"
-	35/64"	-
E32-036	9/16"	.594" - .563"
-	37/64"	-
E32-038	19/32"	.594" - .562"
-	39/64"	-
E32-040	5/8"	.625" - .594"
-	41/64"	-
E32-042	21/32"	.688" - .656"
-	43/64"	-
E32-044	11/16"	.719" - .688"
-	45/64"	-
E32-046	23/32"	.719" - .687"
-	47/64"	-
E32-048	3/4"	.750" - .719"
-	49/64"	-
E32-050	25/32"	.781" - .750"

METRIC		
Part Number	Size	Collapse Range
E32-118	3.0mm	3.0-2.0mm
E32-137	3.5mm	3.5-2.5mm
E32-157	4.0mm	4.0-3.0mm
E32-196	5.0mm	5.0-4.0mm
E32-236	6.0mm	6.0-5.0mm
E32-275	7.0mm	7.0-6.0mm
E32-314	8.0mm	8.0-7.0mm
E32-354	9.0mm	9.0-8.0mm
E32-393	10.0mm	10.0-9.0mm
E32-433	11.0mm	11.0-10.0mm
E32-452	11.5mm	11.5-10.5mm
E32-472	12.0mm	12.0-11.0mm
E32-511	13.0mm	13.0-12.0mm
E32-551	14.0mm	14.0-13.0mm
E32-590	15.0mm	15.0-14.0mm
E32-629	16.0mm	16.0-15.0mm
E32-669	17.0mm	17.0-16.0mm
E32-708	18.0mm	18.0-17.0mm
E32-748	19.0mm	19.0-18.0mm
E32-767	19.5mm	19.5-18.5mm
E32-787	20.0mm	20.0-19.0mm

INCH-COOLANT-THRU		
Part Number	Size	Collapse Range
-	-	-
-	1/8"	-
-	5/32"	-
-	3/6"	-
-	7/32"	-
E32-016(C)	1/4"	.250" - .234"
E32-017(C)	17/64"	.266" - .250"
E32-018(C)	9/32"	.281" - .266"
E32-019(C)	19/64"	.297" - .281"
E32-020(C)	5/16"	.312" - .297"
E32-021(C)	21/64"	.328" - .312"
E32-022(C)	11/32"	.344" - .328"
E32-023(C)	23/64"	.359" - .344"
E32-024(C)	3/8"	.375" - .359"
E32-025(C)	25/64"	.391" - .375"
E32-026(C)	13/32"	.406" - .391"
E32-027(C)	27/64"	.422" - .406"
E32-028(C)	7/16"	.437" - .422"
E32-029(C)	29/64"	.453" - .437"
E32-030(C)	15/32"	.469" - .453"
E32-031(C)	31/64"	.484" - .469"
E32-032(C)	1/2"	.500" - .484"
E32-033(C)	33/64"	.516" - .500"
E32-034(C)	17/32"	.531" - .516"
E32-035(C)	35/64"	.547" - .531"
E32-036(C)	9/16"	.563" - .547"
E32-037(C)	37/64"	.578" - .563"
E32-038(C)	19/32"	.594" - .578"
E32-039(C)	39/64"	.609" - .594"
E32-040(C)	5/8"	.625" - .609"
E32-041(C)	41/64"	.641" - .625"
E32-042(C)	21/32"	.656" - .641"
E32-043(C)	43/64"	.672" - .656"
E32-044(C)	11/16"	.688" - .672"
E32-045(C)	45/64"	.703" - .688"
E32-046(C)	23/32"	.719" - .703"
E32-047(C)	47/64"	.734" - .719"
E32-048(C)	3/4"	.750" - .734"
E32-049(C)	49/64"	.766" - .750"
E32-050(C)	25/32"	.781" - .766"

METRIC-COOLANT-THRU		
Part Number	Size	Collapse Range
-	3.0mm	-
-	3.5mm	-
-	4.0mm	-
-	5.0mm	-
-	6.0mm	-
-	7.0mm	-
-	8.0mm	-
-	9.0mm	-
E32-393(C)	10.0mm	10.0mm - 9.5mm
E32-413(C)	10.5mm	10.5mm - 10.0mm
E32-433(C)	11.0mm	11.0mm - 10.5mm
E32-452(C)	11.5mm	11.5mm - 11.0mm
E32-472(C)	12.0mm	12.0mm - 11.5mm
E32-492(C)	12.5mm	12.5mm - 12.4mm
E32-511(C)	13.0mm	13.0mm - 12.9mm
E32-531(C)	13.5mm	13.5mm - 13.0mm
E32-551(C)	14.0mm	14.0mm - 13.5mm
E32-570(C)	14.5mm	14.5mm - 14.4mm
E32-590(C)	15.0mm	15.0mm - 14.9mm
E32-610(C)	15.5mm	15.5mm - 15.4mm
E32-629(C)	16.0mm	16.0mm - 15.5mm
E32-649(C)	16.5mm	16.5mm - 16.0mm
E32-669(C)	17.0mm	17.0mm - 16.5mm
E32-688(C)	17.5mm	17.5mm - 17.0mm
E32-708(C)	18.0mm	18.0mm - 17.5mm
E32-728(C)	18.5mm	18.5mm - 18.0mm
E32-748(C)	19.0mm	19.0mm - 18.5mm
E32-767(C)	19.5mm	19.5mm - 19.0mm
E32-787(C)	20.0mm	20.0mm - 19.5mm

## ER32 Collets Sets

E32-21S	21 Piece Set	1/8" - 3/4" by 32nds
E32-18S	18 Piece Set	2.0mm - 20.0mm by 1.0mm

## ER32 Coolant Collets Sets

E32-17S(C)	17 Piece Set	1/4" - 3/4" by 32nds
E32-21S(C)	21 Piece Set	10.0mm - 20.0mm by 0.5mm

See dimensional data for ER32 Collets on page 31.

## ER40 Collets



Size range: 5/32" - 1"



Size range: 5/16" - 5/8"

Our patented Coolant Collets are designed for use with cylindrical shank tools (no flats). Cutting tool should be inserted the full length of the collet. If these conditions are not met, coolant leakage may result. Seals up to maximum coolant pressure of 1000PSI.

Size range: 10.0mm - 26.0mm  
(0.374" - 1.023")

INCH		
Part Number	Size	Collapse Range
E40-010	5/32"	.156" - .125"
E40-012	3/16"	.187" - .156"
E40-014	7/32"	.219" - .187"
E40-016	1/4"	.250" - .219"
E40-018	9/32"	.281" - .250"
E40-020	5/16"	.312" - .281"
E40-022	11/32"	.344" - .312"
E40-024	3/8"	.375" - .344"
E40-026	13/32"	.406" - .375"
E40-028	7/16"	.437" - .406"
E40-030	15/32"	.469" - .437"
E40-032	1/2"	.500" - .469"
E40-034	17/32"	.531" - .500"
E40-036	9/16"	.563" - .531"
E40-038	19/32"	.594" - .563"
E40-040	5/8"	.625" - .594"
E40-042	21/32"	.656" - .625"
E40-044	11/16"	.688" - .656"
E40-046	23/32"	.719" - .688"
E40-048	3/4"	.750" - .719"
E40-050	25/32"	.781" - .750"
E40-052	13/16"	.813" - .781"
E40-054	27/32"	.844" - .813"
E40-056	7/8"	.875" - .844"
E40-058	29/32"	.906" - .875"
E40-060	15/16"	.938" - .906"
E40-062	31/32"	.969" - .938"
E40-064	1"	1" - .969"

METRIC		
Part Number	Size	Collapse Range
E40-157	4.0mm	4.0-3.0mm
E40-196	5.0mm	5.0-4.0mm
E40-236	6.0mm	6.0-5.0mm
E40-275	7.0mm	7.0-6.0mm
E40-314	8.0mm	8.0-7.0mm
E40-354	9.0mm	9.0-8.0 mm
E40-393	10.0mm	10.0-9.0mm
E40-433	11.0mm	11.0-10.0mm
E40-452	11.5mm	11.5-10.5mm
E40-472	12.0mm	12.0-11.0mm
E40-511	13.0mm	13.0-12.0mm
E40-551	14.0mm	14.0-13.0mm
E40-590	15.0mm	15.0-14.0mm
E40-629	16.0mm	16.0-15.0mm
E40-669	17.0mm	17.0-16.0mm
E40-708	18.0mm	18.0-17.0mm
E40-748	19.0mm	19.0-18.0mm
E40-767	19.5mm	19.5-18.5mm
E40-787	20.0mm	20.0-19.0mm
E40-826	21.0mm	21.0-20.0mm
E40-866	22.0mm	22.0-21.0mm
E40-905	23.0mm	23.0-22.0mm
E40-944	24.0mm	24.0-23.0mm
E40-984	25.0mm	25.0-24.0mm
E40-1023	26.0mm	26.0-25.0mm

INCH-COOLANT-THRU		
Part Number	Size	Collapse Range
-	-	-
-	-	-
-	-	-
-	-	-
-	-	-
E40-020(C)	5/16"	.312" - .297"
-	-	-
E40-024(C)	3/8"	.375" - .359"
-	-	-
E40-028(C)	7/16"	.437" - .422"
-	-	-
E40-032(C)	1/2"	.500" - .484"
-	-	-
E40-036(C)	9/16"	.563" - .547"
-	-	-
E40-040(C)	5/8"	.625" - .609"

METRIC-COOLANT-THRU		
Part Number	Size	Collapse Range
-	4.0mm	-
-	5.0mm	-
-	6.0mm	-
-	7.0mm	-
-	8.0mm	-
-	9.0mm	-
E40-393(C)	10.0mm	10.0mm - 9.5mm
E40-413(C)	10.5mm	10.5mm - 10.0mm
E40-433(C)	11.0mm	11.0mm - 10.5mm
E40-452(C)	11.5mm	11.5mm - 11.0mm
E40-472(C)	12.0mm	12.0mm - 11.5mm
E40-492(C)	12.5mm	12.5mm - 12.0mm
E40-511(C)	13.0mm	13.0mm - 12.5mm
E40-531(C)	13.5mm	13.5mm - 13.0mm
E40-551(C)	14.0mm	14.0mm - 13.5mm
E40-570(C)	14.5mm	14.5mm - 14.0mm
E40-590(C)	15.0mm	15.0mm - 14.5mm
E40-610(C)	15.5mm	15.5mm - 15.0mm
E40-629(C)	16.0mm	16.0mm - 15.5mm
E40-649(C)	16.5mm	16.5mm - 16.0mm
E40-669(C)	17.0mm	17.0mm - 16.5mm
E40-688(C)	17.5mm	17.5mm - 17.0mm
E40-708(C)	18.0mm	18.0mm - 17.5mm
E40-728(C)	18.5mm	18.5mm - 18.0mm
E40-748(C)	19.0mm	19.0mm - 18.5mm
E40-767(C)	19.5mm	19.5mm - 19.0mm
E40-787(C)	20.0mm	20.0mm - 19.5mm
E40-807(C)	20.5mm	20.5mm - 20.0mm
E40-826(C)	21.0mm	21.0mm - 20.5mm
E40-846(C)	21.5mm	21.5mm - 21.0mm
E40-866(C)	22.0mm	22.0mm - 21.5mm
E40-885(C)	22.5mm	22.5mm - 22.0mm
E40-905(C)	23.0mm	23.0mm - 22.5mm
E40-925(C)	23.5mm	23.5mm - 23.0mm
E40-944(C)	24.0mm	24.0mm - 23.5mm
E40-964(C)	24.5mm	24.5mm - 24.0mm
E40-984(C)	25.0mm	25.0mm - 24.5mm
E40-1003(C)	25.5mm	25.5mm - 25.0mm
E40-1023(C)	26.0mm	26.0mm - 25.0mm

### ER40 Collets Sets

E40-25S	25 Piece Set	1/4" - 1" by 32nds
E40-23S	23 Piece Set	4.0mm - 26.0mm by 1.0mm

### ER40 Coolant Collets Sets

E40-33S(C)	33 Piece Set	10.0mm - 26.0mm by 0.5mm
------------	--------------	--------------------------

See dimensional data for ER40 Collets on page 31.

# ER Tap Collets

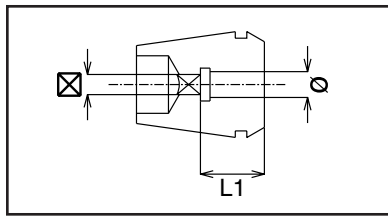

ER Tap Collets feature a unique design that incorporates an internal square drive with our popular ER Series Collets. The square drive matches the tap square, providing a tight fit for all rigid tapping applications.

Part Number	ER Series	Tap Inch Size	Tap Metric Size	L1 (mm)	Ø	⊠
ET16-168	ER16	#8, 5/32"	M4	15	0.168	0.131
ET16-194	ER16	#10, 3/16"	M4.5, M5	15	0.194	0.152
ET16-220	ER16	#12, 7/32"	-	15	0.220	0.165
ET16-255	ER16	#14, 1/4"	M6, M6.5	22	0.255	0.191
ET20-168	ER20	#8, 5/32"	M4	15	0.168	0.131
ET20-194	ER20	#10, 3/16"	M4.5, M5	15	0.194	0.152
ET20-220	ER20	#12, 7/32"	-	15	0.220	0.165
ET20-255	ER20	#14, 1/4"	M6, M6.5	20	0.255	0.191
ET20-318	ER20	5/16"	M7, M6.5	20	0.318	0.238
ET20-323	ER20	7/16"	-	20	0.323	0.242
ET20-367	ER20	1/2"	M12, M12.5	25	0.367	0.275
ET20-381	ER20	3/8"	M10	20	0.381	0.286
ET25-168	ER25	#8, 5/32"	M4	15	0.168	0.131
ET25-194	ER25	#10, 3/16"	M4.5, M5	15	0.194	0.152
ET25-220	ER25	#12, 7/32"	-	15	0.220	0.165
ET25-255	ER25	#14, 1/4"	M6, M6.5	20	0.255	0.191
ET25-318	ER25	5/16"	M7, M6.5	20	0.318	0.238
ET25-323	ER25	7/16"	-	20	0.323	0.242
ET25-367	ER25	1/2"	M12, M12.5	25	0.367	0.275
ET25-381	ER25	3/8"	M10	20	0.381	0.286
ET25-429	ER25	9/16"	M14	25	0.429	0.322
ET25-437	ER25	1/8" NPT(L)	-	18	0.437	0.328
ET25-480	ER25	5/8"	M16	25	0.480	0.360
ET32-168	ER32	#8, 5/32"	M4	15	0.168	0.131
ET32-194	ER32	#10, 3/16"	M4.5, M5	15	0.194	0.152
ET32-220	ER32	#12, 7/32"	-	15	0.220	0.165
ET32-255	ER32	#14, 1/4"	M6, M6.5	20	0.255	0.191
ET32-318	ER32	5/16"	M7, M6.5	20	0.318	0.238
ET32-323	ER32	7/16"	-	20	0.323	0.242
ET32-367	ER32	1/2"	M12, M12.5	25	0.367	0.275
ET32-381	ER32	3/8"	M10	20	0.381	0.286
ET32-429	ER32	9/16"	M14	25	0.429	0.322
ET32-437	ER32	1/8" NPT	-	18	0.437	0.328
ET32-480	ER32	5/8"	M16	25	0.480	0.360
ET32-542	ER32	11/16"	M18	30	0.542	0.406
ET32-562	ER32	1/4" NPT	-	18	0.562	0.421
ET32-590	ER32	3/4"	-	30	0.590	0.422
ET32-652	ER32	13/16"	M20	30	0.652	0.489
ET40-255	ER40	#14, 1/4"	M6, M6.5	25	0.255	0.191
ET40-318	ER40	5/16"	M7, M6.5	25	0.318	0.238
ET40-323	ER40	7/16"	-	25	0.323	0.242
ET40-367	ER40	1/2"	M12, M12.5	25	0.367	0.275
ET40-381	ER40	3/8"	M10	25	0.381	0.286
ET40-429	ER40	9/16"	M14	25	0.429	0.322
ET40-437	ER40	1/8" NPT	-	18	0.437	0.328
ET40-480	ER40	5/8"	M16	25	0.480	0.360
ET40-542	ER40	11/16"	M18	30	0.542	0.406
ET40-562	ER40	1/4" NPT	-	18	0.562	0.421
ET40-590	ER40	3/4"	-	30	0.590	0.422
ET40-652	ER40	13/16"	M20	30	0.652	0.489
ET40-687	ER40	1/2" NPT	-	18	0.687	0.515
ET40-697	ER40	7/8"	M22	30	0.697	0.523
ET40-700	ER40	3/8" NPT	-	18	0.700	0.531
ET40-760	ER40	15/16"	M24	35	0.760	0.570
ET40-800	ER40	1"	M25	35	0.800	0.600



## ER Tap Coolant Collets

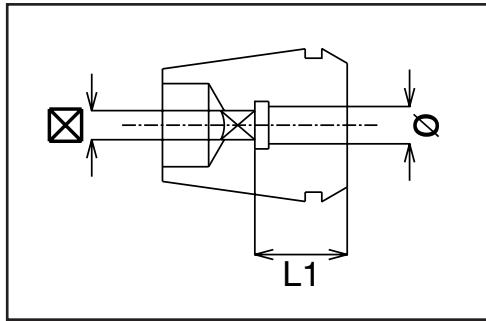

Lyndex-Nikken has now combined the versatility of our ER Tapping Collets with the popularity of our Coolant Collets to create our patented ER Coolant Tap Collets.

Part Number	ER Series	Tap Inch Size	Tap Metric Size	L1 (mm)	Ø	☒
ET16-255(C)	ER16	#14, 1/4"	M6, M6.5	22	0.255	0.191
ET16-318(C)	ER16	5/16"	M7, M6.5	22	0.318	0.238
ET20-255(C)	ER20	#14, 1/4"	M6, M6.5	25	0.255	0.191
ET20-318(C)	ER20	5/16"	M7, M6.5	25	0.318	0.238
ET20-323(C)	ER20	7/16"	-	25	0.323	0.242
ET20-367(C)	ER20	1/2"	M12, M12.5	25	0.367	0.275
ET20-381(C)	ER20	3/8"	M10	25	0.381	0.286
ET25-318(C)	ER25	5/16"	M7, M6.5	25	0.255	0.238
ET25-323(C)	ER25	7/16"	-	25	0.318	0.242
ET25-367(C)	ER25	1/2"	M12, M12.5	25	0.323	0.275
ET25-381(C)	ER25	3/8"	M10	27	0.367	0.286
ET25-429(C)	ER25	9/16"	M14	25	0.381	0.322
ET25-480(C)	ER25	5/8"	M16	30	0.429	0.360
ET32-255(C)	ER32	#14, 1/4"	M6, M6.5	30	0.48	0.191
ET32-318(C)	ER32	5/16"	M7, M6.5	25	0.255	0.238
ET32-323(C)	ER32	7/16"	-	25	0.318	0.242
ET32-367(C)	ER32	1/2"	M12, M12.5	25	0.323	0.275
ET32-381(C)	ER32	3/8"	M10	27	0.367	0.286
ET32-429(C)	ER32	9/16"	M14	25	0.381	0.322
ET32-480(C)	ER32	5/8"	M16	30	0.429	0.360
ET32-542(C)	ER32	11/16"	M18	30	0.48	0.406
ET32-590(C)	ER32	3/4"	-	35	0.542	0.422
ET32-652(C)	ER32	13/16"	M20	35	0.59	0.489
ET40-323(C)	ER40	7/16"	-	35	0.652	0.242
ET40-367(C)	ER40	1/2"	M12, M12.5	25	0.323	0.275
ET40-381(C)	ER40	3/8"	M10	27	0.367	0.286
ET40-429(C)	ER40	9/16"	M14	25	0.381	0.322
ET40-480(C)	ER40	5/8"	M16	30	0.429	0.360
ET40-542(C)	ER40	11/16"	M18	30	0.48	0.406
ET40-590(C)	ER40	3/4"	-	35	0.542	0.422
ET40-652(C)	ER40	13/16"	M20	35	0.590	0.489
ET40-697(C)	ER40	7/8"	M22	35	0.652	0.523
ET40-760(C)	ER40	15/16"	M24	38	0.697	0.570
ET40-800(C)	ER40	1"	M25	38	0.760	0.600

Note: Seals up to maximum coolant pressure of 1000 PSI.

## ER Accessories

### ER Collet Rack

Part Number	Description
RACK-ER11/SK6	ER11 collet rack, 35 collets capacity
RACK-ER16/SK10	ER16 collet rack, 24 collets capacity
RACK-ER20/1TAP	ER20 collet rack, 24 collets capacity
RACK-180DA/SK16/ER25	ER25 collet rack, 30 collets capacity
RACK-ER32/2TAP	ER32 collet rack, 24 collets capacity
RACK-ER40	ER40 collet rack, 24 collets capacity



### Replacement Nut for ER Collet Chuck

Part Number	Description
08-NANUT	ER8 Complete Nut
E11-NUT	ER11 Complete (Hex) Nut
E16-NUT	ER16 Complete Nut
O16-NUT	ER16 Complete Hex Nut
E20-NUT	ER20 Complete Nut
E25-NUT	ER25 Complete Nut
E32-NUT	ER32 Complete Nut
E32-NUT-ST	ER32 Nut (Short) for C40S7-0032-1.10
E40-NUT	ER40 Complete Nut
E40-NUT-ST	ER40 Nut (Short) for C50S7-0040-1.10



### Replacement Nut Parts for ER Collet Chuck

Part Number	Description
ER16-1	ER16 Nut Bearing/Spacer Set
ER20-1	ER20 Nut Bearing/Spacer Set
ER25-1	ER25 Nut Bearing/Spacer Set
ER32-1	ER32 Nut Bearing/Spacer Set
ER40-1	ER40 Nut Bearing/Spacer Set



### Spanner Wrench for ER Collet Chuck Nut

Part Number	Description
08-NASPAN	wrench for ER8 Chuck Nut
011-HEX	wrench for ER11 Chuck Nut
016-SPAN	wrench for ER16 Chuck Nut
020-SPAN	wrench for ER20 Chuck Nut
025-SPAN	wrench for ER25 Chuck Nut
032-SPAN	wrench for ER32 Chuck Nut
040-SPAN	wrench for ER40 Chuck Nut



## ER Accessories

### Torque Wrench and Attachment for ER Collet Chuck Nut

Part Number	Description
TQW-025	Torque wrench for ER8 Chuck Nut
TQW-150	Torque wrench for ER11/16/20/25/32/40 Chuck Nut
TQW-ER08	ER8 Attachment for TQW-025 torque wrench
TQW-ER11(17)	ER11 Attachment for TQW-150 torque wrench
TQW-ER16(32)	ER16 Attachment for TQW-150 torque wrench
TQW-ER20(32)	ER20 Attachment for TQW-150 torque wrench
TQW-ER25(43)	ER25 Attachment for TQW-150 torque wrench
TQW-ER32(50)	ER32 Attachment for TQW-150 torque wrench
TQW-ER40(63)	ER40 Attachment for TQW-150 torque wrench



See the torque wrenches specifications and details on page 222.

### Replacement Back Up Screws for ER Collet Chuck

Part Number	Description
ER8-3	ER8 Backup Screws
ER8-3 (C)	ER8 Coolant-thru Backup Screws
ER11-3	ER11 Backup Screws*
ER11-3 (C)	ER11 Coolant-thru Backup Screws*
ER16-3	ER16 Backup Screws
ER16-3 (C)	ER16 Coolant-thru Backup Screws
ER20-3	ER20 Backup Screws
ER20-3 (C)	ER20 Coolant-thru Backup Screws
ER25-3	ER25 Backup Screws
ER25-3 (C)	ER25 Coolant-thru Backup Screws
ER32-3	ER32 Backup Screws
ER32-3 (C)	ER32 Coolant-thru Backup Screws
ER40-3	ER40 Backup Screws
ER40-3 (C)	ER40 Coolant-thru Backup Screws



\* ER11-3 can also be used with ER16 Collet Chuck Extension

### Coolant Tube Wrench for HSK holders

Part Number	Description
HSK63-WRENCH	Wrench for HSK63 Coolant Tube
HSK40-WRENCH	Wrench for HSK40 Coolant Tube
HSK100-WRENCH	Wrench for HSK100 Coolant Tube

Coolant tube wrenches are needed to remove or install coolant tubes in HSK toolholders.



### Coolant Tube for HSK holders





Part Number	Description
HSK63-TUBE	Coolant tube for HSK63 holder
HSK40-TUBE	Coolant tube for HSK40 holder
HSK100-TUBE	Coolant tube for HSK100 holder



# CAT TG Collet Chucks



- Ground surface for perpendicular contact between retention knob and holder
- AT3 or better taper
- Equipped with a left-hand-threaded stop screw and chuck nut
- Available in high-speed balanceable versions

Please note that the maximum RPM listed in our catalog may vary depending on the toolholder shank, weight, balanceability and the G rating.

-  **TIR:** < .0002 at collet face
-  **Speed:** up to 20,000 rpm
-  **Set-up:** quick and easy
-  **Coolant-thru:** thru-tool coolant

-  **Drilling**  
★★★★☆
-  **Milling**  
★★★★☆
-  **Reaming**  
★★★★☆

## CAT40

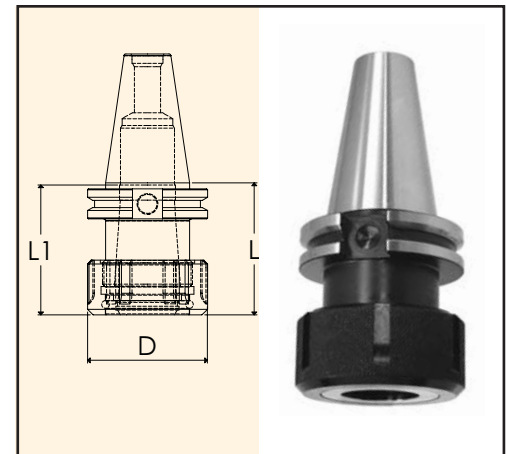

Part Number	Style	Collet Series	Collet Range 	Nut Wrench 	L	L1	D
C4007-0250-2.25	Standard	25TG	3/64-1/4"	25TG-HEX	2.25"	0.61"	0.75"
C4017-0250-4.00	Standard	25TG	3/64-1/4"	25TG-HEX	4.00"	0.61"	0.75"
C4007-0500-2.50	Standard	50TG	1/8-1/2"	50TG-SPAN	2.50"	1.30"	1.34"
C4017-0500-4.00	Standard	50TG	1/8-1/2"	50TG-SPAN	4.00"	1.30"	1.34"
C40S7-0750-2.50	Stubby	75TG	3/64-3/4"	75TG-SPAN	2.50"	1.61"	1.89"
C4007-0750-3.00	Standard	75TG	3/64-3/4"	75TG-SPAN	3.00"	1.61"	1.89"
C4017-0750-5.00	Standard	75TG	3/64-3/4"	75TG-SPAN	5.00"	1.61"	1.89"
C40S7-1000-2.75	Stubby	100TG	3/64-1"	100TG-SPAN	2.75"	2.13"	2.50"
C4007-1000-3.50	Standard	100TG	3/64-1"	100TG-SPAN	3.50"	2.13"	2.50"
C4017-1000-5.50	Standard	100TG	3/64-1"	100TG-SPAN	5.50"	2.13"	2.50"
C4007-1500-6.00	Standard	150TG	1/2-1-1/2"	150TG-SPAN	6.00"	2.88"	3.50"

TG Collet Chucks come with back-up screw.



Stubby

## CAT50

Part Number	Style	Collet Series	Collet Range 	Nut Wrench 	L	L1	D
C5007-0500-2.50	Standard	50TG	1/8-1/2"	50TG-SPAN	2.50"	1.30"	1.34"
C5017-0500-4.00	Standard	50TG	1/8-1/2"	50TG-SPAN	4.00"	1.30"	1.34"
C5007-0750-3.50	Standard	75TG	3/64-3/4"	75TG-SPAN	3.50"	1.61"	1.89"
C5017-0750-5.50	Standard	75TG	3/64-3/4"	75TG-SPAN	5.50"	1.61"	1.89"
C5007-1000-3.50	Standard	100TG	3/64-1"	100TG-SPAN	3.50"	2.13"	2.50"
C5017-1000-5.50	Standard	100TG	3/64-1"	100TG-SPAN	5.50"	2.13"	2.50"
C5027-1000-7.50	Standard	100TG	3/64-1"	100TG-SPAN	7.50"	2.13"	2.50"
C5037-1000-10.00	Standard	100TG	3/64-1"	100TG-SPAN	10.00"	2.13"	3.50"
C5007-1500-3.50	Standard	150TG	1/2-1-1/2"	150TG-SPAN	3.50"	2.88"	3.50"
C5017-1500-6.00	Standard	150TG	1/2-1-1/2"	150TG-SPAN	6.00"	2.88"	3.50"

TG Collet Chucks come with back-up screw.

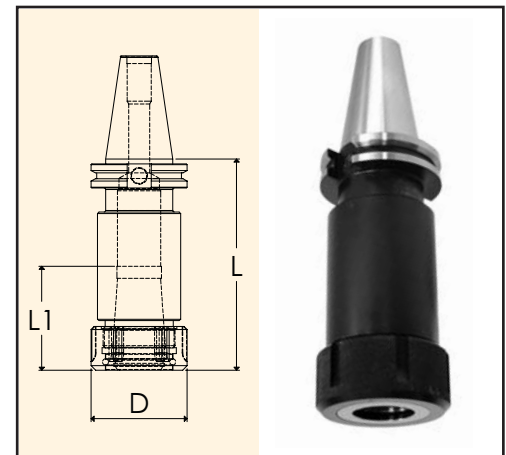

Standard

To use: first insert the collet into the chuck nut by squeezing the collet and pressing its face into the chuck nut's retaining ring until the collet's collar is fully seated. Then load the assembly into the chuck, insert a cutting tool, and tighten with the appropriate nut wrench to the recommended tightening torque.

To remove: simply squeeze the collet while pulling it from the chuck nut at an angle. Our handy 100TG or 150TG Collet Squeezers ease the removal of these larger collets.



When removing the back-up screw, TG Collet Chucks have coolant-thru capabilities. No disc, special nut or wrench required!  
See TG Coolant Collets on pages 62-64.

### Accessories:



**TG Collets**  
Pages 61-65



**TG Torque Wrench**  
Page 66





**TG Back Up Screw**  
Page 66



**TG Nut**  
Page 66



## CAT TG Collet Chucks

### CAT40 - DIN

Part Number	Style	Collet Series	Collet Range 	Nut Wrench 	L	L1	D
C4007-1000-3.50DIN	Standard	100TG	3/64-1"	100TG-SPAN	3.50"	2.32"	2.50"
C4007-1500-6.00DIN	Standard	150TG	1/2-1-1/2"	150TG-SPAN	6.00"	2.88"	3.50"

TG Collet Chucks come with back-up screw.

### CAT50 - DIN

Part Number	Style	Collet Series	Collet Range 	Nut Wrench 	L	L1	D
C5007-0750-3.50DIN	Standard	75TG	3/64-3/4"	75TG-SPAN	3.50"	1.61"	1.89"
C5017-0750-5.50DIN	Standard	75TG	3/64-3/4"	75TG-SPAN	5.50"	1.61"	1.89"
C5007-1000-3.50DIN	Standard	100TG	3/64-1"	100TG-SPAN	3.50"	2.13"	2.50"
C5017-1000-5.50DIN	Standard	100TG	3/64-1"	100TG-SPAN	5.50"	2.13"	2.50"
C5027-1000-7.50DIN	Standard	100TG	3/64-1"	100TG-SPAN	7.50"	2.12"	2.50"
C5007-1500-3.50DIN	Standard	150TG	1/2-1-1/2"	150TG-SPAN	3.50"	2.87"	3.50"
C5017-1500-6.00DIN	Standard	150TG	1/2-1-1/2"	150TG-SPAN	6.00"	3.94"	3.50"

TG Collet Chucks come with back-up screw.

Note: "DIN" designates suitability for coolant through the flange per DIN 69871 Form B specs.

## High-Speed Balanceable TG Collet Chucks

Balanceable TG Collet Chucks are available in CAT and BT taper styles. Part numbers are identical to standard TG Collet Chuck part numbers except that there is a "B" at the end. (Ex: C4007-0750-3.00B)

- 30 and 40 taper toolholders are prebalanced to G2.5 or better at 24,000 RPM
- 50 taper toolholders are prebalanced to G2.5 or better at 15,000 RPM
- Lyndex-Nikken uses a Patented Balancing Method which allows greater compensation necessary for high RPM applications
- hsBalance™ toolholders come with a printout of actual balance condition
- hsBalance™ toolholders need to be used with balance-qualified pull studs
- A balancing machine is required to balance or re-balance toolholders

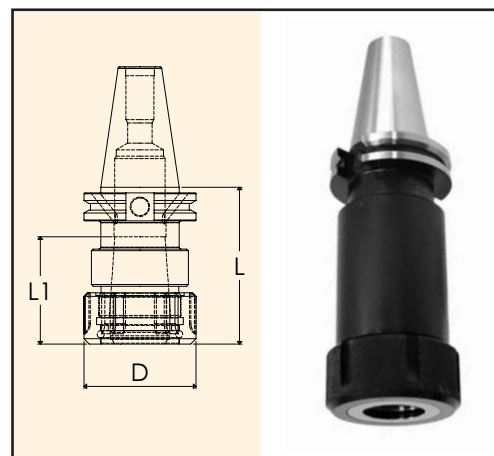

When removing the back-up screw, TG Collet Chucks have coolant-thru capabilities. No disc, special nut or wrench required! See TG Coolant Collets on pages 62-64.



**CT Taper hsBalance™  
100TG Collet Chuck**



**CT Taper hsBalance™ 100TG  
Collet Chuck - DIN**

### Accessories:



**TG Collets**  
Pages 61-65



**TG Torque Wrench**  
Page 66



**TG Back Up Screw**  
Page 66



**TG Nut**  
Page 66

# BT TG Collet Chucks

- Ground surface for perpendicular contact between retention knob and holder
- AT3 or better taper
- Equipped with a left-hand-threaded stop screw and chuck nut
- Available in high-speed balanceable versions

Please note that the maximum RPM listed in our catalog may vary depending on the toolholder shank, weight, balanceability and the G rating.



**TIR:** < .0002 at collet face



**Speed:** up to 20,000 rpm



**Set-up:** quick and easy



**Coolant-thru:** thru-tool coolant



**Drilling**  
★★★★☆



**Milling**  
★★★★☆



**Reaming**  
★★★★☆

## BT30/40/50

Part Number	Taper	Collet Series	Collet Range	Nut Wrench	L	L1	D
B3007-0250-1.75	BT30	25TG	3/64-1/4"	25TG-HEX	1.75"	0.61"	0.75"
B3017-0250-4.00	BT30	25TG	3/64-1/4"	25TG-HEX	4.00"	0.61"	0.75"
B3007-0500-2.00	BT30	50TG	1/8-1/2"	50TG-SPAN	2.00"	1.30"	1.34"
B3017-0500-4.00	BT30	50TG	1/8-1/2"	50TG-SPAN	4.00"	1.30"	1.34"
B3007-0750-2.50	BT30	75TG	3/64-3/4"	75TG-SPAN	2.50"	1.61"	1.89"
B3007-1000-3.94	BT30	100TG	3/64-1"	100TG-SPAN	3.94"	2.24"	2.50"
B4007-0250-2.00	BT40	25TG	3/64-1/4"	25TG-HEX	2.00"	0.61"	0.75"
B4017-0250-4.00	BT40	25TG	3/64-1/4"	25TG-HEX	4.00"	0.61"	0.75"
B4007-0500-2.25	BT40	50TG	1/8-1/2"	50TG-SPAN	2.25"	1.30"	1.34"
B4017-0500-4.00	BT40	50TG	1/8-1/2"	50TG-SPAN	4.00"	1.30"	1.34"
B4007-0750-3.00	BT40	75TG	3/64-3/4"	75TG-SPAN	3.00"	1.61"	1.89"
B4007-1000-3.50	BT40	100TG	3/64-1"	100TG-SPAN	3.50"	2.13"	2.50"
B4017-1000-5.50	BT40	100TG	3/64-1"	100TG-SPAN	5.50"	2.13"	2.50"
B4007-1500-5.50	BT40	150TG	1/2-1-1/2"	150TG-SPAN	5.50"	2.87"	3.50"
B5007-0500-2.63	BT50	50TG	1/8-1/2"	50TG-SPAN	2.63"	1.30"	1.34"
B5017-0500-4.00	BT50	50TG	1/8-1/2"	50TG-SPAN	4.00"	1.30"	1.34"
B5007-0750-3.50	BT50	75TG	3/64-3/4"	75TG-SPAN	3.50"	1.61"	1.89"
B5017-0750-5.50	BT50	75TG	3/64-3/4"	75TG-SPAN	5.50"	1.61"	1.89"
B5007-1000-3.50	BT50	100TG	3/64-1"	100TG-SPAN	3.50"	2.13"	2.50"
B5017-1000-5.50	BT50	100TG	3/64-1"	100TG-SPAN	5.50"	2.13"	2.50"
B5007-1500-4.00	BT50	150TG	1/2-1-1/2"	150TG-SPAN	4.00"	2.87"	3.50"
B5017-1500-6.00	BT50	150TG	1/2-1-1/2"	150TG-SPAN	6.00"	2.87"	3.50"

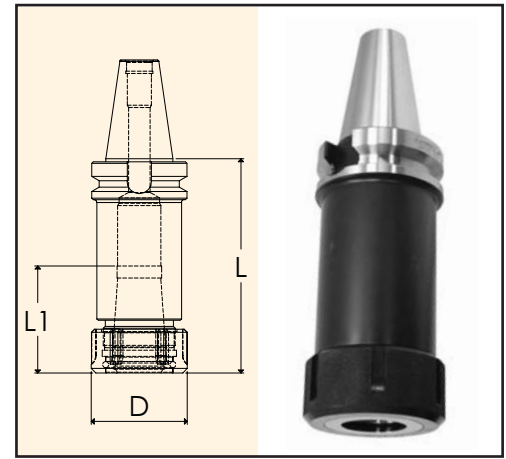

TG Collet Chucks come with back-up screw.

To use: first insert the collet into the chuck nut by squeezing the collet and pressing its face into the chuck nut's retaining ring until the collet's collar is fully seated. Then load the assembly into the chuck, insert a cutting tool, and tighten with the appropriate nut wrench to the recommended tightening torque.

To remove: simply squeeze the collet while pulling it from the chuck nut at an angle. Our handy 100TG or 150TG Collet Squeezers ease the removal of these larger collets.



When removing the back-up screw, TG Collet Chucks have coolant-thru capabilities. No disc, special nut or wrench required!  
See TG Coolant Collets on pages 62-64.

### Accessories:



**TG Collets**  
Pages 61-65



**TG Torque Wrench**  
Page 66



**TG Back Up Screw**  
Page 66



**TG Nut**  
Page 66

## NMTB and R8 TG Collet Chucks

- AT3 or better taper
- Equipped with a left-hand-threaded stop screw and chuck nut
- Ground surface for perpendicular contact
- Available in high-speed balanceable versions

Please note that the maximum RPM listed in our catalog may vary depending on the toolholder shank, weight, balanceability and the G rating.



**TIR:** < .0002 at collet face



**Speed:** up to 20,000 rpm



**Set-up:** quick and easy



**Coolant-thru:** thru-tool coolant



**Drilling**

★★★★☆



**Milling**



★★★★☆



**Reaming**

★★★★☆

### NMTB30/40/50

Part Number	Taper	Collet Series	Collet Range 	Nut Wrench 	L	L1	D
N3007-0750-2.50	NMTB30	75TG	3/64-3/4"	75TG-SPAN	2.50"	1.61"	1.89"
N3007-1000-3.94	NMTB30	100TG	3/64-1"	100TG-SPAN	3.94"	2.24"	2.50"

N4007-0750-2.50	NMTB40	75TG	3/64-3/4"	75TG-SPAN	2.50"	1.61"	1.89"
N4007-1000-3.00	NMTB40	100TG	3/64-1"	100TG-SPAN	3.00"	2.12"	2.50"
N4007-1500-5.00	NMTB40	150TG	1/2-1-1/2"	150TG-SPAN	5.00"	2.87"	3.50"



N5007-0750-3.00	NMTB50	75TG	3/64-3/4"	75TG-SPAN	3.00"	1.61"	1.89"
N5007-1000-3.50	NMTB50	100TG	3/64-1"	100TG-SPAN	3.50"	2.12"	2.50"
N5007-1500-5.00	NMTB50	150TG	1/2-1-1/2"	150TG-SPAN	5.00"	2.87"	3.50"

TG Collet Chucks come with back-up screw.

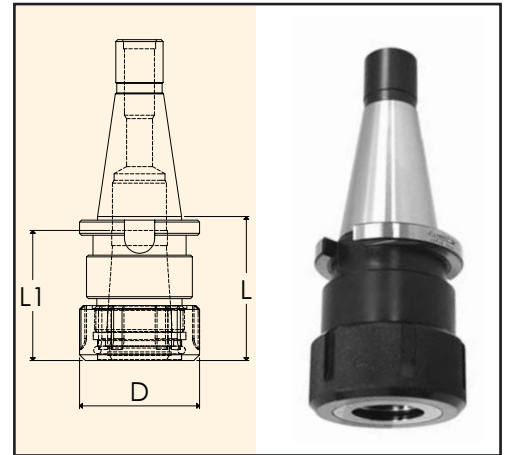
NMTB shanks are suitable for use with Erickson QC spindles.



### R8

Part Number	Collet Series	Collet Range 	Nut Wrench 	L	L1	D
R8007-1000-3.25	100TG	3/64-1"	100TG-SPAN	3.25"	2.17"	2.50"

TG Collet Chucks come with back-up screw.

To use: first insert the collet into the chuck nut by squeezing the collet and pressing its face into the chuck nut's retaining ring until the collet's collar is fully seated. Then load the assembly into the chuck, insert a cutting tool, and tighten with the appropriate nut wrench to the recommended tightening torque.

To remove: simply squeeze the collet while pulling it from the chuck nut at an angle. Our handy 100TG or 150TG Collet Squeezers ease the removal of these larger collets.



When removing the back-up screw, TG Collet Chucks have coolant-thru capabilities. No disc, special nut or wrench required!  
See TG Coolant Collets on pages 62-64.

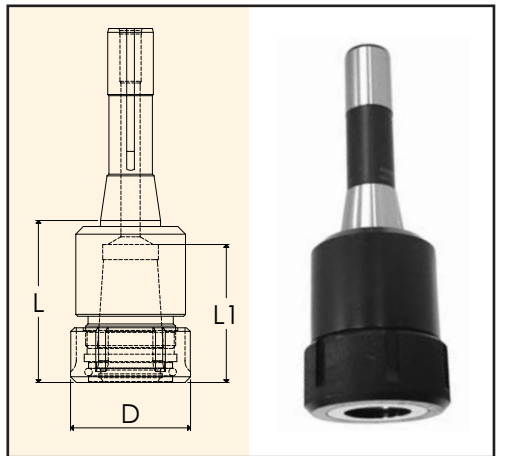

### Accessories:



**TG Collets**  
Pages 61-65



**TG Torque Wrench**  
Page 66



**TG Back Up Screw**  
Page 66



**TG Nut**  
Page 66

# Straight Shank and Morse TG Collet Chucks

- AT3 or better taper
- Equipped with a left-hand-threaded stop screw and chuck nut
- Ground surface for perpendicular contact
- Available in high-speed balanceable versions



**TIR:** < .0002 at collet face



**Speed:** up to 20,000 rpm



**Set-up:** quick and easy



**Coolant-thru:** thru-tool coolant



**Drilling**  
★★★★☆



**Milling**  
★★★★☆





**Reaming**  
★★★★☆

Please note that the maximum RPM listed in our catalog may vary depending on the toolholder shank, weight, balanceability and the G rating.

## Features of Straight Shank Tooling

- Straight shank tooling may be used to extend tooling reach for extended length operations.
- This option is less costly than extended length integral shank tooling.
- They may be used with any size machining center or lathe.
- When loaded into larger holders, their reduced O.D. permits drilling operations within large holes or whenever tight clearances are encountered.

## Straight Shank

Part Number	Collet Series	Collet Range 	Nut Wrench 	D	L	L1	L2	D1
S1007-0750-7.50	75TG	3/64-3/4"	75TG-SPAN	1.00"	7.50"	2.08"	5.00"	1.89"
S1207-1000-5.33	100TG	3/64-1"	100TG-SPAN	1.25"	5.33"	2.73"	2.28"	2.50"
S1507-1000-9.00	100TG	3/64-1"	100TG-SPAN	1.50"	9.00"	2.73"	6.00"	2.50"



TG Collet Chucks come with back-up screw.

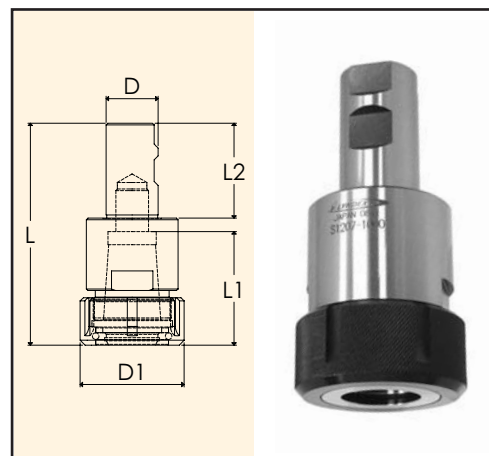

When removing the back-up screw, TG Collet Chucks have coolant-thru capabilities. No disc, special nut or wrench required!  
See TG Coolant Collets on pages 62-64.



## Morse

Part Number	Taper	Collet Series	Collet Range 	Nut Wrench 	L	L1	D1
M0307-1000-3.25	MT 3	100TG	3/64-1"	100TG-SPAN	3.25"	2.73"	2.50"
M0407-1000-3.25	MT 4	100TG	3/64-1"	100TG-SPAN	3.25"	2.73"	2.50"

TG Collet Chucks come with back-up screw.

To use: first insert the collet into the chuck nut by squeezing the collet and pressing its face into the chuck nut's retaining ring until the collet's collar is fully seated. Then load the assembly into the chuck, insert a cutting tool, and tighten with the appropriate nut wrench to the recommended tightening torque.

To remove: simply squeeze the collet while pulling it from the chuck nut at an angle. Our handy 100TG or 150TG Collet Squeezers ease the removal of these larger collets.

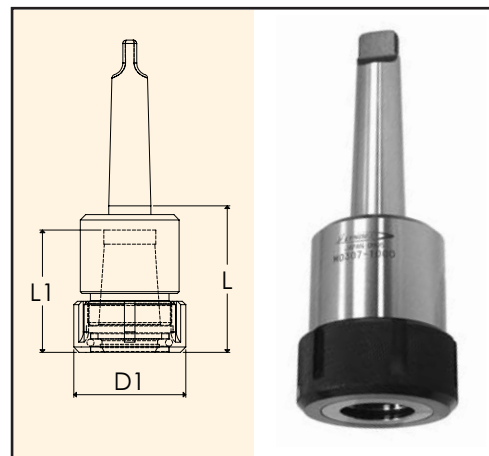

## Accessories:



**TG Collets**  
Pages 61-65



**TG Torque Wrench**  
Page 66



**TG Back Up Screw**  
Page 66



**TG Nut**  
Page 66



# TG Collets

## Dimensional Data

Style	D	D1	L	Collet Range	Nut Tightening Torque
25TG	0.425"	0.325"	0.709"	3/64-1/4"	20 ft.lbs
50TG	0.760"	0.594"	1.437"	1/8-1/2"	35 ft.lbs
75TG	1.063"	0.871"	1.844"	3/64-3/4"	55 ft.lbs
100TG	1.278"	1.121"	2.386"	3/64-1"	75 ft.lbs
150TG	1.875"	1.678"	3.000"	1/2"-1.1/2"	100 ft.lbs

- Tolerance: Guaranteed to be within 0.0003" at the collet nose.
- Accuracy: Less than 0.0005" at 4 x D.

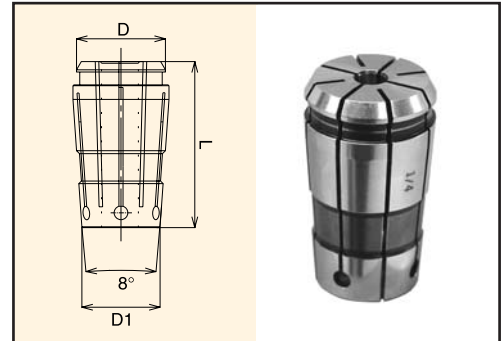

## 25TG and 50TG Collets

TG standard collets collapse approximately 1/64"

### 25TG Collets

Size range: 3/64"-1/4"

Part Number	Size
025-003	3/64"
025-004	1/16"
025-005	5/64"
025-006	3/32"
025-007	7/64"
025-008	1/8"
025-009	9/64"
025-010	5/32"
025-011	11/64"
025-012	3/16"
025-013	13/64"
025-014	7/32"
025-015	15/64"
025-016	1/4"

### 25TG Collets Sets

025-113	13 Piece 25TG Collet Set: 1/16"-1/14" by 64ths
---------	---

### 50TG Collets

Size range: 1/8"-1/2"

Part Number	Size
050-008	1/8"
050-009	9/64"
050-010	5/32"
050-011	11/64"
050-012	3/16"
050-013	13/64"
050-014	7/32"
050-015	15/64"
050-016	1/4"
050-017	17/64"
050-018	9/32"
050-019	19/64"
050-020	5/16"
050-021	21/64"
050-022	11/32"
050-023	23/64"
050-024	3/8"
050-025	25/64"
050-026	13/32"
050-027	27/64"
050-028	7/16"
050-029	29/64"
050-030	15/32"
050-031	31/64"
050-032	1/2"

### 50TG Collets Sets

050-113	13 Piece 50TG Collet Set: 1/8"-1/2" by 32nds
050-125	25 Piece 50TG Collet Set: 1/8"-1/2" by 64ths



25TG Collets



50TG Collets

# 75TG Collets

TG standard collets collapse approximately 1/64"

Size range: 3/64"-3/4"

STANDARD	
Part Number	Size
075-003	3/64"
075-004	1/16"
075-005	5/64"
075-006	3/32"
075-007	7/64"
075-008	1/8"
075-009	9/64"
075-010	5/32"
075-011	11/64"
075-012	3/16"
075-013	13/64"
075-014	7/32"
075-015	15/64"
075-016	1/4"
075-017	17/64"
075-018	9/32"
075-019	19/64"
075-020	5/16"
075-021	21/64"
075-022	11/32"
075-023	23/64"
075-024	3/8"
075-025	25/64"
075-026	13/32"
075-027	27/64"
075-028	7/16"
075-029	29/64"
075-030	15/32"
075-031	31/64"
075-032	1/2"
075-033	33/64"
075-034	17/32"
075-035	35/64"
075-036	9/16"
075-037	37/64"
075-038	19/32"
075-039	39/64"
075-040	5/8"
075-041	41/64"
075-042	21/32"
075-043	43/64"
075-044	11/16"
075-045	45/64"
075-046	23/32"
075-047	47/64"
075-048	3/4"

Size range: 1/8"-3/4"

COOLANT-THRU	
Part Number	Size
-	-
-	-
-	-
-	-
-	-
075-008(C)	1/8"
075-009(C)	9/64"
075-010(C)	5/32"
075-011(C)	11/64"
075-012(C)	3/16"
075-013(C)	13/64"
075-014(C)	7/32"
075-015(C)	15/64"
075-016(C)	1/4"
075-017(C)	17/64"
075-018(C)	9/32"
075-019(C)	19/64"
075-020(C)	5/16"
075-021(C)	21/64"
075-022(C)	11/32"
075-023(C)	23/64"
075-024(C)	3/8"
075-025(C)	25/64"
075-026(C)	13/32"
075-027(C)	27/64"
075-028(C)	7/16"
075-029(C)	29/64"
075-030(C)	15/32"
075-031(C)	31/64"
075-032(C)	1/2"
075-033(C)	33/64"
075-034(C)	17/32"
075-035(C)	35/64"
075-036(C)	9/16"
075-037(C)	37/64"
075-038(C)	19/32"
075-039(C)	39/64"
075-040(C)	5/8"
075-041(C)	41/64"
075-042(C)	21/32"
075-043(C)	43/64"
075-044(C)	11/16"
075-045(C)	45/64"
075-046(C)	23/32"
075-047(C)	47/64"
075-048(C)	3/4"



75TG Collet



75TG Collet - Coolant thru

Note: Our TG coolant collets seals up to maximum coolant pressure of 1000 PSI.

These patented coolant collets are designed for use with cylindrical shank tools (no flats). Cutting tool should be inserted the full length of the collet. If these conditions are not met, coolant leakage will result.

Range of collapsibility is 0.004-0.006" for coolant collet.

See dimensional data for TG Collets on page 61.

## 75TG Collets Sets

075-112	12 Piece 75TG Collet Set: 1/16" - 3/4" by 16ths
075-117	17 Piece 75TG Collet Set: 1/8" - 3/8" by 64ths
075-123	23 Piece 75TG Collet Set: 1/16" 3/4" by 32nds
075-127	27 Piece 75TG Collet Set: 3/32" - 1/2" by 64ths
075-145	45 Piece 75TG Collet Set: 1/16" 3/4" by 64ths

Note: Cutter must be inserted the full length of collet.

# 100TG Collets

TG standard collets collapse approximately 1/64"

Size range: 3/64"-1"

INCH	
Part Number	Size
100-003	3/64"
100-004	1/16"
100-005	5/64"
100-006	3/32"
100-007	7/64"
100-008	1/8"
100-009	9/64"
100-010	5/32"
100-011	11/64"
100-012	3/16"
100-013	13/64"
100-014	7/32"
100-015	15/64"
100-016	1/4"
100-017	17/64"
100-018	9/32"
100-019	19/64"
100-020	5/16"
100-021	21/64"
100-022	11/32"
100-023	23/64"
100-024	3/8"
100-025	25/64"
100-026	13/32"
100-027	27/64"
100-028	7/16"
100-029	29/64"
100-030	15/32"
100-031	31/64"
100-032	1/2"
100-033	33/64"
100-034	17/32"
100-035	35/64"
100-036	9/16"
100-037	37/64"
100-038	19/32"
100-039	39/64"
100-040	5/8"
100-041	41/64"
100-042	21/32"
100-043	43/64"
100-044	11/16"
100-045	45/64"
100-046	23/32"
100-047	47/64"
100-048	3/4"
100-049	49/64"
100-050	25/32"
100-051	51/64"
100-052	13/16"
100-053	53/64"
100-054	27/32"
100-055	55/64"
100-056	7/8"
100-057	57/64"
100-058	29/32"
100-059	59/64"
100-060	15/16"
100-061	61/64"
100-062	31/32"
100-063	63/64"
100-064	1"

Size range: 1/4"-1"

INCH-COOLANT-THRU	
Part Number	Size
-	-
-	-
-	-
-	-
-	-
-	-
-	-
-	-
-	-
-	-
-	-
-	-
-	-
-	-
100-016(C)	1/4"
100-017(C)	17/64"
100-018(C)	9/32"
100-019(C)	19/64"
100-020(C)	5/16"
100-021(C)	21/64"
100-022(C)	11/32"
100-023(C)	23/64"
100-024(C)	3/8"
100-025(C)	25/64"
100-026(C)	13/32"
100-027(C)	27/64"
100-028(C)	7/16"
100-029(C)	29/64"
100-030(C)	15/32"
100-031(C)	31/64"
100-032(C)	1/2"
100-033(C)	33/64"
100-034(C)	17/32"
100-035(S)	35/64"
100-036(C)	9/16"
100-037(C)	37/64"
100-038(C)	19/32"
100-039(C)	39/64"
100-040(C)	5/8"
100-041(C)	41/64"
100-042(C)	21/32"
100-043(C)	43/64"
100-044(C)	11/16"
100-045(C)	45/64"
100-046(C)	23/32"
100-047(C)	47/64"
100-048(C)	3/4"
100-049(C)	49/64"
100-050(C)	25/32"
100-051(C)	51/64"
100-052(C)	13/16"
100-053(C)	53/64"
100-054(C)	27/32"
100-055(C)	55/64"
100-056(C)	7/8"
100-057(C)	57/64"
100-058(C)	29/32"
100-059(C)	59/64"
100-060(C)	15/16"
100-061(C)	61/64"
100-062(C)	31/32"
100-063(C)	63/64"
100-064(C)	1"

Note: Cutter must be inserted the full length of collet.



100TG Coolant-thru Collet

## 100TG Coolant Collets Sets

100-111(C)	11 Piece 100TG Coolant Collet Set: 3/8" - 1" by 16ths
100-121(C)	21 Piece 100TG Coolant Collet Set: 3/8" - 1" by 32nds
100-141(C)	41 Piece 100TG Coolant Collet Set: 3/8" - 1" by 64ths

Note: Cutter must be inserted the full length of collet.

## 100TG Collets Sets

100-108	8 Piece 100TG Collet Set: 1/8" - 1" by 8ths
100-111	11 Piece 100TG Collet Set: 3/8" - 1" by 16ths
100-115	15 Piece 100TG Collet Set: 1/8" - 1" by 16ths
100-121	21 Piece 100TG Collet Set: 3/8" - 1" by 32nds
100-123	23 Piece 100TG Collet Set: 1/16" - 3/4" by 32nds
100-130	30 Piece 100TG Collet Set: 3/32" - 1" by 32nds
100-141	41 Piece 100TG Collet Set: 3/8" - 1" by 64ths
100-145	45 Piece 100TG Collet Set: 1/16" - 3/4" by 64ths
100-159	59 Piece 100TG Collet Set: 3/32" - 1" by 64ths

Note: Our TG coolant collets seals up to maximum coolant pressure of 1000 PSI.

These patented coolant collets are designed for use with cylindrical shank tools (no flats). Cutting tool should be inserted the full length of the collet. If these conditions are not met, coolant leakage will result.

Range of collapsibility is 0.004-0.006" for coolant collet.

See dimensional data for TG Collets on page 61.

# 100TG Collets

TG standard collets collapse approximately 1/64"

**Size range: 4 mm-26 mm**

METRIC	
Part Number	Size
100-204	4mm
100-206	6mm
100-208	8mm
100-210	10mm
100-212	12mm
100-214	14mm
100-216	16mm
100-218	18mm
100-220	20mm
100-222	22mm
100-224	24mm
100-225	25mm
100-226	26mm

**Size range: 6 mm-26 mm**

METRIC-COOLANT-THRU	
Part Number	Size
-	-
100-206(C)	6mm
100-208(C)	8mm
100-210(C)	10mm
100-212(C)	12mm
100-214(C)	14mm
100-216(C)	16mm
100-218(C)	18mm
100-220(C)	20mm
100-222(C)	22mm
100-224(C)	24mm
100-225(C)	25mm
100-226(C)	26mm

Note: Cutter must be inserted the full length of collet.

## 100TG Metric Collets Sets

100-123	23 Piece 100TG Collet Set: 1/16" - 3/4" by 32nds
---------	---



100TG Collet



100TG Collet - Coolant thru

Note: Our TG coolant collets seals up to maximum coolant pressure of 1000 PSI.

These patented coolant collets are designed for use with cylindrical shank tools (no flats). Cutting tool should be inserted the full length of the collet. If these conditions are not met, coolant leakage will result.

Range of collapsibility is 0.004-0.006" for coolant collet.

See dimensional data for TG Collets on page 61.

## Non-Pull 100TG Collets

**Size range: 3/18"-1"**

INCH	
Part Number	Size
100-324	3/8"
100-332	1/2"
100-340	5/8"
100-348	3/4"
100-356	7/8"
100-364	1"



100TG Non-Pull Collet

# 150TG Collets

TG standard collets collapse approximately 1/64"

Size range: 1/2"-1.1/2"

INCH			
Part Number	Size	Part Number	Size
150-032	1/2"	150-065	1-1/64"
150-033	33/64"	150-066	1-1/32"
150-034	17/32"	150-067	1-3/64"
150-035	35/64"	150-068	1-1/16"
150-036	9/16"	150-069	1-5/64"
150-037	37/64"	150-070	1-3/32"
150-038	19/32"	150-071	1-7/64"
150-039	39/64"	150-072	1-1/8"
150-040	5/8"	150-073	1-9/64"
150-041	41/64"	150-074	1-5/32"
150-042	21/32"	150-075	1-11/64"
150-043	43/64"	150-076	1-3/16"
150-044	11/16"	150-077	1-13/64"
150-045	45/64"	150-078	1-7/32"
150-046	23/32"	150-079	1-15/64"
150-047	47/64"	150-080	1-1/4"
150-048	3/4"	150-081	1-17/64"
150-049	49/64"	150-082	1-9/32"
150-050	25/32"	150-083	1-19/64"
150-051	51/64"	150-084	1-5/16"
150-052	13/16"	150-085	1-21/64"
150-053	53/64"	150-086	1-11/32"
150-054	27/32"	150-087	123/64"
150-055	55/64"	150-088	1-3/8"
150-056	7/8"	150-089	1-25/64"
150-057	57/64"	150-090	1-13/32"
150-058	29/32"	150-091	1-27/64"
150-059	59/64"	150-092	1-7/16"
150-060	15/16"	150-093	1-29/64"
150-061	61/64"	150-094	1-15/32"
150-062	31/32"	150-095	1-31/64"
150-063	63/64"	150-096	1-1/2"
150-064	1"		



150TG Collet

See dimensional data for TG Collets on page 61.

## 150TG Collets Sets

150-113	3 Piece 150TG Collet Set: 3/4" - 1-1/2" by 16ths
150-117	17 Piece 150TG Collet Set: 1/2" - 1-1/2" by 16ths
150-125	25 Piece 150TG Collet Set: 3/4" - 1-1/2" by 32nds
150-133	33 Piece 150TG Collet Set: 1/2" - 1-1/2" by 32nds
150-149	49 Piece 150TG Collet Set: 3/4" - 1-1/2" by 64ths
150-165	65 Piece 150TG Collet Set: 1/2" - 1-1/2" by 64ths

## TG Accessories

### TG Collet Squeezers

Collet squeezers are handy for quickly removing 100TG and 150TG collets from collet chuck nuts. Simply remove the cutting tool from your collet, slip a collet squeezer over the back end of the collet, and press down. The collapsed collet will slip out of the chuck nut.

Part Number	Description
100TG-PULL	100TG Collet Squeezer
150TG-PULL	150TG Collet Squeezer



### 100TG Collet Rack

Part Number	Description
RACK-5C/100TG/SK25	100TG Collet Rack, 30 pieces capacity



### Replacement Nut for TG Collet Chuck

Part Number	Description
25TG-NUT	25TG Complete Hex Nut
50TG-NUT	50TG Complete Nut
75TG-NUT	75TG Complete Nut
100TG-NUT	100TG Complete Nut
100TG-HEXNUT	100TG Complete Hex Nut
150TG-NUT	150TG Complete Nut



### Replacement Nut Parts for TG Collet Chuck

Part Number	Description
50TG-1	50TG Nut Bearing/Spacer Set
75TG-1	75TG Nut Bearing/Spacer Set
100TG-1	100TG Nut Bearing/Spacer Set
150TG-1	150TG Nut Bearing/Spacer Set



### Replacement Back-Up Screws for TG Collet Chuck

Part Number	Description
25TG-3	25TG back-up screw
50TG-3	50TG back-up screw
75TG-3	75TG back-up screw
75TG-3C	75TG Coolant back-up screw
100TG-3	100TG back-up screw
100TG-3C	100TG Coolant back-up screw
150TG-3	150TG back-up screw
150G-3C	150TG Coolant back-up screw



### Spanner Wrench for TG Collet Chuck

Part Number	Description
25TG-HEX	Fits 25TG Collet Chuck Nut
50TG-SPAN	Fits 50TG Collet Chuck Nut
75TG-SPAN	Fits 75TG Collet Chuck Nut
100TG-SPAN	Fits 100TG Collet Chuck Nut
150TG-SPAN	Fits 150TG Collet Chuck Nut



### Torque Wrench and Attachment for TG Collet Chuck

Part Number	Description
TQW-150	Torque wrench for ER11/16/20/25/32/40 Chuck Nut
TQW-TG075(50)	TG75 Attachment for TQW-150 torque wrench
TQW-TG100(63)	TG100 Attachment for TQW-150 torque wrench
TQW-TG150(82)	TG150 Attachment for TQW-150 torque wrench



See the torque wrenches specifications and details on page 222.

## CAT and BT DA Collet Chucks

- Ground surface for perpendicular contact between retention knob and holder
- AT3 or better taper
- Equipped with a left-hand-threaded stop screw and chuck nut



**TIR:** minimal



**Speed:** up to 10,000 rpm



**Set-up:** quick and easy



**Coolant-thru:** none



**Drilling**

★★★★☆



**Reaming**

★★★★☆

Please note that the maximum RPM listed in our catalog may vary depending on the toolholder shank, weight, balanceability and the G rating.

### CAT40/50

Part Number	Taper	Collet Series 	Collet Range	L	L1	D
C4007-0100-3.50	CAT40	100DA	3/64-9/16"	3.50"	1.15"	1.06"
C4017-0100-6.00	CAT40	100DA	3/64-9/16"	6.00"	1.15"	1.06"
C4007-0180-4.00	CAT40	180DA	3/64-3/4"	4.00"	1.50"	1.44"
C4017-0180-6.00	CAT40	180DA	3/64-3/4"	6.00"	1.50"	1.44"
C4007-0200-3.00	CAT40	200DA	3/64-3/8"	3.00"	1.03"	0.86"
C4007-0300-3.00	CAT40	300DA	3/64-1/4"	3.00"	0.84"	0.55"
C5007-0180-4.00	CAT50	180DA	3/64-3/4"	4.00"	1.50"	1.44"
C5017-0180-6.00	CAT50	180DA	3/64-3/4"	6.00"	1.50"	1.44"

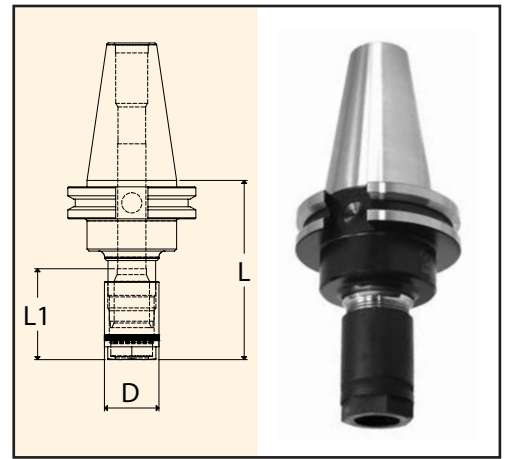

### BT30/40/50

Part Number	Taper	Collet Series 	Collet Range	L	L1	D
B3007-0100-3.00	BT30	100DA	3/64-9/16"	3.00"	1.15"	1.06"
B3007-0180-3.00	BT30	180DA	3/64-3/4"	3.00"	1.51"	1.44"
B3007-0200-3.00	BT30	200DA	3/64-3/8"	3.00"	1.03"	0.86"
B3007-0300-3.00	BT30	300DA	3/64-1/4"	3.00"	1.04"	0.55"
B4007-0100-3.50	BT40	100DA	3/64-9/16"	3.50"	1.15"	1.06"
B4017-0100-6.00	BT40	100DA	3/64-9/16"	6.00"	1.15"	1.06"
B4007-0180-4.00	BT40	180DA	3/64-3/4"	4.00"	1.51"	1.44"
B4017-0180-6.00	BT40	180DA	3/64-3/4"	6.00"	1.51"	1.44"
B4007-0200-3.00	BT40	200DA	3/64-3/8"	3.00"	1.03"	0.86"
B4007-0300-3.00	BT40	300DA	3/64-1/4"	3.00"	1.04"	0.55"
B5007-0180-4.00	BT50	180DA	3/64-3/4"	4.00"	1.51"	1.44"
B5017-0180-6.00	BT50	180DA	3/64-3/4"	6.00"	1.51"	1.44"

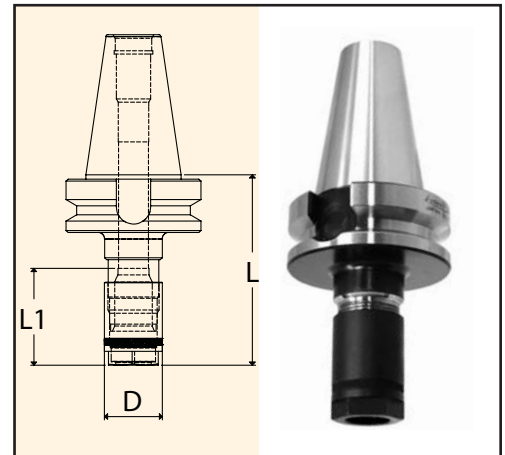

For light or medium milling, we recommend using ER or TG Collet Chucks. DA Collet Chucks are not designed for milling and can crack at the nose when over-tightened or radial load is applied. DA Collet Chucks are therefore not warranted against cracking.

#### Accessories:



**DA Collets**  
Pages 69-70







**DA Back Up Screw**  
Page 71



**DA Nut**  
Page 71

# NMTB DA Collet Chuck and DA Collet Chuck Extension

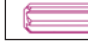
- Ground surface for perpendicular contact between retention knob and holder
- AT3 or better taper
- Equipped with a left-hand-threaded stop screw and chuck nut

	<b>TIR:</b> minimal		<b>Drilling</b> ★☆☆☆☆
	<b>Speed:</b> up to 10,000 rpm		<b>Reaming</b> ★☆☆☆☆
	<b>Set-up:</b> quick and easy		
	<b>Coolant-thru:</b> none		

Please note that the maximum RPM listed in our catalog may vary depending on the toolholder shank, weight, balanceability and the G rating.

## NMTB 30/40

Part Number	Taper	Collet Series 	Collet Range	L	L1	D
N3007-0100-2.75	NMTB30	100DA	3/64-9/16"	2.75"	1.15"	1.06"
N3007-0180-3.00	NMTB30	180DA	3/64-3/4"	3.00"	1.51"	1.44"
N3007-0200-2.50	NMTB30	200DA	3/64-3/8"	2.50"	1.03"	0.86"
N3007-0300-2.50	NMTB30	300DA	3/64-1/4"	2.50"	0.85"	0.55"
N4007-0100-2.75	NMTB40	100DA	3/64-9/16"	2.75"	1.15"	1.06"
N4007-0180-3.00	NMTB40	180DA	3/64-3/4"	3.00"	1.51"	1.44"
N4007-0200-2.50	NMTB40	200DA	3/64-3/8"	2.50"	1.03"	0.86"
N4007-0300-2.50	NMTB40	300DA	3/64-1/4"	2.50"	0.85"	0.55"
N5007-0180-3.50	NMTB50	180DA	3/64-3/4"	3.50"	1.51"	1.44"

NMTB shanks are suitable for use with Erickson QC spindles.

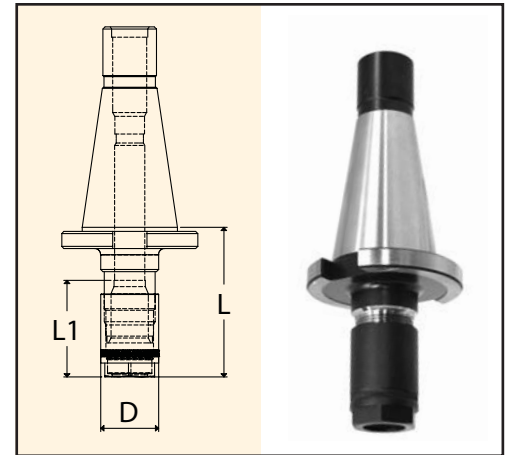

## DA Collet Chuck Extension

Part Number	Collet Series 	Collet Range	L	L1	L2	D	D1
010-EXT-100S	100DA	3/64-9/16"	4.94"	1.66"	3.00"	1"	1.06"
010-EXT-100	100DA	3/64-9/16"	7.44"	1.66"	5.50"	1"	1.06"
018-EXT-125S	180DA	3/64-3/4"	4.90"	1.83"	3.00"	1-1/4"	1.44"
018-EXT-125	180DA	3/64-3/4"	7.40"	1.83"	5.50"	1-1/4"	1.44"
020-EXT-750S	200DA	3/64-3/8"	4.67"	1.34"	3.00"	3/4"	0.86"
020-EXT-750	200DA	3/64-3/8"	7.17"	1.34"	5.50"	3/4"	0.86"
030-EXT-500S	300DA	3/64-1/4"	4.42"	1.18"	3.00"	1/2"	0.55"
030-EXT-500	300DA	3/64-1/4"	6.92"	1.18"	5.50"	1/2"	0.55"

For light or medium milling, we recommend using ER or TG Collet Chucks. DA Collet Chucks are not designed for milling and can crack at the nose when over-tightened or radial load is applied. DA Collet Chucks are therefore not warranted against cracking.

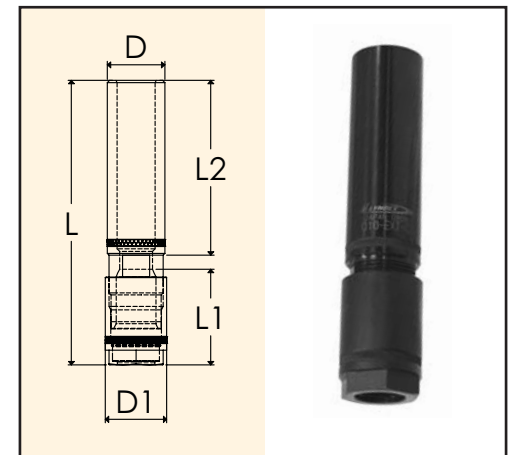

### Accessories:



**DA Collets**  
Pages 69-70



**DA Back Up Screw**  
Page 71



**DA Nut**  
Page 71



## DA Collets

### DA Collet Dimensional Data

Style	D	D1	L	Collet Range	Nut Tightening Torque
300DA	0.375"	0.300"	1.000"	3/64-1/4"	18 ft.lbs
200DA	0.539"	0.453"	1.193"	3/64-3/8"	25 ft.lbs
100DA	0.769"	0.653"	1.441"	3/64-9/16"	35 ft.lbs
180DA	1.035"	0.873"	1.637"	3/64-3/4"	40 ft.lbs

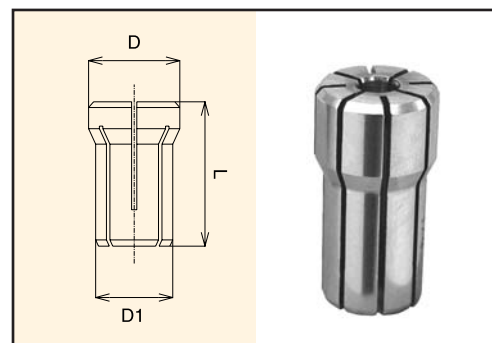

## 300DA and 200DA Collets

DA collets collapse approximately 1/32"

### 300DA Collets

Size range: 3/64" - 1/4"

Part Number	Size
030-003	3/64"
030-004	1/16"
030-005	5/64"
030-006	3/32"
030-007	7/64"
030-008	1/8"
030-009	9/64"
030-010	5/32"
030-011	11/64"
030-012	3/16"
030-013	13/64"
030-014	7/32"
030-015	15/64"
030-016	1/4"

### 200DA Collets

Size range: 3/64" - 3/8"

Part Number	Size
020-003	3/64"
020-004	1/16"
020-005	5/64"
020-006	3/32"
020-007	7/64"
020-008	1/8"
020-009	9/64"
020-010	5/32"
020-011	11/64"
020-012	3/16"
020-013	13/64"
020-014	7/32"
020-015	15/64"
020-016	1/4"
020-017	17/64"
020-018	9/32"
020-019	19/64"
020-020	5/16"
020-021	21/64"
020-022	11/32"
020-023	23/64"
020-024	3/8"



300DA Collet



200DA Collet

### 300DA Collets Sets

030-107	7 Piece 300DA Collet Set: 1/16 - 1/4" by 32nds
030-109	9 Piece 300DA Collet Set: 1/8 - 1/4" by 64ths
030-113	13 Piece 300DA Collet Set: 1/16 - 1/4" by 64ths
030-114	14 Piece 300DA Collet Set: 3/64 - 1/4" by 64ths

### 200DA Collets

020-109	9 Piece 200DA Collet Set: 1/8 - 3/8" by 32nds
020-111	11 Piece 200DA Collet Set: 1/16 - 3/8" by 32nds
020-117	17 Piece 200DA Collet Set: 1/8 - 3/8" by 64ths
020-121	21 Piece 200DA Collet Set: 1/16 - 3/8" by 64ths

# 100DA and 180DA Collets

DA collets collapse approximately 1/32"

## 100DA Collets

Size range: 3/64"-9/16"

Part Number	Size
010-003	3/64"
010-004	1/16"
010-005	5/64"
010-006	3/32"
010-007	7/64"
010-008	1/8"
010-009	9/64"
010-010	5/32"
010-011	11/64"
010-012	3/16"
010-013	13/64"
010-014	7/32"
010-015	15/64"
010-016	1/4"
010-017	17/64"
010-018	9/32"
010-019	19/64"
010-020	5/16"
010-021	21/64"
010-022	11/32"
010-023	23/64"
010-024	3/8"
010-025	25/64"
010-026	13/32"
010-027	27/64"
010-028	7/16"
010-029	29/64"
010-030	15/32"
010-031	31/64"
010-032	1/2"
010-033	33/64"
010-034	17/32"
010-035	35/64"
010-036	9/16"

See dimensional data for DA collets on page 69.

## 180DA Collets

Size range: 3/64"-3/4"

Part Number	Size
018-003	3/64"
018-004	1/16"
018-005	5/64"
018-006	3/32"
018-007	7/64"
018-008	1/8"
018-009	9/64"
018-010	5/32"
018-011	11/64"
018-012	3/16"
018-013	13/64"
018-014	7/32"
018-015	15/64"
018-016	1/4"
018-017	17/64"
018-018	9/32"
018-019	19/64"
018-020	5/16"
018-021	21/64"
018-022	11/32"
018-023	23/64"
018-024	3/8"
018-025	25/64"
018-026	13/32"
018-027	27/64"
018-028	7/16"
018-029	29/64"
018-030	15/32"
018-031	31/64"
018-032	1/2"
018-033	33/64"
018-034	17/32"
018-035	35/64"
018-036	9/16"
018-037	37/64"
018-038	19/32"
018-039	39/64"
018-040	5/8"
018-041	41/64"
018-042	21/32"
018-043	43/64"
018-044	11/16"
018-045	45/64"
018-046	23/32"
018-047	47/64"
018-048	3/4"



100DA Collet

## 100DA Collets Sets

010-108	8 Piece 100DA Collet Set: 1/8 - 9/16" by 16ths
010-111	11 Piece 100DA Collet Set: 1/4 - 9/16" by 32nds
010-115	15 Piece 100DA Collet Set: 1/8 - 9/16" by 32nds
010-117	17 Piece 100DA Collet Set: 1/16 - 9/16" by 32nds
010-121	21 Piece 100DA Collet Set: 1/4 - 9/16" by 64ths
010-129	29 Piece 100DA Collet Set: 1/8 - 9/16" by 64ths
010-133	33 Piece 100DA Collet Set: 1/16 - 9/16" by 64ths



180DA Collet

## 180DA Collets Sets

018-109	9 Piece 180DA Collet Set: 1/4 - 3/4" by 16ths
018-117	17 Piece 180DA Collet Set: 1/4 - 3/4" by 32nds
018-121	21 Piece 180DA Collet Set: 1/8 - 3/4" by 32nds
018-133	33 Piece 180DA Collet Set: 1/4 - 3/4" by 64ths
018-141	41 Piece 180DA Collet Set: 1/8 - 3/4" by 64ths

## DA Accessories

### Nut and Replacement Nut Parts for DA Collet Chuck

Part Number	Description
100DA-1	100DA Nut Spacer
100DA-2	100DA Nut Retaining Ring
100DA-NUT	100DA Nut
180DA-1	180DA Nut Spacer
180DA-2	180DA Nut Retaining Ring
180DA-NUT	180DA Nut
200DA-1	200DA Nut Spacer
200DA-2	200DA Nut Retaining Ring
200DA-NUT	200DA Nut
300DA-1	300DA Nut Spacer
300DA-2	300DA Nut Retaining Ring
300DA-NUT	300DA Nut



### Replacement Back-up Screws for DA Collet Chuck

Part Number	Description
100DA-3	Back-up screw for all CT, BT, NMTB 100DA chucks
100DA-4	Back-up screw for 100DA Chuck Extensions
180DA-3	Back-up screw for all CT, BT, NMTB 180DA chucks
180DA-4	Back-up screw for 180DA Collet Chuck Extensions
200DA-3	Back-up screw for all 40-taper 200DA Collet Chucks
200DA-4	Back-up screw for 200DA collet Chuck Extensions
200DA-5	Back-up screw for BT30 & BT35 200DA collet Chucks
300DA-3	Back-up screw for all CT, BT, NMTB, 300DA collet Chucks
300DA-4	Back-up screw for 300DA collet Chuck Extensions

