

**BASEBALL HAS THE UTILITY INFIELDER.  
INDUSTRY HAS THE PLIERS.**

Regardless of the industry, pliers, clamps, cutters and snips get reached for often. Proto®'s line is broad, featuring a wide range of general and specific-use tools. It's tough, too, forged from high quality alloy steel that's heat-treated. Most of our pliers are fitted with cushioned, slip-resistant handles.

And we build in features to reduce effort on your part. For example, our Electrostatic Discharge (ESD) pliers are a unique, dual-leaf spring design that automatically opens the jaws when you relax your grip.

Our pliers fit the task, cover the gamut and make work easier. That's utility.



# PLIERS, CLAMPING AND CUTTING



Curved Jaw Locking Pliers

**PROTO**

## PROTO® LOCKING PLIERS

Designed by engineers who look at each problem with fresh eyes, no matter how simple, each Proto® tool brings quality, durability and accuracy to the job site.

High corrosion resistant finish with welding spatter resistance.

Large diameter rivets to provide secure joints adding to the durability and robustness of the tools.

Locking mechanism helps leave both hands free when clamping, helping to eliminate squeezing action and general hand fatigue when manipulating.



Tip of release lever projects at end of handle for a quick, no-pinch, powerful release especially when tools are firmly locked.

Spring-loaded release lever is out of the way when handling.

Drop forged jaws and rugged tooth profile for durability and toughness.

Holes in mobile jaw are drilled, not press punched to ensure cylindrical shape and maximum bearing with rivets.



## SAFETY WIRE PLIERS

Safety wire is a type of positive locking device that prevents fasteners from loosening due to vibration and other forces. The presence of safety wiring also serves to indicate that the fasteners have been properly tightened.

Safety wire is available in a variety of gauges and materials, depending on the application. In aircraft and racing applications, stainless steel wire is used, most commonly in .032" diameter. Typically, the wire is threaded through a hole drilled into a fastener or part, then twisted and anchored to a second fastener or part, then twisted again.

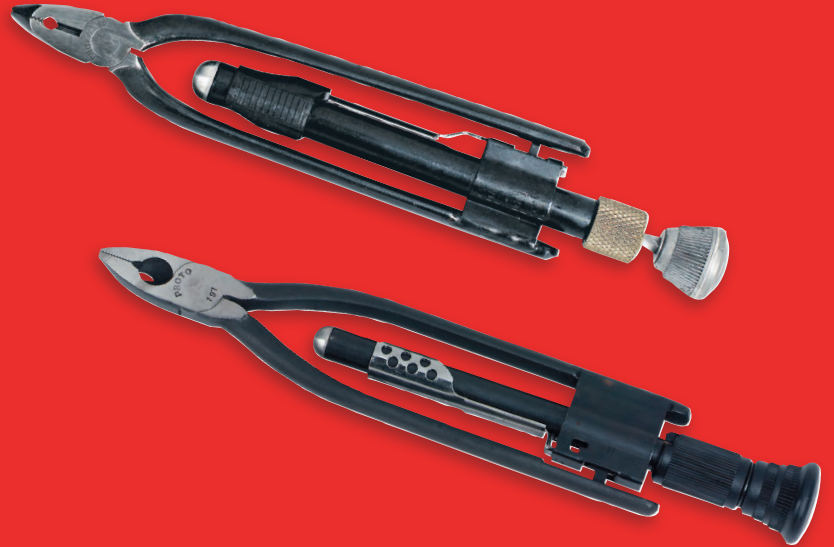

## SLIP-JOINT PLIERS

Adjustable for a variety of general uses.



**TONGUE AND GROOVE**



**COMBINATION**



**THIN NOSE**



**HOSE CLAMP**

## FIXED-JOINT PLIERS

Flush joint design for specialty jaws



**NEEDLE-NOSE**



**DUCKBILL**



**DIAGONAL CUTTING**



**LINEMAN'S**

## INSULATED PLIERS

Insulated to 1000 volts AC and 1500 volts DC



**MULTIGRIP**



**FLAT NOSE**



**END CUTTER**



**BENT NOSE**

## TONGUE AND GROOVE POWER-TRACK® II PLIERS

- › Precision milled undercut groove joint provides interlocking feature for powerful non-slip performance.
- › Special fastener ensures permanent assembly, yet allows for easy adjustment.
- › Angled teeth provide superior gripping power over standard right angled teeth.
- › Plastisol grips for added comfort.
- › Natural finish.



Product #	Overall Length (in) (L)	Max. Opening (in)	Jaw Length (in) (A)	Jaw Width (in) (B)	Jaw Thickness (in) (C)	Weight (lbs)
<b>J261SG</b>	4-5/8	15/32	7/8	13/16	3/16	0.15
<b>J262SG</b>	7-1/16	1-1/8	1-3/8	1-3/4	5/16	0.48
<b>J260SG</b>	10-3/16	2-1/8	1-15/16	2-3/4	13/32	1.00
<b>J264SG</b>	12	2-5/8	2-1/4	2-3/4	3/8	1.81
<b>J265SG</b>	16-7/8	4-1/16	3-3/8	4-1/8	17/32	3.50

ASME B107.500

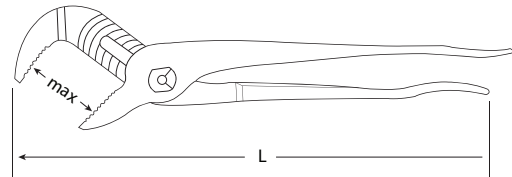
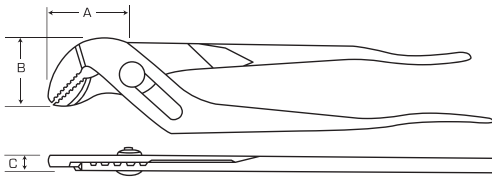

## COMBINATION SLIP-JOINT PLIERS

- › Has two jaw positions and shear type wire cutter.



Product #	Overall Length (in) (L)	Jaw Length (in) (A)	Jaw Width (in) (B)	Jaw Thickness (in) (C)	Weight (lbs)
<b>J275</b>	5-3/4	1-5/16	7/8	9/32	0.24
<b>J276</b>	6-1/2	1-3/4	1-3/16	3/8	0.52
<b>J278</b>	8	1-3/4	1-13/64	3/8	0.67
<b>J280</b>	9-1/2	2-3/8	1-7/64	15/32	1.00

ASME B107.500

## COMBINATION SLIP-JOINT PLIERS WITH GRIP

- › Has two jaw positions and shear type wire cutter.
- › Plastisol grips for added comfort.



Product #	Overall Length (in) (L)	Jaw Length (in) (A)	Jaw Width (in) (B)	Jaw Thickness (in) (C)	Weight (lbs)
<b>J275G</b>	5-13/16	1-5/16	7/8	9/32	0.24
<b>J276G</b>	6-9/16	1-3/4	1-3/16	3/8	0.52
<b>J278G</b>	8-1/16	1-3/4	1-13/64	3/8	0.67
<b>J280G</b>	9-9/16	2-3/8	1-7/16	15/32	1.00

ASME B107.500



## SMALL ANGLE NOSE PLIERS

- › Nose angled for easy access.
- › Angled teeth provide superior gripping power over standard right angled teeth.
- › Plastisol grips for added comfort.



Product #	Overall Length (in) (L)	Jaw Length (in) (A)	Jaw Width (in) (B)	Jaw Thickness (in) (C)	Weight (lbs)
<b>J235</b>	4-1/16	3/4	5/8	11/64	0.10



## THIN NOSE PLIERS

- › Easy access to tight areas.
- › Has two jaw positions and shear type wire cutter.
- › Plastisol grips for added comfort.



Product #	Overall Length (in) (L)	Jaw Length (in) (A)	Jaw Width (in) (B)	Jaw Thickness (in) (C)	Weight (lbs)
<b>J2026</b>	6-11/16	1-15/16	1-1/16	3/16	0.47



ASME B107.500

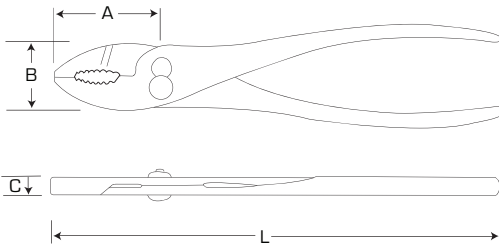

## SOFT JAW - CANNON PLUG PLIERS

- › Capacity of 3/4" to 2-1/2".
- › Four position pivot design provides greater concentricity.
- › Replaceable urethane padded jaws protect work piece from marking or scratching.
- › Plastisol grips for added comfort.



Product #	Overall Length (in) (L)	Max. Opening (in)	Replacement Item	Weight (lbs)
<b>J2536</b>	9-1/2	3/4 - 2-1/2	253GRK	0.54



## HOSE CLAMP PLIERS

- › Installs and removes wire spring tension clamps.
- › Two position jaws grip full range of clamp sizes.
- › Plastisol grips for added comfort.



Product #	Overall Length (in) (L)	Weight (lbs)
<b>J2526</b>	7-3/4	0.56



## NEEDLE-NOSE PLIERS

- › Diamond serrated jaws.
- › Plastisol grips for added comfort.

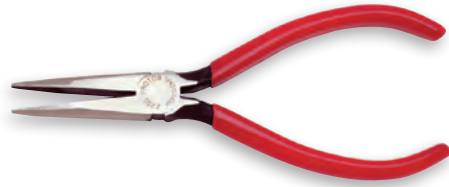

Product #	Overall Length (in) (L)	Jaw Length (in) (A)	Jaw Width (in) (B)	Jaw Thickness (in) (C)	Weight (lbs)
<b>J2826</b>	4-7/8	1-3/16	7/16	1/4	0.16
<b>J229-036</b>	5-9/16	1-11/16	1/2	9/32	0.23
<b>J2206</b>	6-5/8	1-7/8	11/16	3/8	0.35

 ASME B107.500

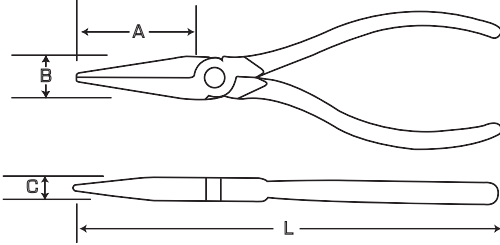

## NEEDLE-NOSE PLIERS - COIL SPRING

- › Coil spring.
- › Diamond serrated jaws.
- › Plastisol grips for added comfort.



Product #	Overall Length (in) (L)	Jaw Length (in) (A)	Jaw Width (in) (B)	Jaw Thickness (in) (C)	Weight (lbs)
<b>J282B56</b>	5	1-3/16	7/16	1/4	0.16

 ASME B107.500

## NEEDLE-NOSE PLIERS WITH CUTTER

- › Induction hardened cutting edges.
- › Diamond serrated jaws.
- › Plastisol grips for added comfort.

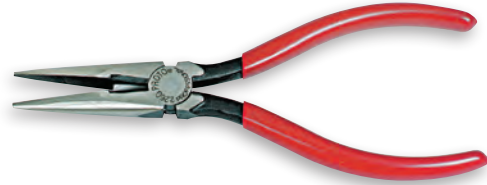

Product #	Overall Length (in) (L)	Jaw Length (in) (A)	Jaw Width (in) (B)	Jaw Thickness (in) (C)	Weight (lbs)
<b>J2266</b>	6-5/8	1-7/8	11/16	3/8	0.34

 ASME B107.500

## NEEDLE-NOSE PLIERS WITH CUTTER - COIL SPRING

- › Induction hardened cutting edges.
- › Diamond serrated jaws.
- › Coil spring.
- › Plastisol grips for added comfort.



Product #	Overall Length (in) (L)	Jaw Length (in) (A)	Jaw Width (in) (B)	Jaw Thickness (in) (C)	Weight (lbs)
<b>J229-016</b>	5-9/16	1-11/16	1/2	9/32	0.23
<b>J226-016</b>	7-1/2	2-5/8	3/4	3/8	0.40

 ASME B107.500



## NEEDLE-NOSE PLIERS - LONG REACH

- › Extra-long handle allows greater access to confined, restricted areas.
- › Improved fulcrum point provides more holding power at the tip with less gripping effort.
- › Plastisol grips for added comfort.



Product #	Overall Length (in) (L)	Jaw Length (in) (A)	Jaw Width (in) (B)	Jaw Thickness (in) (C)	Weight (lbs)
<b>J240G</b>	11-9/16	2-13/16	23/32	13/32	0.63

## NEEDLE-NOSE PLIERS - LONG

- › Long handle for added leverage.
- › Diamond serrated jaws.
- › Plastisol grips for added comfort.



Product #	Overall Length (in) (L)	Jaw Length (in) (A)	Jaw Width (in) (B)	Jaw Thickness (in) (C)	Weight (lbs)
<b>J228G</b>	7-25/32	1-9/16	17/32	7/16	0.38



ASME B107.500

## NEEDLE-NOSE PLIERS - LONG THIN

- › Very thin nose allows access into minimum clearance areas.
- › Diamond serrated jaws.
- › Plastisol grips for added comfort.

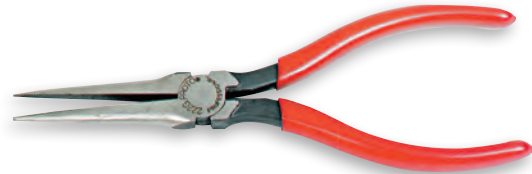

Product #	Overall Length (in) (L)	Jaw Length (in) (A)	Jaw Width (in) (B)	Jaw Thickness (in) (C)	Weight (lbs)
<b>J222G</b>	6-1/16	2-1/8	11/16	11/32	0.28



ASME B107.500

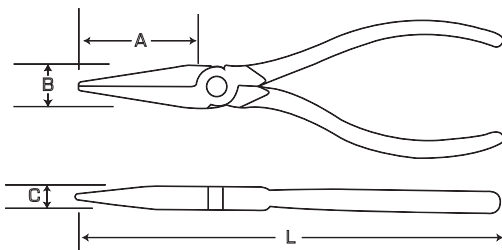

## NEEDLE-NOSE PLIERS - LONG EXTRA THIN

- › Extra slim-nose pliers for light precision work.
- › Designed for gripping, looping, and twisting wire in confined areas.
- › Plastisol grips for added comfort.



Product #	Overall Length (in) (L)	Jaw Length (in) (A)	Jaw Width (in) (B)	Jaw Thickness (in) (C)	Weight (lbs)
<b>J223G</b>	6-5/32	2-5/32	1/2	9/32	0.20



ASME B107.500



## BENT NOSE-NEEDLE NOSE PLIERS

- › Nose bent to 78° angle to reach around obstructions.
- › Very thin nose allows access into minimum clearance areas.
- › Diamond serrated jaws.
- › Plastisol grips for added comfort.

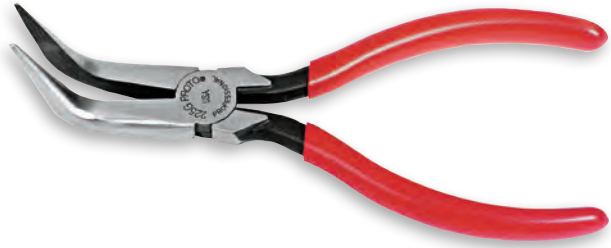

Product #	Overall Length (in) (L)	Jaw Length (in) (A)	Jaw Width (in) (B)	Jaw Thickness (in) (C)	Weight (lbs)
<b>J2256</b>	6-5/16	1-5/8	3/4	3/8	0.42

ASME B107.500

## BENT NOSE NEEDLE-NOSE PLIERS - LONG REACH

- › Extra-long handle allows greater access to confined, restricted areas.
- › Improved fulcrum point provides more holding power at the tip with less gripping effort.
- › Bent nose design to reach around obstructions.
- › Plastisol grips for added comfort.



Product #	Overall Length (in) (L)	Jaw Length (in) (A)	Jaw Width (in) (B)	Jaw Thickness (in) (C)	Weight (lbs)
<b>J2416</b>	11-3/8	2-9/16	23/32	13/32	0.62

ASME B107.500

## DUCKBILL PLIERS

- › Wide, flat nose for better grip than standard needle-nose pliers.
- › Diamond serrated jaws.
- › Long handle for added leverage.
- › Plastisol grips for added comfort.



Product #	Overall Length (in) (L)	Jaw Length (in) (A)	Jaw Width (in) (B)	Jaw Thickness (in) (C)	Weight (lbs)
<b>J2276</b>	7-25/32	1-9/16	17/32	7/16	0.38

ASME B107.500

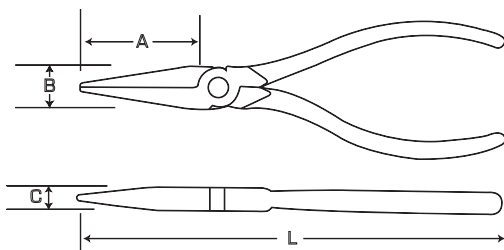



## DIAGONAL CUTTING PLIERS

- › Induction hardened cutting edges.
- › Thin narrow jaws for access in tight areas.
- › Plastisol grips for added comfort.



Product #	Overall Length (in) (L)	Jaw Length (in) (A)	Jaw Width (in) (B)	Jaw Thickness (in) (C)	Weight (lbs)
<b>J285G</b>	4-5/8	13/32	7/16	1/4	0.13
<b>J204G</b>	4-7/16	18/32	9/16	5/16	0.22
<b>J205G</b>	5-1/16	3/4	19/32	3/8	0.24
<b>J206G</b>	6-1/16	13/16	3/4	7/16	0.40
<b>J207G</b>	7-5/16	1	7/8	15/32	0.50



ASME B107.500

## DIAGONAL CUTTING PLIERS - COIL SPRING

- › Coil springs.
- › Induction hardened cutting edges.
- › Thin narrow jaws for access in tight areas.
- › Plastisol grips for added comfort.



Product #	Overall Length (in) (L)	Jaw Length (in) (A)	Jaw Width (in) (B)	Jaw Thickness (in) (C)	Weight (lbs)
<b>J285BSG</b>	4-5/8	13/32	7/16	1/4	0.13
<b>J204SG</b>	4-7/16	18/32	9/16	5/16	0.22



ASME B107.500

## DIAGONAL CUTTING PLIERS - ANGLED HEAD

- › Angled head for work in confined areas.
- › Plastisol grips for added comfort.



Product #	Overall Length (in) (L)	Jaw Length (in) (A)	Jaw Width (in) (B)	Jaw Thickness (in) (C)	Weight (lbs)
<b>J210AHG</b>	8-1/8	3/4	1-7/32	5/32	0.64

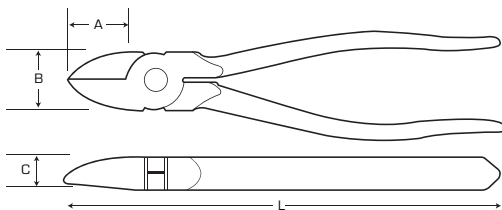

## HEAVY-DUTY DIAGONAL CUTTING PLIERS

- › Induction hardened cutting edge.
- › Powerful leverage cuts heavy wire with ease.
- › Plastisol grips for added comfort.



Product #	Overall Length (in) (L)	Jaw Length (in) (A)	Jaw Width (in) (B)	Jaw Thickness (in) (C)	Weight (lbs)
<b>J209G</b>	7-5/16	2-5/32	7/8	1/2	0.58
<b>J210G</b>	8-1/2	3/4	1-7/32	15/32	0.64

 ASME B107.500

## DIAGONAL PLASTIC CUTTING PLIERS

- › Adjusting set screw allows fast, precise cutting and prevents cutting edges from damaging each other.
- › Coil spring for reduced hand fatigue.
- › Induction hardened cutting edges.
- › Plastisol grips for added comfort



Product #	Overall Length (in) (L)	Jaw Length (in) (A)	Jaw Width (in) (B)	Jaw Thickness (in) (C)	Weight (lbs)
<b>J212G</b>	6-1/16	3/4	3/4	7/16	0.39
<b>J213G</b>	7-5/16	1	29/32	1/2	0.53



## HIGH LEVERAGE DIAGONAL CUTTING PLIERS LONG REACH - ANGLED HEAD

- › Extra-long handle provides high leverage cutting capabilities with less user effort.
- › 30° angled head for hard-to-reach areas.
- › Wide handle contour for less fatigue.
- › Plastisol grips for added comfort.



Product #	Overall Length (in) (L)	Jaw Length (in) (A)	Jaw Width (in) (B)	Jaw Thickness (in) (C)	Weight (lbs)
<b>J244G</b>	11-1/8	1	63/64	1-5/32	0.94





## DIAGONAL CUTTING PLIERS LONG REACH - GRIPPING TIP

- › Cutting and gripping capabilities in one tool.
- › Serrated gripping surface at tips.
- › Plastisol grips for added comfort.



Product #	Overall Length (in) (L)	Jaw Length (in) (A)	Jaw Width (in) (B)	Jaw Thickness (in) (C)	Weight (lbs)
<b>J246G</b>	11-1/8	27/32	63/64	25/64	0.74



## LINEMAN'S PLIERS

- › For utility linemen, wiring and electrical equipment installation, and maintenance.
- › Induction hardened cutting edges and diamond serrated jaws.
- › Built-in insulation crusher
- › Plastisol grips for added comfort.



Product #	Overall Length (in) (L)	Jaw Length (in) (A)	Jaw Width (in) (B)	Jaw Thickness (in) (C)	Weight (lbs)
<b>J268G</b>	8-5/8	1-1/2	1-3/16	5/8	0.98



ASME B107.500

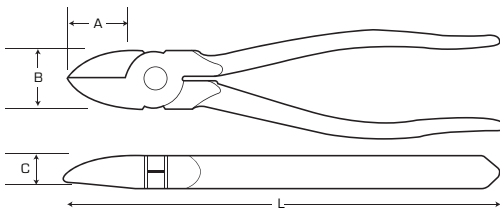

## LINEMAN'S PLIERS - NEW ENGLAND STYLE

- › Slim rounded nose for easy access in restricted spaces.
- › Diamond serrated jaws.
- › Plastisol grips for added comfort.



Product #	Overall Length (in) (L)	Jaw Length (in) (A)	Jaw Width (in) (B)	Jaw Thickness (in) (C)	Weight (lbs)
<b>J266G</b>	6-3/16	1-3/32	29/32	1/2	0.50
<b>J267G</b>	7-1/4	1-9/32	1-1/8	1/2	0.67



ASME B107.500

## LINEMAN'S PLIERS - HIGH LEVERAGE

- › Jaws have offset rivet for increased leverage.
- › Designed for cutting No. 8 and other large wires.
- › Diamond serrated jaws.
- › Plastisol grips for added comfort.



Product #	Overall Length (in) (L)	Jaw Length (in) (A)	Jaw Width (in) (B)	Jaw Thickness (in) (C)	Weight (lbs)
<b>J2696</b>	9-1/4	1-3/16	1-3/32	5/8	1.10

ASME B107.500

## LINEMAN'S PLIERS - PIPE JAW

- › Serrated flat nose jaws with toothed pipe grip.
- › Plastisol grips for added comfort.



Product #	Overall Length (in) (L)	Jaw Length (in) (A)	Jaw Width (in) (B)	Jaw Thickness (in) (C)	Weight (lbs)
<b>J268PJG</b>	8-3/8	1-3/4	1-1/16	17/32	0.87

## IRON WORKER'S PLIERS

- › Designed to tie and cut wire associated with reinforcing bar.
- › Hook bend in handle to reduce slippage when gripping and pulling.
- › Coil spring holds jaws open, yet close easily.
- › Plastisol grips for added comfort.



Product #	Overall Length (in) (L)	Jaw Length (in) (A)	Jaw Width (in) (B)	Jaw Thickness (in) (C)	Weight (lbs)
<b>J269WSG</b>	9-1/4	1-9/16	1-9/32	5/8	1.16

## END-CUTTING PLIERS - HIGH LEVERAGE

- › Semi-flush cutting in areas inaccessible to side-cutting pliers.
- › High leverage for easy cutting of most wires and nails.
- › Plastisol grips for added comfort.

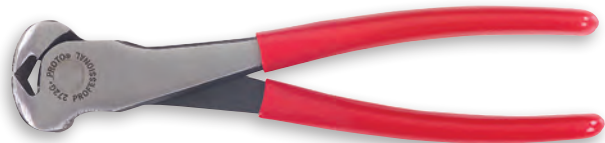

Product #	Overall Length (in) (L)	Jaw Length (in) (A)	Jaw Width (in) (B)	Jaw Thickness (in) (C)	Weight (lbs)
<b>J2726</b>	8-1/4	5/16	1-3/4	1-3/16	0.90

ASME B107.500



## ANATOMY OF PROTO® LOCKING PLIERS

Designed by engineers who look at each problem with fresh eyes, no matter how simple, each Proto® tool brings quality, durability and accuracy to the job site.

Locking mechanism helps leave both hands free when clamping, helping to eliminate squeezing action and general hand fatigue when manipulating.

• High corrosion resistant finish with welding spatter resistance.

• Large diameter rivets to provide secure joints adding to the durability and robustness of the tools.

Tip of release lever projects at end of handle for a quick, no-pinch, powerful release especially when tools are firmly locked.

Spring-loaded release lever is out of the way when handling.

Holes in mobile jaw are drilled, not press punched to ensure cylindrical shape and maximum bearing with rivets.

Drop forged jaws and rugged tooth profile for durability and toughness.



## 5 PIECE LOCKING PLIERS WELDING SET

Product #: **JWK5XL**

- › Set designed for welding applications.
- › Locking mechanism helps leave both hands free when clamping, helping to eliminate squeezing action and general hand fatigue when manipulating.
- › High corrosion resistant finish with welding spatter resistance.

Contents	Description
J281XL	Pliers, Locking Optimum Grip 9-27/32"
J301XL	Pliers, Locking Plug Weld Pliers 9-41/64"
J286LNXL	Pliers, Locking Mini Long Nose 6-29/32"
J274XL	Pliers, Locking Aluminum Alloy C-Clamp 11-5/12"
JMICROXL	Pliers, Micro Grip Clamp 3-5/8"



### 3 PIECE LOCKING PLIERS SET

Product #: **J299RXL**

- › Locking mechanism helps leave both hands free when clamping, helping to eliminate squeezing action and general hand fatigue when manipulating.
- › Tip of release lever projects at end of handle for a quick, no-pinch, powerful release especially when tools are firmly locked.
- › Spring-loaded release lever is out of the way when handling.
- › Drop forged jaws and rugged tooth profile for durability and toughness.
- › Holes in mobile jaw are drilled and not press punched to ensure they are cylindrical to ensure maximum bearing with rivets. (Punched holes tend give poor bearing.)
- › Large diameter of rivets to help permit secure joints adding to the durability and robustness of the tools.
- › Piano wire spring for smooth and efficient jaw opening.



Contents	Description
J292XL	Pliers, Locking Curved Jaw 9-1/4"
J291XL	Pliers, Locking Straight Jaw 7-15/32"
J286LNLX	Pliers, Locking Mini Long Nose 6-29/32"
J25TR22C	Tool Roll

### 3 PIECE LOCKING PLIERS SET - NICKEL CHROME

Product #: **J299NC**

- › Locking mechanism helps leave both hands free when clamping, helping to eliminate squeezing action and general hand fatigue when manipulating.
- › Tip of release lever projects at end of handle for a quick, no-pinch, powerful release especially when tools are firmly locked.
- › Spring-loaded release lever is out of the way when handling.
- › Drop forged jaws and rugged tooth profile for durability and toughness.
- › Holes in mobile jaw are drilled and not press punched to ensure they are cylindrical to ensure maximum bearing with rivets. (Punched holes tend give poor bearing.)
- › Large diameter of rivets to help permit secure joints adding to the durability and robustness of the tools.
- › Piano wire spring for smooth and efficient jaw opening.



Contents	Description
J292NC	Pliers, Nickel Chrome Locking Curved - 9-1/4"
J291NC	Pliers, Nickel Chrome Locking Straight - 7-15/32"
J286NC	Pliers, Nickel Chrome Needle-Nose - 6-7/8"
J25TR22C	Tool Roll

### OPTIMUM GRIP LOCKING PLIERS

- › Jaw configuration combining straight, curved and convex profiles.
- › Versatile tool securely gripping round, flat and large objects.
- › Multi-use for plumbers, welders and others.



Product #	Overall Length (in) (L)	Jaw Length (in) (A)	Jaw Width (in) (B)	Jaw Thickness (in) (C)	Weight (lbs)
J280XL	7-7/8	1-25/32	27/64	27/64	0.90
J281XL	9-27/32	2-5/32	1/2	1/2	1.43



## CURVED JAW LOCKING PLIERS

- › Narrow large opening curved shaped jaws.
- › Allows firm hold on all round shapes.
- › Universal tool for multi-use.

Product #	Overall Length (in) (L)	Jaw Width (in) (B)	Weight (lbs)
<b>J290XL</b>	7-15/32	11/32	0.82
<b>J292XL</b>	9-1/4	25/64	1.32



## CURVED JAW LOCKING PLIERS WITH CUTTER

- › Wide jaw profile with wire cutter.
- › Two tools in one.
- › Multi-functional use.

Product #	Overall Length (in) (L)	Jaw Width (in) (B)	Weight (lbs)
<b>J292WRXL</b>	9-4/11	1/2	1.32
<b>J293WRXL</b>	5-1/2	21/64	0.40
<b>J294WRXL</b>	7-15/32	11/32	0.82



## STRAIGHT JAW LOCKING PLIERS

- › Heavy-duty nose.
- › Reinforced precisely machined teeth.
- › Strong, tough tool.
- › Helps provide secure grip for extra tough jobs.
- › General purpose for various maintenance situations.
- › Locking nut to hold adjustment during repetitive jobs.

Product #	Overall Length (in) (L)	Jaw Width (in) (B)	Weight (lbs)
<b>J291XL</b>	7-15/32	1/2	0.88
<b>J293XL</b>	9-1/4	5/8	1.39



## GROOVED GRIP LOCKING PLIERS

- › Tapered groove in mobile jaw.
- › Convex jaw.
- › Firm hold of cylindrical objects without lateral movement.
- › Clears small obstacles.
- › Ideal for holding and handling drill bits, taps, fasteners and tubes in general maintenance work.

Product #	Overall Length (in) (L)	Weight (lbs)
<b>J282XL</b>	9-7/16	1.32





## LONG NOSE LOCKING PLIERS

- › Long slim jaw design.
- › Curved section.
- › Pliers can reach deep into recessed areas.
- › Can hold rounded objects.
- › Great for holding, placing and extracting pieces in awkward areas, engines, etc.

Product #	Overall Length (in) (L)	Jaw Width (in) (B)	Weight (lbs)
J289LNXL	9-1/32	25/64	0.88
J286LNXL	6-29/32	5/16	0.42



## LOCKING CHAIN PLIERS

- › Flexible heavy-duty, heat-treated chain which adjusts quickly around any shaped object even in awkward areas.
- › Use to remove oil filters or holding odd shapes for welding.
- › Replacement chain available - J262RC

Product #	Overall Length (in) (L)	Jaw Width (in) (B)	Weight (lbs)
J262XL	9-27/32	45/64	1.98



## LOCKING CHAIN PIPE CUTTER

- › 13 Alloy steel cutting wheels to evenly cut difficult to reach thin wall pipes by hand ratcheting.
- › Locking mechanism - no squeezing, avoids risk of lateral movement and misaligned cutting.
- › Butterfly screw for easy feeding as cutting.
- › Cuts through steel, copper, aluminum, and some stainless steels.
- › Great for exhaust pipe repair and removal.
- › Use in plumbing and heating.
- › Replacement chain available - J263RC

Product #	Overall Length (in) (L)	Jaw Width (in) (B)	Weight (lbs)
J263XL	9-27/32	1-3/32	1.76



## LOCKING CHAIN PIPE CUTTER PLUS

- › 15 Alloy steel cutting wheels to evenly cut difficult to reach piping up to 1/4 / 6 mm wall thickness by hand ratcheting.
- › Locking mechanism - no squeezing, avoids risk of lateral movement and misaligned cutting.
- › Cuts through galvanized steel, some stainless steels, copper, PVC, and aluminum.
- › Problem solving and time saving, ideal for plumbing, heating, joinery, and general maintenance.
- › Replacement chain available - J264RC

Product #	Overall Length (in) (L)	Jaw Width (in) (B)	Weight (lbs)
J264XL	11-9/11	1-11/64	2.76





## LOCKING SHEET METAL TOOL

- › Wide jaw profile to allow powerful grip on large thin surfaces.
- › Clamps, forms, bends, and crimps sheet metal.

Product #	Overall Length (in) (L)	Jaw Width (in) (B)	Weight (lbs)
<b>J260XL</b>	8-1/16	3-9/64	1.15



## LOCKING PLUG WELD PLIERS

- › Copper alloy knurled swivel pad to help prevent burn through when plug welding thin sheet metal. Plug welding is advised in most American Collision Repair Procedure Manuals.
- › U-shaped mobile jaw to help provide even pressure around spot to be welded.
- › Appropriate for general maintenance work.

Product #	Overall Length (in) (L)	Weight (lbs)
<b>J301XL</b>	9-16/25	1.12



## LOCKING WELDING PLIERS

- › Firmly holds two sections together. Hands free solution in general welding and body work.
- › U-shaped jaw profile: Permits the clamping of adjacent joints and perfect visibility when welding.

Product #	Overall Length (in) (L)	Jaw Width (in) (B)	Weight (lbs)
<b>J261XL</b>	9-1/32	2-3/4	1.54



## LOCKING STEEL CLAMPS

- › Wide and deep jaw profile to help clear obstacles and firmly clamp sections which locking pliers can not.
- › Clamp in close quarters for auto body work and welding shops.



Product #	Overall Length (in) (L)	Jaw Width (in) (B)	Jaw Thickness (in) (C)	Weight (lbs)
<b>J265XL</b>	6-8/11	5/16	1-61/64	0.53
<b>J266XL</b>	11-1/5	15/32	3-15/16	1.96
<b>J267XL</b>	18-1/2	15/32	10-15/64	2.87
<b>J268XL</b>	24-27/64	15/32	15-47/64	3.31

## LOCKING C-CLAMPS WITH SWIVEL PADS

- › Knurled swivel pads - allow non-slip no damage parallel clamping even on tapered surfaces.
- › J269XL—Small in size for delicate and fine work—ideal for electronics.
- › Safely clamps delicate surfaces - wood, plastic, and soft materials.

Product #	Overall Length (in) (L)	Jaw Width (in) (B)	Weight (lbs)
<b>J269XL</b>	6-1/2	3/4	0.60
<b>J270XL</b>	12-19/32	1-11/64	2.20
<b>J271XL</b>	14-3/8	5-1/2	2.70
<b>J272XL</b>	18-1/2	10-15/64	3.20
<b>J273XL</b>	24-8/9	1-11/64	4.00



## LOCKING PIPE CLAMP

- › Undulated U-shaped jaws to help allow secure clamping on rounded sections and perfect visibility for welding.
- › Holds two pipes well aligned for accurate welding in plumbing and general pipe and tube manipulation.

Product #	Overall Length (in) (L)	Jaw Width (in) (B)	Weight (lbs)
<b>J283XL</b>	11-3/5	2-3/4	2.12



## ERGO GRIP LOCKING PLIERS

- › Long jaw with straight and curved profiles for multiple applications.
- › Cushion grip helps reduce slippage with added comfort.
- › 70° angled design - allows exertion of up to 50% more force in twisting applications.
- › Helps keep wrist straight, reducing strain and general fatigue.
- › Allows use in areas of limited space.

Product #	Overall Length (in) (L)	Weight (lbs)
<b>J300XL</b>	7-3/32	0.83





## LOCKING ALUMINUM ALLOY C-CLAMPS

- › Modern ergonomic clamps with aircraft aluminum alloy jaws for professional welding and metal work.
- › Light weight for comfort and ease of handling for the intensive user.
- › Spatter resistant material to ensure good working order and helps avoid tiresome cleaning.
- › Heat-treated die cast jaws to ensure resist and durability.

Product #	Overall Length (in) (L)	Jaw Width (in) (B)	Weight (lbs)
<b>J274XL</b>	11-5/12	15/32	1.48
<b>J275XL</b>	14-2/11	45/64	1.92



## LOCKING ALUMINUM ALLOY U-CLAMP

- › Lightweight to help lower risk of warping and distorting of auto body panels especially new aluminum alloy panels. Also for comfort and easy handling for the intensive user.
- › Welding panels are designed to not adhere to aluminum to help ensure working order and tiresome cleaning of tools.
- › Aluminum will not weld to work piece – no hassle, time saver.
- › Jaws are made from heat-treated die cast aluminum alloy for resistance and durability.

Product #	Overall Length (in) (L)	Jaw Width (in) (B)	Weight (lbs)
<b>J276XL</b>	9-3/5	2-3/4	1.63



## MICRO GRIP CLAMP

- › Small locking clamp.
- › Ideal for even heavy-duty jobs in difficult to reach areas.
- › Applications: Auto body repair and metal fabrication.

Product #	Overall Length (in) (L)	Jaw Width (in) (B)	Weight (lbs)
<b>JMICROXL</b>	3-5/8	3/4	1.12



## NICKEL CHROME LOCKING PLIERS

- › High tensile strength microalloy steel.
- › Long slim jaw design.
- › Curved section.
- › Pliers can reach deep into recessed areas.
- › Can hold rounded objects.
- › Great for holding, placing and extracting pieces in awkward areas, engines, etc.

Product #	Overall Length (in) (L)	Jaw Width (in) (B)	Weight (lbs)
<b>J266NC</b>	11-1/5	15/32	1.96
<b>J286NC</b>	6-7/8	5/16	0.42
<b>J291NC</b>	7-15/32	1/2	0.88
<b>J292NC</b>	9-1/4	25/64	1.32
<b>J293NC</b>	10	5/8	1.48



## 4 PIECE HANDS FREE KIT

- › (2) J281XL 10" Optimum Grip.
- › (2) JGHXL 6" Grip Holder.
- › A true hands free work holding system.
- › Secure the holder, insert the locking pliers and you have a portable vice.

Product #	Weight (lbs)
<b>JHK4XL</b>	4.63



## LOCKING GRIP HOLDERS

- › Designed with special slot.
- › Swivel pad.
- › Butterfly screw.
- › Firmly holds 10" tools converting them into a versatile portable vise.
- › Helps ensure firm hold on all work pieces.
- › Easy to adjust.
- › Use a standard c-clamp or combined with locking tools for a hands free work.

Product #	Overall Length (in) (L)	Weight (lbs)
<b>JGHXL</b>	5-5/32	0.55
<b>JMGHXL</b>	5-5/32	0.66



## SAFETY WIRE TWISTER PLIERS - DEEP REACH

- › Designed for access into close clearance areas.

Product #	Overall Length (in) (L)	Weight (lbs)
<b>J193</b>	18-1/8	0.43





## SAFETY WIRE TWISTER PLIERS

- › Safety wire is often used in aviation and other applications where vibration may cause fasteners to back out.
- › Heat-treated cutting edges for cutting tough stainless steel safety wire.
- › Flat top diamond serrations on jaws hold wire securely and resist nicking.
- › Diagonal nose allows access in tight work areas.
- › Automatic spring return feature speeds operation and reduces fatigue.
- › J190 designed for wire sizes .020" - .041".
- › J191, J192, J195 designed for wire sizes .020" - .060".
- › J192 Ergonomically designed.
- › J195 Left hand twist.



Product #	Overall Length (in) (L)	Weight (lbs)
<b>J190</b>	8-3/8	0.59
<b>J191</b>	10-3/8	0.85
<b>J192</b>	10-3/8	0.85
<b>J195</b>	10-3/8	0.85

 ASME B107.500

## SAFETY WIRE TWISTER PLIERS - REVERSIBLE

- › Reversible safety wire pliers provide right and left twist capability often eliminating the need for a second plier.
- › Meets SAE Aerospace Standard AS 567 Twister Requirements.
- › Provides all of the features of standard Proto® Safety Wire Pliers.
- › J196 designed for wire sizes .020" - .041".
- › J197 designed for wire sizes .020" - .060".
- › J198 designed for wire sizes .020" - 0.60".



Product #	Overall Length (in) (L)	Weight (lbs)
<b>J196</b>	8-3/4	0.64
<b>J197</b>	11	0.88
<b>J198</b>	12-1/4	0.91



## 3 PIECE SAFETY WIRE TWISTER PLIERS SET

**Product #:** J194

- › Contains three different twisters to cover almost any application.
- › Includes 6" and 9" wire twister pliers and deep reach pliers.
- › Packed in handy, durable plastic storage case.



Contents	Description	Length (in)
J190	Pliers, Wire Twister 6"	8-3/8
J191	Pliers, Wire Twister 9"	10-3/8
J193	Pliers, Wire Twister Deep Reach 18-1/8"	18-1/8

## WIRE STRIPPER - CRIMPER

- › Strips 10-22 AWG (American Wire Gauge).
- › Box style crimp.
- › Crimps insulated and non-insulated terminals for 10-22 AWG.
- › Crimps non-insulated 7 mm and 8 mm auto ignition wire.
- › Cuts screw/bolt sizes 4-40, 5-40, 6-32, 8-32, 10-32, 10-24.
- › Anvil type wire cutter for cutting copper wire.
- › Air-pocket cushion grips for comfort.

Product #	Overall Length (in) (L)	Weight (lbs)
<b>J299</b>	8-1/2	0.45

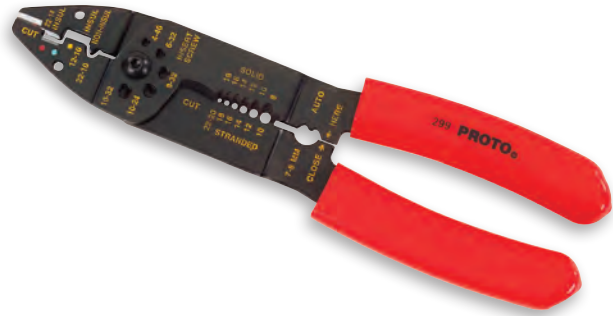

## WIRE STRIPPER - CUTTER

- › Strips wire sizes 10, 12, 14, 16, 18, and 20 AWG (American Wire Gauge).
- › Wire cutter for copper wire.
- › Plier nose for pulling and looping wire.
- › Spring return and convenient handle lock.
- › Plastisol grips for added comfort.

Product #	Overall Length (in) (L)	Weight (lbs)
<b>J297</b>	6-1/16	0.21



## WIRE STRIPPER

- › Strips wire sizes 22, 24, 26, 28, and 30 AWG (American Wire Gauge).
- › Wire cutter.
- › Plier nose for pulling and looping wire.
- › Automatic spring return.
- › Plastisol grips for added comfort.

Product #	Overall Length (in) (L)	Weight (lbs)
<b>J296</b>	6-1/16	0.21



## CABLE CUTTER

- › Cuts up to 3/0 fine stranded copper battery cable (not for use on steel cable).
- › Precision ground blades minimize deflection.
- › Positive fastener maintains pressure on matching cutting surfaces.
- › Plastisol grips for added comfort.

Product #	Overall Length (in) (L)	Weight (lbs)
<b>J288</b>	7-1/2	0.56





## WIRE STRIPPERS - PLIERS

- › Strips 10-22 AWG (American Wire Gauge).
- › Crimps insulated and non-insulated terminals for 10-22 AWG wire.
- › Crimps non-insulated 7mm and 8mm auto ignition wire.
- › Cuts screw/bolt sizes 4-40, 5-40, 6-32, 8-32, 10-32, 10-24 and copper wire.
- › Extended length curved cutter to handle heavier wire with less force.
- › Plier nose designed to grip, bend, and pull wire.
- › Plastisol grips for added comfort.

Product #	Overall Length (in) (L)	Weight (lbs)
<b>J298</b>	8-1/4	0.05



## LOCK RING "HORSESHOE" WASHER PLIERS

- › For spreading both soft iron "horseshoe" lock washers used on brakes and tempered steel lock rings used on gear and bearing shafts.
- › Plastisol grips for added comfort.

Product #	Overall Length (in) (L)	Weight (lbs)
<b>J250G</b>	7-13/16	0.49



## LOCK RING PLIERS - PARALLEL JAW

- › For removal of lock snap rings used on bearing shafts.
- › Compound leverage simplifies removal.
- › Jaw tips are indented to hold ring ends and prevent breakage.
- › Jaws spread 1-1/4".
- › Plastisol grips for added comfort.

Product #	Overall Length (in) (L)	Weight (lbs)
<b>J251G</b>	10-9/16	0.68



## 12 PIECE CONVERTIBLE RETAINING RING PLIERS SET

Product #: **J360B**

- › Convenient blow-molded carrying case includes storage for spare rings.
- › Ring range: External (Shaft) 1/4" - 3-11/32"; Internal (Bore) 3/8" - 3".
- › Weight (lbs): 4.82



Contents	Tip Size	Tip Angle	Length (in)	Shaft Diameter (in) (External)	Bore Diameter (in) (Internal)	Weight (lbs)
J399	.038	0°	5-7/8	1/4 - 43/64	3/8 - 9/16	0.15
J370	.038	45°	5-3/4	1/4 - 3/64	3/8 - 9/16	0.16
J371	.038	90°	5-11/16	1/2 - 25/32	3/8 - 9/16	0.16
J372	.047	0°	5-7/8	11/16 - 7/8	5/8 - 1	0.16
J373	.047	45°	5-3/4	11/16 - 7/8	5/8 - 1	0.15
J374	.047	90°	5-11/16	13/16 - 1	5/8 - 1	0.16
J385	.070	0°	7-1/2	15/16 - 1-7/16	1-1/16 - 13/4	0.29
J375	.070	45°	7-3/8	1 - 1-7/16	1-1/16 - 13/4	0.32
J376	.070	90°	7-1/8	1 - 1/16, 2	1-7/16 - 2	0.31
J377	.090	0°	9-1/4	1-1/2 - 3-1/2	1-13/16 - 3	0.54
J378	.090	45°	9	1-1/2 - 3-1/2	1-13/16 - 3	0.55
J379	.090	90°	8-5/8	1-1/2 - 1-3/4	1-13/16 - 3	0.56



## 6 PIECE CONVERTIBLE RETAINING RING PLIERS SET

Product #: **J360A**

- › Convenient blow-molded carrying case includes storage for space rings.
- › Ring range: External (Shaft) 1/4"-3-11/32"; Internal (Bore) 3/8" - 3".
- › Weight (lbs): 2.10



Contents	Tip Size	Tip Angle	Length (in)	Shaft Diameter (External)	Bore Diameter (Internal)	Weight (lbs)
J399	.038	0°	5-7/8	1/4 - 43/64	3/8 - 9/16	0.15
J371	.038	90°	5-11/16	1/2 - 25/32	3/8 - 9/16	0.16
J372	.047	0°	5-7/8	11/16 - 7/8	5/8 - 1	0.16
J374	.047	90°	5-11/16	13/16 - 1	5/8 - 1	0.16
J385	.070	0°	7-1/2	15/16 - 1-7/16	1-1/16 - 13/4	0.29
J376	.070	90°	7-1/8	1 - 1/16, 2	1-7/16 - 2	0.31

## 18 PIECE LARGE PLIERS SET WITH REPLACEABLE TIPS

Product #: **J361**

- › Includes one internal and one external plier.
- › Convenient blow-molded carrying case includes storage for spare rings.
- › Custom grip handles for added comfort.
- › Contains 16 interchangeable tips listed below. (Replacements available).
- › Covers ring range:
  - › External 1-1/2" - 3-3/4"
  - › Internal 2-7/16" - 4"
- › Spring-loaded ratchet mechanism minimizes operator fatigue by allowing ring to be compressed or expanded through gradual moves and locks at desired size. Heavy and large rings are safely and easily controlled.
- › Pliers overall length 9-1/2".
- › Weight (lbs): 2.50

Tip Size	Tip Angle
.108	0°
.108	15°
.108	45°
.108	90°
.120	0°
.120	15°
.120	45°
.120	90°



## REPLACEMENT TIPS FOR J361

- › 8 Tips
- › 2 each of .108 Tips in 0°, 15°, 45°, 90°.

Product #	Weight (lbs)
J362	0.22

## REPLACEMENT TIPS FOR J361

- › 8 Tips
- › 2 each of .120 Tips in 0°, 15°, 45°, 90°.

Product #	Weight (lbs)
J363	0.23

## 4 PIECE CONVERTIBLE RETAINING RING PLIERS SET

Product #: **J360C**

- › Design permits quick change-over to work internal or external rings.
- › Pliers have no screws to tighten.
- › Pliers have a return spring designed to reduce fatigue and facilitate operation.
- › Pliers have air cushioned grips which spreads loads across the hand increasing comfort.
- › Ring range: External (Shaft) 1/4" - 2"; Internal (Bore) 3/8" - 2".
- › Weight (lbs): 1.26



Contents	Tip Size	Tip Angle	Length (in)	Weight (lbs)
J399L	.038	18°	6	0.19
J371L	.038	90°	6	0.19
J385L	.070	18°	7-1/4	0.33
J376L	.070	90°	7-1/4	0.33

## 18 PIECE SMALL PLIERS SET WITH REPLACEABLE TIPS

Product #: **J380**

- › Includes one internal and one external plier.
- › Covers ring range: External 1/4"-2", Internal 3/8"-2".
- › Contains 16 interchangeable tips (4 of each listed below) (Replacements available).
- › Pliers overall length 6-1/4".
- › Weight: 0.64 lbs

Tip Size	Tip Angle
.038	90°
.047	45°
.047	0°
.070	0°



## REPLACEMENT TIPS FOR J380

- › 16 Tips.
- › 4 each of: .038 90°, .047 45°, .047 0°, .070 0°.
- › Plastic storage case.

Product #	Weight (lbs)
<b>J380T</b>	0.05

## RETAINING RING PLIERS - CONVERTIBLE

- › Converts from internal to external or vice versa, when pivot screw is moved to adjacent tapped hole.
- › Use with either External or Internal Retaining Rings.
- › Fixed tips are precision formed and induction hardened for accurate fit and long wear.
- › Use the largest diameter tip that will fit the retaining ring being removed or installed.



Product #	Tip Size	Tip Angle	Length (in)	Bore Diameter (in) (Internal)	Weight (lbs)
<b>J399</b>	.038	0°	5-7/8	3/8 - 9/16	0.15
<b>J370</b>	.038	45°	5-3/4	3/8 - 9/16	0.16
<b>J371</b>	.038	90°	5-11/16	3/8 - 9/16	0.16
<b>J372</b>	.047	0°	5-7/8	5/8 - 1	0.16
<b>J373</b>	.047	45°	5-3/4	5/8 - 1	0.15
<b>J374</b>	.047	90°	5-11/16	5/8 - 1	0.16
<b>J385</b>	.070	0°	7-1/2	1-1/16 - 13/4	0.29
<b>J375</b>	.070	45°	7-3/8	1-1/16 - 13/4	0.32
<b>J376</b>	.070	90°	7-1/8	1-7/16 - 2	0.31
<b>J377</b>	.090	0°	9-1/4	1-13/16 - 3	0.54
<b>J378</b>	.090	45°	9	1-13/16 - 3	0.55
<b>J379</b>	.090	90°	8-5/8	1-13/16 - 3	0.56
<b>J399L</b>	.038	18°	6	3/8 - 9/16	0.19
<b>J371L</b>	.038	90°	6	3/8 - 9/16	0.19
<b>J385L</b>	.070	18°	7-1/4	1-1/16 - 1-3/4	0.33
<b>J376L</b>	.070	90°	7-1/4	1-7/16 - 2	0.33

ASME B107.500

## RETAINING RING PLIERS - EXTERNAL

- › Used with External Retaining Rings.
- › Fixed tips are precision formed and induction hardened for accurate fit and long wear.



Product #	Tip Size	Tip Angle	Length (in)	Weight (lbs)
<b>J391</b>	.038	0°	6-1/8	0.15
<b>J397</b>	.038	90°	6-1/8	0.15
<b>J393</b>	.070	0°	6-7/8	0.22
<b>J395</b>	.115	0°	9-1/8	0.49

ASME B107.500

## RETAINING RING PLIERS - INTERNAL

- › Used with Internal Retaining Rings.
- › Fixed tips are precision formed and induction hardened for accurate fit and long wear.



Product #	Tip Size	Tip Angle	Length (in)	Bore Diameter (in) (Internal)	Weight (lbs)
<b>J388</b>	.023	0°	5-1/4	–	0.06
<b>J390</b>	.025	0°	5-3/8	1/4 - 5/16 1/4 - 5/16 1/4 - 5/16 5/8	0.14
<b>J389</b>	.038	0°	5-3/8	3/8 - 9/16	0.13
<b>J398</b>	.038	45°	5-3/8	3/8 - 9/16 3/8 - 9/16 3/4 - 1	0.13
<b>J392</b>	.070	0°	6-1/2	1-1/16 - 13/4 1-1/16 - 1-3/4 1-1/16 - 1-3/4 1-7/16 - 2	0.19
<b>J394</b>	.090	0°	9	1-13/16 - 3 1-13/16 - 3 1-13/16 - 3 2-1/16 - 3	0.47



ASME B107.500

## LARGE RETAINING RING PLIERS - INTERNAL/EXTERNAL

- › Spring-loaded ratchet mechanism minimizes operator fatigue by allowing the ring to be compressed or expanded through gradual moves and then locks at the desired size without continued pressure on the handles. Heavy and large rings are safely and easily controlled.
- › Replaceable tips in 0°, 45°, and 90° make it possible to remove and install rings in most applications. (Replacements available).



Product #	Tip Size	Tip Angle	Length (in)	Bore Diameter (in) (Internal)	Weight (lbs)	Shaft Diameter (in) (External)
<b>J364</b>	.120	0°	16-1/2	3-1/16 - 6	1.95	–
<b>J365</b>	.120	0°	16-1/2	–	1.98	3-1/2 - 6-1/2



ASME B107.500

### Tip Angles

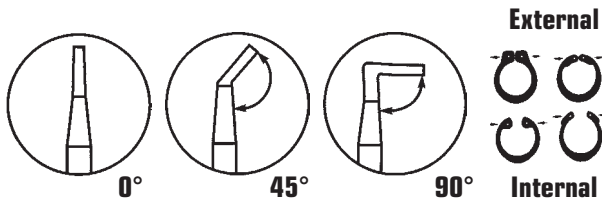

## REPLACEMENT TIPS FOR J364 AND J365

Product #	Overall Length (in) (L)	Weight (lbs)
<b>J364-T0</b>	0°	0.12
<b>J364-T45</b>	45°	0.12
<b>J364-T90</b>	90°	0.12



## 6 PIECE FACOM® 1000V VE PLIER/SCREWDRIVER SET



Product #: **FW-184.J5VE**

- › Designed for working on live components up to 1000V AC and 1500V DC.

Contents	Description
FA-185.20VE	Pliers, Halfround 1000V VE 7-7/8"
FA-187.18VE	Pliers, Combo 1000V VE 7-1/4"
FA-192.16VE	Pliers, Diagonal Cutting 1000V VE 6-1/4"
FW-ADY.1X100VE	Screwdriver, 1000V Pozidriv®
FW-AY.4X100VE	Screwdriver, 1000V 4 mm Slot 7-7/8"
FW-AY.5.5X125V	Screwdriver, 1000V 5.5 mm Slot 8-7/8"



## FACOM® 3 PIECE VE PLIERS SET



Product #: **FW-MOD.VE**

- › 1000V insulated grips designed for electrical safety when working on or near live components.
- › Handles designed to resist workshop chemicals (Skydrol®, chlorothene, acetone, petrol).

Contents	Description
FA-180.VE	Pliers, Multigrip 1000V VE 10"
FA-194.17VE	Pliers, Wire Stripper 1000V VE 6-1/2"
FA-391.16VE	Pliers, Diagonal Cutting 1000V VE 6-1/2"



## FACOM® INSULATED VE MUTIGRIP PLIERS



- › 1000V insulated grips designed for electrical safety when working on or near live components.

Product #	Overall Size (in)	Overall Length (in) (L)	Jaw Length (in) (A)	Jaw Width (in) (B)	Weight (lbs)
<b>FA-180.VE</b>	10	10	1-3/16	7/8	0.78



## FACOM® INSULATED VE HALF ROUND PLIERS



- › 1000V insulated grips designed for electrical safety when working on or near live components.
- › Side cutter for steel wire up to 14AWG.
- › Serrated jaws with central area for handling rods.

Product #	Size (in)	Overall Length (in) (L)	Jaw Length (in) (A)	Jaw Width (in) (B)	Weight (lbs)
<b>FA-185.20VE</b>	7-7/8	7-7/8	2-15/16	11/32	0.45
<b>FA-193.16VE</b>	6-1/2	6-7/8	1-13/16	11/32	0.41





## FACOM® INSULATED VE COMBINATION PLIERS



- ▶ 1000V insulated grips designed for electrical safety when working on or near live components.
- ▶ High-frequency hardened cutting edges for power and durability.
- ▶ Nose profile combines strength and maneuverability.



Product #	Size (in)	Overall Length (in) (L)	Jaw Length (in) (A)	Jaw Width (in) (B)	Weight (lbs)
FA-187.16VE	6-1/2	6-1/2	1-11/32	3/8	0.43
FA-187.18VE	7-1/4	7-9/32	1-13/32	13/32	0.53

## FACOM® INSULATED VE FLAT NOSE PLIERS



- ▶ 1000V insulated grips designed for electrical safety when working on or near live components.
- ▶ Serrated jaws for firm grip.
- ▶ Nose designed for confined spaces.



Product #	Size (in)	Overall Length (in) (L)	Jaw Length (in) (A)	Jaw Width (in) (B)	Weight (lbs)
FA-188.16VE	6-1/2	6-11/16	1-13/16	11/32	0.38
FA-188.20VE	7-7/8	8-1/16	2-15/16	11/32	0.42

## FACOM® INSULATED VE ROUND NOSE PLIERS



- ▶ 1000V insulated grips designed for electrical safety when working on or near live components.
- ▶ For shaping loops, bends or rings.
- ▶ Serrated jaws.



Product #	Size (in)	Overall Length (in) (L)	Jaw Length (in) (A)	Jaw Width (in) (B)	Weight (lbs)
FA-189.17VE	6-1/2	6-7/8	1-13/16	11/32	0.37

## FACOM® INSULATED WIRE STRIPPER PLIERS



- ▶ 1000V insulated grips designed for electrical safety when working on or near live components.
- ▶ Jaws angled at 40°.
- ▶ Cuts single and multi-cone wire up to 14 AWG.
- ▶ Serrated jaws with central area for handling rods.



Product #	Size (in)	Overall Length (in) (L)	Jaw Length (in) (A)	Jaw Width (in) (B)	Weight (lbs)
FA-194.17VE	6-1/2	7-11/16	1	5/8	0.38

## FACOM® INSULATED VE BENT NOSE PLIERS



- › 1000V insulated grips designed for electrical safety when working on or near live components.
- › Jaws angled at 40°.
- › Cuts single and multi-cone wire up to 14 AWG.
- › Serrated jaws with central area for handling rods.



Product #	Size (in)	Overall Length (in) (L)	Jaw Length (in) (A)	Jaw Width (in) (B)	Weight (lbs)
<b>FA-195.16VE</b>	6-3/8	6-7/8	1-5/8	11/32	0.39
<b>FA-195.20VE</b>	7-7/8	7-15/32	2-3/4	11/32	0.43

## FACOM® INSULATED VE END CUTTER PLIERS



- › 1000V insulated grips designed for electrical safety when working on or near live components.
- › High-frequency hardened cutting edges ensure durable cut quality for hard wire up to 12 AWG.
- › Offset pivot to help reduce manual cutting efforts required with a center pivot point.



Product #	Size (in)	Overall Length (in) (L)	Jaw Length (in) (A)	Jaw Width (in) (B)	Weight (lbs)
<b>FA-190.16VE</b>	6-1/2	6-1/2	1/4	7/16	0.51

## FACOM® INSULATED VE DIAGONAL PLIERS



- › 1000V insulated grips designed for electrical safety when working on or near live components.
- › High-frequency hardened cutting edges ensure durable cut quality for hard wire up to 200kg/mm.
- › Offset pivot for reduced cutting effort.



Product #	Size (in)	Overall Length (in) (L)	Jaw Length (in) (A)	Jaw Width (in) (B)	Weight (lbs)
<b>FA-192.14VE</b>	5-3/4	5-23/32	5/8	3/8	0.36
<b>FA-192.16VE</b>	6-1/4	6-7/8	23/32	13/32	0.46
<b>FA-192.18VE</b>	7-1/8	7-15/32	25/32	7/16	0.57

## FACOM® INSULATED VE DIAGONAL CUTTERS



- › 1000V insulated grips designed for electrical safety when working on or near live components.
- › Edges designed for clean cut in copper wire.
- › High-frequency hardened cutting edges for durable cut accuracy.
- › Snipe nose for maneuverability in control cabinets or cutting cable loom ties.

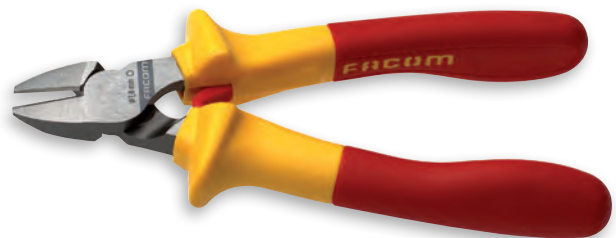

Product #	Size (in)	Overall Length (in) (L)	Jaw Length (in) (A)	Jaw Width (in) (B)	Weight (lbs)
<b>FA-391.16VE</b>	6-1/2	6-11/16	3/4	13/32	0.46



## FACOM® INSULATED VSE MULTIGRIP PLIERS



- › 1000V insulated grips designed for electrical safety when working on or near live components.
- › 2 color warning handle insulation - color changes from orange to yellow if insulation integrity compromised.



Product #	Size (in)	Overall Length (in) (L)	Jaw Length (in) (A)	Jaw Width (in) (B)	Weight (lbs)
<b>FA-180.VSE</b>	10	10-1/32	1-9/16	1-3/8	0.81

## FACOM® INSULATED VSE HALF ROUND PLIERS



- › 2 Color warning handle insulation - color changes from orange to yellow if insulation integrity compromised.
- › Insulated to 1000V AC or 1500 DC.
- › Integrated wire-cutter.
- › Burnished nose.



Product #	Size (in)	Overall Length (in) (L)	Jaw Length (in) (A)	Jaw Width (in) (B)	Weight (lbs)
<b>FA-185.20AVSE</b>	7-7/8	8-9/32	2-23/32	1-3/8	0.53
<b>FA-193.16AVSE</b>	6-1/2	6-7/8	1-31/32	1-1/4	0.37

## FACOM® INSULATED VSE COMBINATION PLIERS



- › 2 color warning handle insulation - color changes from orange to yellow if insulation integrity compromised.
- › Insulated to 1000V AC or 1500 DC.
- › Hardened throughout for overall strength.
- › Cutting edges locally heat-treated to exceed 60 HRC hardness.
- › Burnished nose.
- › Serrated Jaw.



Product #	Size (in)	Overall Length (in) (L)	Jaw Length (in) (A)	Jaw Width (in) (B)	Weight (lbs)
<b>FA-187.16AVSE</b>	6-1/2	6-1/2	1-11/32	1-3/8	0.44
<b>FA-187.18AVSE</b>	7-1/4	7-3/32	1-3/8	1-3/8	0.54
<b>FA-187.20AVSE</b>	8	7-9/32	1-43/64	1-3/8	0.69

## FACOM® INSULATED VSE FLAT NOSE PLIERS



- › 2 color warning handle insulation - color changes from orange to yellow if insulation integrity compromised.
- › Insulated to 1000V AC or 1500 DC.
- › Serrated jaws for firm grip.
- › Burnished nose.



Product #	Size (in)	Overall Length (in) (L)	Jaw Length (in) (A)	Jaw Width (in) (B)	Weight (lbs)
<b>FA-188.16AVSE</b>	6-1/2	6-11/16	1-31/32	1-15/32	0.37



## FACOM® INSULATED VSE ROUND NOSE PLIERS



- › 2 color warning handle insulation - color changes from orange to yellow if insulation integrity compromised.
- › Insulated to 1000V AC or 1500 DC.
- › Long nipe nose, serrated for shaping bends or terminals on all types of wire.
- › Burnished nose.



Product #	Size (in)	Overall Length (in) (L)	Jaw Length (in) (A)	Jaw Width (in) (B)	Weight (lbs)
FA-189.17AVSE	6-1/2	6-7/8	1-25/32	1-5/16	0.36

## FACOM® INSULATED VSE WIRE STRIPPER



- › 2 color warning handle insulation - color changes from orange to yellow if insulation integrity compromised.
- › Strips any wire in all common electrical systems, up to 10 AWG.
- › Burnished nose.
- › Knob for presetting the cutting depth.



Product #	Size (in)	Overall Length (in) (L)	Jaw Length (in) (A)	Jaw Width (in) (B)	Weight (lbs)
FA-194.17AVSE	6-1/2	6-7/8	7/8	5/16	0.45

## FACOM® INSULATED VSE BENT NOSE PLIERS



- › 1000V insulated grips designed for electrical safety when working on or near live components.
- › Integral wire-cutter.
- › 2 color warning handle insulation - color changes from orange to yellow if insulation integrity compromised.
- › Burnished nose.



Product #	Size (in)	Overall Length (in) (L)	Jaw Length (in) (A)	Jaw Width (in) (B)	Weight (lbs)
FA-195.20AVSE	7-7/8	7-15/32	2-17/32	1-1/4	0.43

## FACOM® INSULATED VSE CABLE CUTTERS



- › 2 color warning handle insulation - color changes from orange to yellow if insulation integrity compromised.
- › High performance compact tool.
- › Forged safety stops.
- › Burnished nose.



Product #	Size (in)	Overall Length (in) (L)	Jaw Length (in) (A)	Jaw Width (in) (B)	Weight (lbs)
FA-412.10AVSE	7-1/2	7-7/8	3-1/3	1-3/8	0.91
FA-412.14AVSE	9	9	1-3/16	1-3/8	1.12
FA-412.150AVSE	17-3/4	18-1/2	2-23/64	1-3/4	4.71



## FACOM® INSULATED VSE RATCHETING CABLE CUTTERS



- › One-hand operation.
- › No cable core distortion.
- › Forged and hardened steel blade.
- › 2 color warning handle insulation - color changes from orange to yellow if insulation integrity compromised.



Product #	Size (in)	Overall Length (in) (L)	Jaw Width (in) (B)	Weight (lbs)
FA-414.45AVSE	1-3/4	12	5-5/16	2.19
FA-414.52AVSE	2	13-3/16	5-1/2	2.26

## FACOM® INSULATED VSE END CUTTER PLIERS



- › 2 color warning handle insulation - color changes from orange to yellow if insulation integrity compromised.
- › Cutting edges heat-treated to exceed 60 HRC.
- › Burnished nose.



Product #	Size (in)	Overall Length (in) (L)	Jaw Length (in) (A)	Jaw Width (in) (B)	Weight (lbs)
FA-190.16AVSE	6-1/2	6-11/16	1/4	1-3/8	0.56

## FACOM® INSULATED VSE DIAGONAL PLIERS



- › 2 color warning handle insulation - color changes from orange to yellow if insulation integrity compromised.
- › Cutting edges heat-treated to exceed 60 HRC.
- › Burnished nose.



Product #	Size (in)	Overall Length (in) (L)	Jaw Length (in) (A)	Jaw Width (in) (B)	Weight (lbs)
FA-192.14AVSE	5-3/4	6-3/32	5/8	1-3/16	0.48
FA-192.16AVSE	6-1/2	6-1/2	23/32	13/32	0.54
FA-192.18AVSE	7-1/4	7-9/32	25/32	7/16	0.60

## FACOM® INSULATED VSE DIAGONAL CUTTERS



- › 2 color warning handle insulation - color changes from orange to yellow if insulation integrity compromised.
- › Inset joint.
- › Burnished nose.



Product #	Size (in)	Overall Length (in) (L)	Jaw Length (in) (A)	Jaw Width (in) (B)	Weight (lbs)
FA-391.16AVSE	6-1/2	6-5/16	3/4	13/32	0.47



## C-CLAMPS - HEAVY SERVICE STANDARD SCREW

- › Designed for heavy service applications where the strength of the extra heavy service C-clamp is not required.
- › Clamps have a high-strength steel frame with a hardened forcing screw.
- › Forcing screws are fitted with impact resistant pads.



Product #	Opening Range (in) (C)	Throat Depth (in) (T)	Thread Diameter (in) (D)	Minimum Test Load (lbs)	Weight (lbs)
<b>J1026S</b>	0 - 2	1-3/8	1/2	7500	1.30
<b>J1036S</b>	0 - 3	1-3/4	5/8	8750	2.60
<b>J1046S</b>	0 - 4-1/8	2	3/4	10000	4.10
<b>J1066S</b>	2 - 6	2-1/4	3/4	11250	5.90
<b>J1086S</b>	4 - 8	2-1/4	3/4	12500	6.90
<b>J1106S</b>	6 - 10-1/4	2-3/8	3/4	13750	8.00
<b>J1126S</b>	8 - 12	2-5/8	7/8	15000	11.6
<b>J1156S</b>	10 - 15	2-5/8	7/8	16250	15.0
<b>J1186S</b>	12 - 18	2-7/8	7/8	17500	18.2



## C-CLAMPS - STANDARD SERVICE DEEP THROAT FULL LENGTH SCREW

- › Standard service, deep throat style is the most versatile and popular.
- › Hot forged for strength and hard use.
- › Forcing screw has heavy rolled Acme thread allowing the screw to turn easily under pressure and is less susceptible to damage.
- › Forcing screw has a sliding T-handle and an impact resistant pad.



Product #	Opening Range (in) (C)	Throat Depth (in) (T)	Thread Diameter (in) (D)	Minimum Test Load (lbs)	Weight (lbs)
<b>J402</b>	0 - 2	2	1/2	3500	1.30
<b>J403</b>	0 - 3	2-3/8	1/2	3500	2.00
<b>J404</b>	0 - 4	2-3/4	3/4	6500	3.50
<b>J406</b>	0 - 6	3-5/8	3/4	6600	5.00
<b>J408</b>	0 - 8	4-1/2	3/4	6900	7.00
<b>J410</b>	0 - 10	5-3/8	3/4	8000	10.5
<b>J412</b>	0 - 12	5-3/4	7/8	9500	15.5

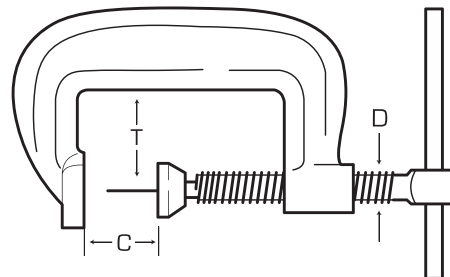



## C-CLAMPS - STANDARD SERVICE DEEP THROAT SPATTER RESISTANT FULL LENGTH SCREW

- › Forcing screw and pad are plated with copper to resist welding spatter.
- › Hot forged for strength and hard use.
- › Forcing screw has heavy rolled Acme thread allowing the screw to turn easily under pressure and is less susceptible to damage.
- › Forcing screw has a sliding T-handle and an impact resistant pad.



Product #	Opening Range (in) (C)	Throat Depth (in) (T)	Thread Diameter (in) (D)	Minimum Test Load (lbs)	Weight (lbs)
<b>J402S</b>	0-2	2	1/2	3300	1.30
<b>J403S</b>	0-3	2-3/8	1/2	3500	2.00
<b>J404S</b>	0-4	2-3/4	3/4	4100	3.50
<b>J406S</b>	0-6	3-5/8	3/4	5400	5.00
<b>J408S</b>	0-8	4-1/2	3/4	5900	7.00
<b>J410S</b>	0-10	5-3/8	3/4	6200	10.5
<b>J412S</b>	0-12	5-3/4	7/8	9300	15.5



## C-CLAMPS - STANDARD SERVICE EXTRA DEEP THROAT FULL LENGTH SCREW

- › Up to 32% more throat depth than standard deep throat clamps.
- › Hot forged for strength and hard use.
- › Forcing screw has heavy rolled Acme thread.
- › Full length forcing screw.



Product #	Opening Range (in) (C)	Throat Depth (in) (T)	Thread Diameter (in) (D)	Minimum Test Load (lbs)	Weight (lbs)
<b>J424</b>	0 - 4	3-5/8	3/4	4100	4.80
<b>J426</b>	0 - 6	4-3/4	3/4	5400	7.00
<b>J428</b>	0 - 8	5-5/8	3/4	5900	9.80



## C-CLAMPS - STANDARD SERVICE EXTRA DEEP THROAT SPATTER RESISTANT FULL LENGTH SCREW

- › Forcing screw and pad are plated with copper to resist welding spatter.
- › Up to 32% more throat depth than standard deep throat clamps.
- › Hot forged for strength and hard use.
- › Forcing screw has heavy rolled Acme thread.
- › Full length forcing screw.



Product #	Opening Range (in) (C)	Throat Depth (in) (T)	Thread Diameter (in) (D)	Minimum Test Load (lbs)	Weight (lbs)
<b>J424S</b>	0 - 4	3-5/8	3/4	4100	4.80
<b>J426S</b>	0 - 6	4-3/4	3/4	5400	7.00
<b>J428S</b>	0 - 8	5-5/8	3/4	5900	9.80

## C-CLAMPS - EXTRA HEAVY SERVICE STANDARD SCREW

- › Strongest C-clamp design.
- › Heavy-duty threaded hub provides maximum screw support.
- › Forcing screws have a square head to be turned with a wrench.
- › Forcing screws have a hardened tip.



Product #	Opening Range (in) (C)	Throat Depth (in) (T)	Thread Diameter (in) (D)	Minimum Test Load (lbs)	Weight (lbs)
<b>J0-HD</b>	0 - 13/16	11/16	3/8	2800	0.30
<b>J1-HD</b>	0 - 7/16	1-3/32	7/16	5600	1.00
<b>J11/2-HD</b>	0 - 1-3/4	1-7/16	5/8	8750	1.90

## C-CLAMPS - EXTRA HEAVY SERVICE FULL LENGTH SCREW

- › Full length forcing screws provide greater versatility with the minimum capacity always being 0.
- › Strongest C-clamp design.
- › Heavy-duty threaded hub provides maximum screw support.
- › Forcing screws have a square head to be turned with a wrench.
- › Forcing screws have a hardened tip.



Product #	Opening Range (in) (C)	Throat Depth (in) (T)	Thread Diameter (in)	Minimum Test Load (lbs)	Weight (lbs)
<b>J2-HDL</b>	0 - 2-3/8	1-7/8	3/4	12500	4.50
<b>J3-HDL</b>	0 - 3-5/16	2-5/16	7/8	16250	7.10
<b>J4-HDL</b>	0 - 4-5/8	2-3/4	1	20000	11.0
<b>J5-HDL</b>	0 - 5-3/8	3-1/16	1	23800	14.9
<b>J6-HDL</b>	0 - 6-5/8	3-3/8	1-1/8	27500	19.3
<b>J8-HDL</b>	0 - 8-1/4	3-5/8	1-1/4	31250	27.5
<b>J10-HDL</b>	0 - 10-3/8	3-15/16	1-1/4	35000	40.1
<b>J12-HDL</b>	0 - 12-1/2	4-1/4	1-1/4	40000	47.8



## C-CLAMP FORCING SCREWS

Product #	Thread Diameter (in)	Weight (lbs)
J1P1-HD	11/25	0.10
J2P2-HD	3/4	0.53
J3P2-HD	7/8	0.99
J4P2-HD	1	1.69
J5P2-HD	1	1.94
J6P2-HD	1-1/8	2.67
J10P2-HD	1-1/4	4.58
J11/2P1-HD	5/8	0.30
J12P2-HD	1-1/4	5.12



## FORGED EYE BOLTS

- › Maximum load ratings for eye bolts are drastically reduced when loading at an angle.
- › Angular loads should be avoided whenever possible.
- › For angular loads of 15° or more, consult B18.15.
- › Certified mercury free.



Product #	Thread Size (in) (A)	Shank Length (in) (B)	Eye ID (in) (C)	OD (in) (D)	Overall Length (in) (E)	Center Eye to Shoulder (in) (F)	Rated Capacity (lbs)	Weight (lbs)
J94020	1/4 - 20	1.00	.69 - .81	1.19	2.22 - 2.53	.69 - .81	500	0.05
J94021	5/16 - 18	1.12	.81 - .94	1.44	2.66 - 2.97	.88 - 1.00	900	0.10
J94022	3/8 - 16	1.25	.94 - 1.06	1.69	3.09 - 3.47	1.06 - 1.09	1,300	0.16
J94023	7/16 - 14	1.38	1.00 - 1.12	1.81	3.41 - 3.78	1.19 - 1.31	1,800	0.24
J94024	1/2 - 13	1.50	1.12 - 1.25	2.12	3.81 - 4.19	1.31 - 1.44	2,400	0.35
J94025	9/16 - 12	1.75	1.31 - 1.44	2.56	4.56 - 4.94	1.59 - 1.72	3,200	0.47
J94026	5/8 - 11	1.75	1.31 - 1.44	2.56	4.56 - 4.94	1.59 - 1.72	4,000	1.00
J94027	3/4 - 10	2.00	1.44 - 1.56	2.81	5.0 - 5.50	1.72 - 1.91	5000	1.00
J94028	7/8 - 9	2.25	1.56 - 1.69	3.19	5.75 - 6.19	2.03 - 2.22	7,000	1.63
J94029	1 - 8	2.50	1.69 - 1.81	3.56	6.44 - 6.88	2.22 - 2.41	9,000	2.22
J94030	1-1/8 - 7	2.75	1.94 - 2.06	4.06	7.31 - 7.75	2.59 - 2.78	12,000	3.40
J94031	1-1/4 - 7	3.00	2.12 - 2.25	4.44	8.00 - 8.44	3.03 - 2.84	15,000	4.44
J94032	1-1/2 - 6	3.50	2.44 - 2.56	5.19	9.22 - 9.72	3.19 - 3.44	21,000	7.36
J94033	1-3/4 - 5	3.75	2.75 - 3.00	6.00	10.50 - 11.12	3.88 - 4.12	28,000	11.35
J94034	2 - 4-1/2	4.00	3.06 - 3.44	6.88	11.53 - 12.22	4.25 - 4.50	38,000	16.70



B18.15

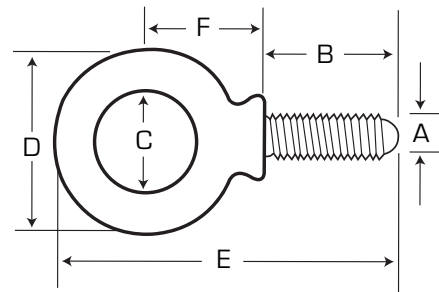
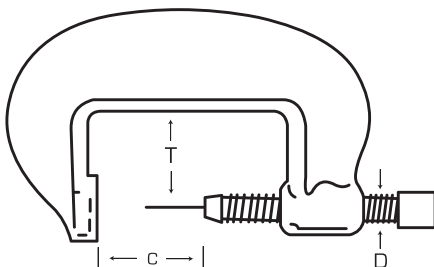

## AVIATION SNIPS

- › Available in straight, left, or right models.
- › Compound leverage multiplies handle pressure and increases control for intricate cutting.
- › Serrated blades for maximum grip of the material being cut.
- › Color coded vinyl grips.



Product #	Cuts	Handle Color	Blade Length (in)	Overall Length (in) (L)	Weight (lbs)
<b>J303L</b>	Left	Red	1-3/8	10	0.94
<b>J303R</b>	Right	Green	1-3/8	10	0.94
<b>J303S</b>	Straight	Yellow	1-3/8	10	0.94

ASME B107.500

## CIRCULAR CUTTING DUCKBILL SNIPS

- › Duckbill snips are designed for circle and odd shaped radius cutting.
- › Plastisol grips for added comfort.



Product #	Blade Length (in)	Overall Length (in) (L)	Weight (lbs)
<b>J307</b>	1-1/2	7	0.45
<b>J310</b>	2	10	0.95
<b>J312</b>	2-3/4	12-3/4	1.61

## HEAVY-DUTY SNIPS

- › Designed for making straight and moderately irregular cuts.
- › Plastisol grips for added comfort.
- › J334 cuts up to 18 gauge CR steel and 22 gauge SS.



Product #	Description	Blade Length (in)	Overall Length (in) (L)	Weight (lbs)
<b>J334</b>	Combination Snips	3-7/8	14	3.02
<b>J336</b>	Bulldog Tinner Snips	2-1/2	16	3.63

ASME B107.500

## AVIATION SNIPS - OFFSET

- › Available in left or right models.
- › Compound leverage multiplies handle pressure and increases control.
- › Offset handle keeps hands above working area for cutting ease and comfort.
- › Serrated blades for maximum grip of the material being cut.



Product #	Cuts	Handle Color	Blade Length (in)	Overall Length (in) (L)	Weight (lbs)
<b>J303LS</b>	Left	Red	1-1/4	10	1.00
<b>J303RS</b>	Right	Green	1-1/4	10	1.00



ASME B107.500

## STRAIGHT CUTTING SNIPS

- › Designed for all straight cutting including inside and outside corners.
- › Plastisol grips for added comfort.

Product #	Blade Length (in)	Overall Length (in) (L)	Weight (lbs)
<b>J317</b>	1-1/2	7	0.48
<b>J320</b>	2	10	0.93
<b>J322</b>	2-3/4	12-3/4	1.64



## MINIATURE SNIPS

- › Improved shearing action.
- › Increased length of cut from 1-1/8" to 2".
- › Increased jaw opening.
- › Serrated bottom blade to grip material.
- › Ergonomic handle design.
- › Cuts up to 26 gauge cold-roll sheet metal.
- › Copper wire up to 18 AWG.
- › Soft steel wire up to 22 AWG.



Product #	Blade Length (in)	Overall Length (in) (L)	Weight (lbs)
<b>J308</b>	1-1/8	6-1/2	0.325





## MULTI-PURPOSE TOOL - NEEDLE-NOSE

- › 15 functions including pliers with wire cutter, cross cut saw, taper grind blade, sheepfoot blade, can and bottle opener, ruler, and screwdriver bits provide versatility.
- › Locking handle securely positions and safely locks each blade or implement for safety.
- › Stainless steel construction for heavy-duty use and long life.
- › Nylon belt pouch for convenient storage.
- › Wide handle design for added comfort.



Product #	Overall Length (in)	Weight (lbs)
<b>J18576</b>	6	0.65



## MULTI-PURPOSE TOOL - BLUNT NOSE

- › 15 functions including pliers with wire cutter, cross cut saw, taper grind blade, sheepfoot blade, can and bottle opener, ruler, and screwdriver bits provide versatility.
- › Locking handle securely positions and safely locks each blade or implement for safety.
- › Stainless steel construction for heavy-duty use and long life.
- › Nylon belt pouch for convenient storage.
- › Wide handle design for added comfort.



Product #	Overall Length (in)	Weight (lbs)
<b>J18575</b>	5-5/8	0.56



## LOCKBACK KNIVES

- › 420 grade high carbon stainless steel blade.
- › Hardwood handle with heavy-duty lock springs.
- › Solid one piece brass bolster and liner provide additional strength.
- › Blade locks in open position to guard against accidental closing.
- › J18545 includes a leather sheath.



Product #	Blade Length (in)	Closed Position Length (in)	Open Position Length (in)	Weight (lbs)
<b>J18543</b>	2-1/4	3	5-1/4	0.16
<b>J18545</b>	3-3/4	4-7/8	8-3/4	0.57
<b>J18545B</b>	3-3/4	4-7/8	8-3/4	0.57



## COMMEMORATIVE LOCKBACK KNIFE

- › Commemorative sculpted brass handle.
- › Unique artwork features the Proto® logo on one side, a selection of Proto® tools on the reverse side.



Product #	Blade Length (in)	Closed Position Length (in)	Open Position Length (in)	Weight (lbs)
<b>J18510</b>	2	3	5-1/4	0.16



## FACOM® VSE SERIES INSULATED KNIFE



- › For working on live components up to 1000V AC and 1500V DC.
- › Thick, angled blade with flat tip.
- › Cushion handle.
- › Blade sheath.
- › Effective blade length 2".



Product #	Blade Length (in)	Overall Length (in)	Weight (lbs)
<b>FT-1820.AVSE</b>	2-3/8	7-1/2	0.19

## ELECTRICIAN'S KNIFE WITH STRIPPING BLADE

- › Spear blade.
- › Stripping blade.
- › Self-locking combination screwdriver, insulation cutter and wire scraper blade.



Product #	Blade Length (in)	Closed Position Length (in)	Open Position Length (in)	Weight (lbs)
<b>J18535</b>	3	3-3/4	7	0.32

## ELECTRICIAN'S KNIFE

- › Spear blade.
- › Self-locking combination screwdriver, insulation cutter and wire scraper blade.



Product #	Blade Length (in)	Closed Position Length (in)	Open Position Length (in)	Weight (lbs)
<b>J18500</b>	3	3-3/4	7	0.24

## PRUNING KNIFE

- › Curved blade for precision cutting and stripping.



Product #	Blade Length (in)	Closed Position Length (in)	Open Position Length (in)	Weight (lbs)
<b>J18505</b>	4	4-3/4	9	0.26

## FACOM® VSE SERIES INSULATED HACKSAW



- › Two blade positions.
- › Butterfly tension nut.
- › Supplied with bi-metal blade.
- › 12" blade replacement.



Product #	Blade Length (in)	Overall Length (in)	Weight (lbs)
<b>FT-602.AVSE</b>	12	18-1/2	1.30

